

Primary Control Point

AAGRS No. 0001A

City of Ann Arbor

NGS PID AA5165

Public Services Area • Project Management Unit

CONTROL STATION DATA SHEET

Approximate Location: Ann Arbor-Saline Road and I-94

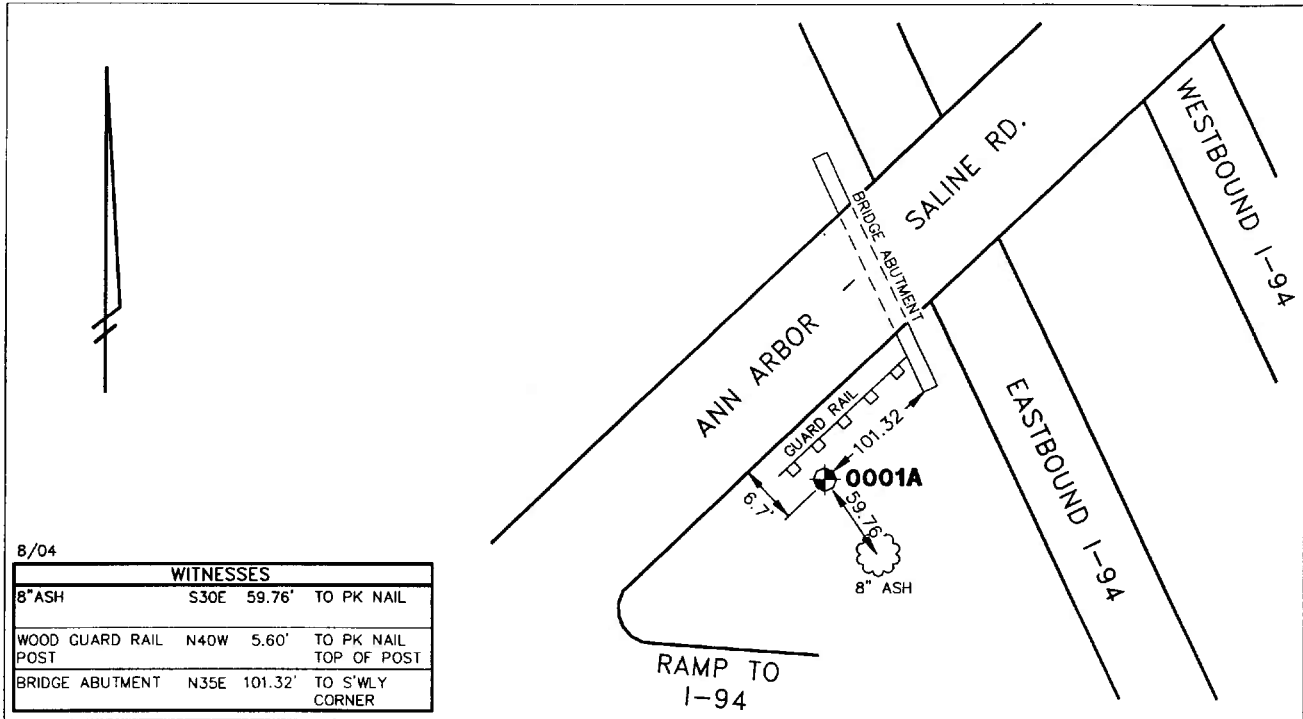

STATION 0001A IS LOCATED ON THE SOUTHEASTERLY SIDE OF ANN ARBOR-SALINE ROAD BETWEEN I-94 AND THE ENTRANCE RAMP TO EASTBOUND I-94 FROM ANN ARBOR-SALINE ROAD, SAID STATION BEING IN THE SOUTHEAST 1/4 OF SECTION 6, PITTSFIELD TOWNSHIP, MICHIGAN. THE STATION IS LOCATED 101.32' SOUTHWESTERLY OF THE SOUTHWEST CORNER OF THE WESTERLY CONCRETE BRIDGE ABUTMENT TO I-94, AND 6.7' SOUTHEAST OF THE SOUTHEAST EDGE OF ASPHALT ALONG ANN ARBOR-SALINE ROAD. SAID STATION IS A PRIMARY CONTROL STATION AND IS DESCRIBED AS A STAINLESS STEEL ROD WITHOUT SLEEVE AND IS ACCESSED BY A 5" LOGO CAP SET FLUSH WITH THE GROUND. THIS STATION WAS SET BY OTHERS AND IS PAIRED WITH STATION 0001B.

Horizontal		Vertical	
Latitude (dms)	N 42 14 41.97607	Accuracy	2nd Order Class II
Longitude (dms)	W 83 45 49.82477	Datum	NAVD 88
State Plane Zone	2113 MI South	Elevation in meters	280.172
Scale	0.99996882	Elevation in International feet	919.20
Geoid Height in meters	-34.02		
Convergence (dms)	0 24 36.9		
Accuracy	1st Order		
Datum	NAD 83		No. 0001A
Easting (X) in meters	4049750.619		Sector: SW
Northing (Y) in meters	82930.795		
Easting (X) in International feet	13286583.396		
Northing (Y) in International feet	272082.661	Grid Azimuth to Control Station 0001B	42°15'12"