

City of Ann Arbor
Public Services Area • Project Management Unit
CONTROL STATION DATA SHEET

NGS PID

Approximate Location: Hubbard Rd. and Dean Rd.

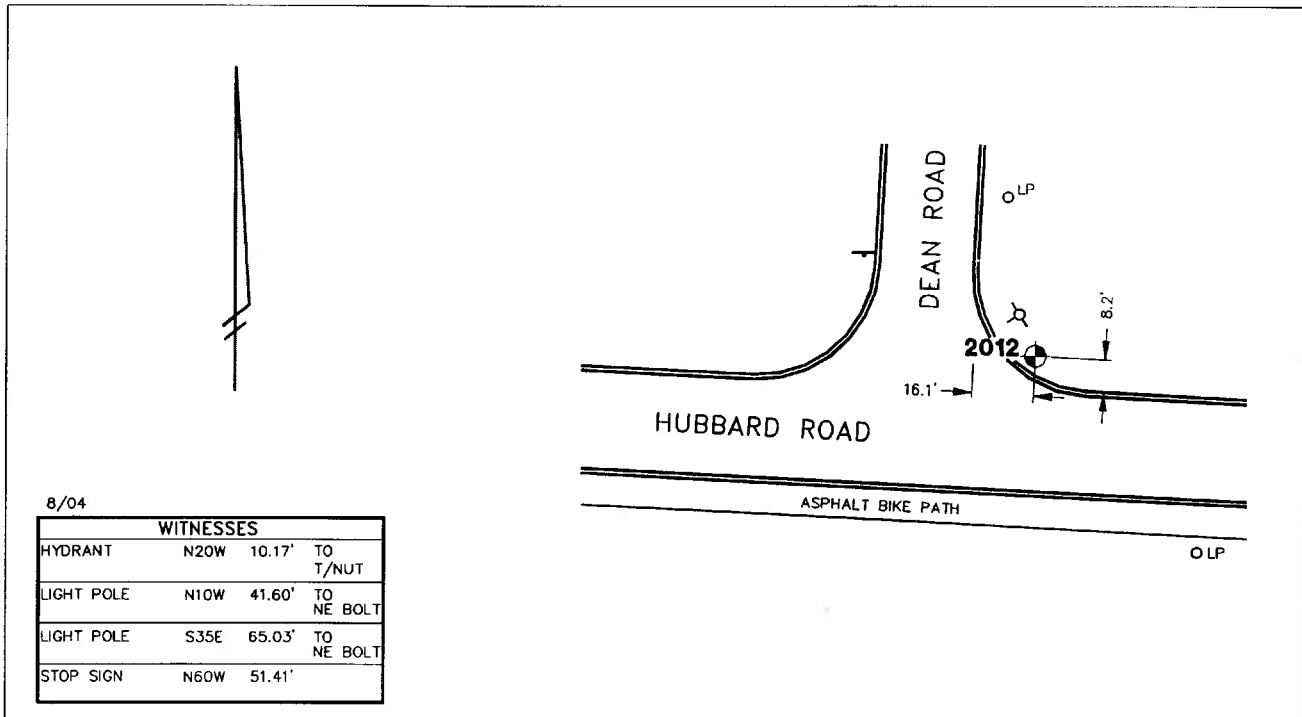

STATION 2012 IS LOCATED AT THE NORTHEAST CORNER OF HUBBARD ROAD AND DEAN ROAD, SAID STATION BEING IN THE SOUTHWEST 1/4 OF SECTION 23, ANN ARBOR TOWNSHIP IN THE CITY OF ANN ARBOR, MICHIGAN. THE STATION IS LOCATED 8.2' NORTH OF THE NORTH BACK OF CURB (EXTENDED) ALONG THE NORTH SIDE OF HUBBARD ROAD AND 16.1' EAST OF THE EAST BACK OF CURB (EXTENDED) ALONG THE EAST SIDE OF DEAN ROAD. SAID STATION IS A VERTICAL CONTROL STATION AND IS DESCRIBED AS THE 1993 EDITION OF THE CITY OF ANN ARBOR BRASS DISC, SET IN CONCRETE PER DETAIL II AND IS FLUSH WITH THE GROUND. THE STATION WAS SET BY THE CITY OF ANN ARBOR IN 2001.

Benchmark

Vertical

Accuracy	Local Control
Datum	NAVD 88
Elevation in meters	269.024
Elevation in International feet	882.62

No. 2012
Sector: NE