

Public Services Area • Project Management Unit
CONTROL STATION DATA SHEET

Approximate Location: US-23, North of Washtenaw Ave.

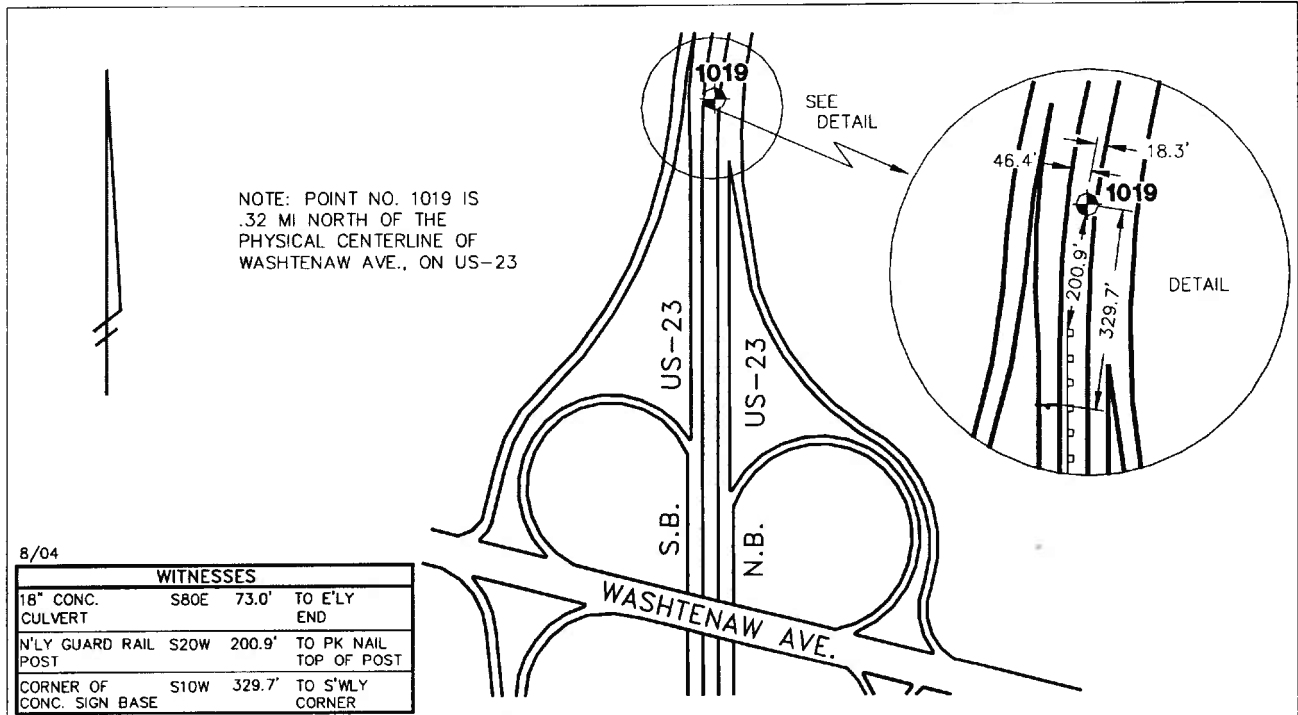

STATION 1019 IS LOCATED ON US-23, APPROXIMATELY 0.32 mi NORTH OF WASHTENAW AVE., SAID STATION BEING IN THE SOUTHEAST 1/4 OF SECTION 35, ANN ARBOR TOWNSHIP, MICHIGAN. THE STATION IS LOCATED IN THE GRASS TRAFFIC ISLAND BETWEEN NORTHBOUND AND SOUTHBOUND US-23, 0.32 MI NORTH OF THE PHYSICAL CENTERLINE OF WASHTENAW AVE, ALSO DESCRIBED AS BEING 18.3' WEST OF THE WESTERLY EDGE OF ASPHALT SHOULDER TO NORTHBOUND US-23 AND 329.7' NORTHEAST OF THE SOUTHEAST CORNER OF THE CONCRETE BASE TO AN OVERHEAD HIGHWAY SIGN FOR SOUTHBOUND US-23. SAID SECTION IS A VERTICAL CONTROL STATION AND IS DESCRIBED AS A CHISELED SQUARE ON THE TOP AND WEST END OF AN 450mm CONCRETE CULVERT RUNNING UNDER NORTHBOUND US-23. THIS STATION WAS ESTABLISHED BY THE CITY OF ANN ARBOR IN 1993.

Benchmark

Vertical

Accuracy	2nd Order Class II
Datum	NAVD 88
Elevation in meters	245.659
Elevation in International feet	805.97

No. 1019
 Sector: EC