

CONTROL STATION DATA SHEET

Approximate Location: E. Huron St. and S. State St.

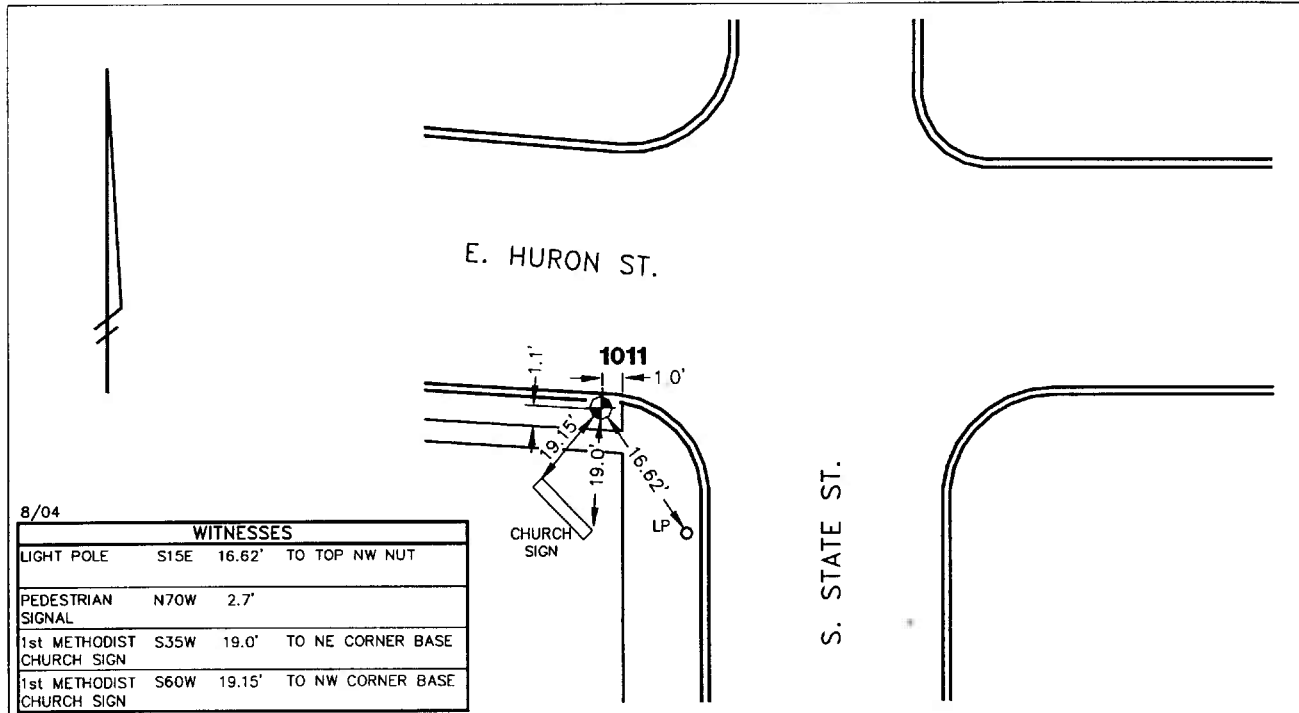

STATION 1011 IS LOCATED AT THE SOUTHWEST CORNER OF EAST HURON STREET AND SOUTH STATE STREET, SAID STATION BEING IN THE NORTHEAST 1/4 OF SECTION 29, ANN ARBOR TOWNSHIP IN THE CITY OF ANN ARBOR, MICHIGAN. THE STATION IS LOCATED 1.1' NORTH OF THE NORTH EDGE OF THE 5.0' CONCRETE WALK ALONG THE SOUTH SIDE OF EAST HURON STREET AND 1.0' WEST OF THE WEST EDGE OF THE 10.0' CONCRETE WALK ALONG THE WEST SIDE OF SOUTH STATE STREET. SAID STATION IS A VERTICAL CONTROL STATION AND IS DESCRIBED AS THE 1993 EDITION OF THE CITY OF ANN ARBOR BRASS DISC, SET IN CONCRETE PER DETAIL II AND IS FLUSH WITH THE GROUND. THIS STATION WAS SET BY THE CITY OF ANN ARBOR IN 1993.

Benchmark

Vertical

Accuracy	2nd Order Class II
Datum	NAVD 88
Elevation in meters	266.187
Elevation in International feet	873.32

No. 1011
Sector: WC