

CONTROL STATION DATA SHEET

Approximate Location: Fuller Rd. at the Conrail Railroad

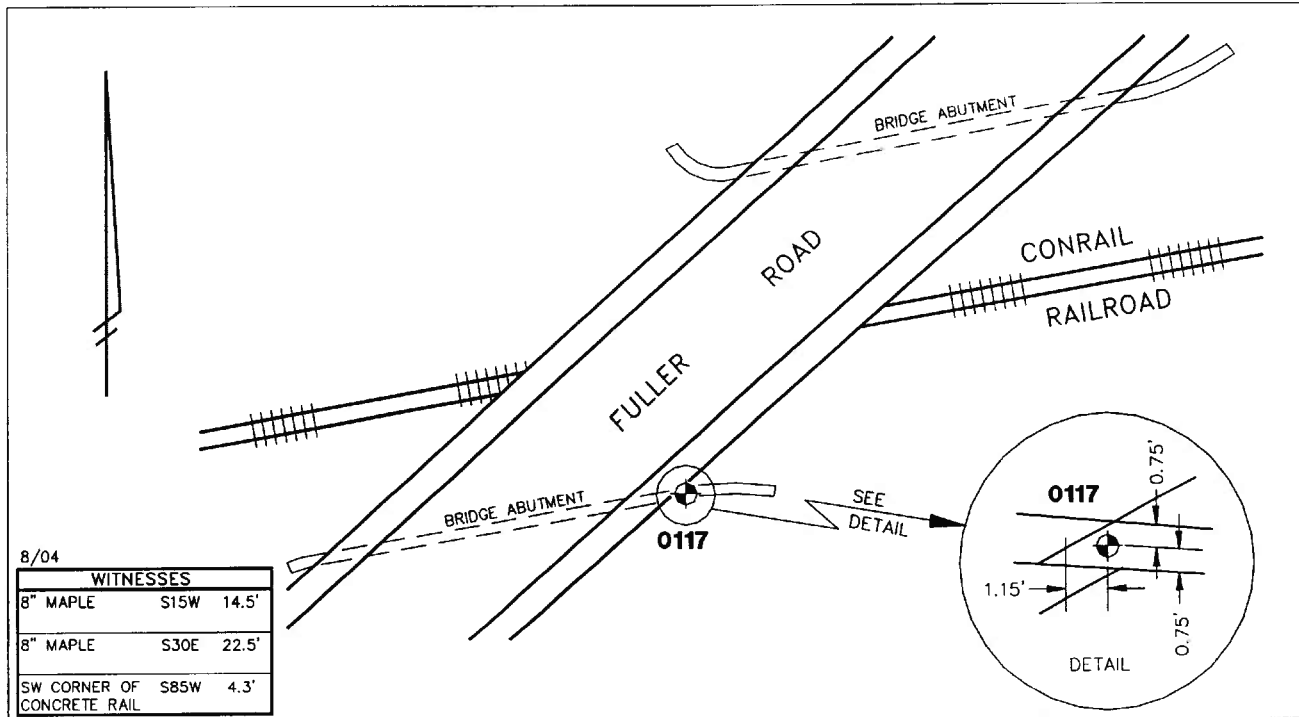

STATION 0117 IS LOCATED ON THE SOUTHEASTERLY CONCRETE WING WALL TO THE FULLER ROAD BRIDGE OVER THE CONRAIL RAILROAD, SAID STATION BEING IN THE NORTHWEST 1/4 OF SECTION 28, ANN ARBOR TOWNSHIP IN THE CITY OF ANN ARBOR, MICHIGAN. THE STATION IS LOCATED 1.15' SOUTHEAST OF THE SOUTHEASTERLY EDGE OF THE BRIDGE AND 0.75' NORTHWESTERLY OF THE SOUTHERLY EDGE OF THE AFOREMENTIONED ABUTMENT WING WALL. SAID STATION IS A VERTICAL CONTROL STATION AND IS DESCRIBED AS A NATIONAL GEODETIC SURVEY DISC STAMPED: R 338 1985, SET IN THE CONCRETE WING WALL, FLUSH WITH THE TOP. THIS STATION IS A NATIONAL GEODETIC SURVEY POINT, WITH THE DESIGNATION: R 338, AND PID: NE1046.

Benchmark

Vertical

| | |
|---------------------------------|--------------------|
| Accuracy | 1st Order Class II |
| Datum | NAVD 88 |
| Elevation in meters | 244.356 |
| Elevation in International feet | 801.69 |

No. 0117
Sector: WC