

CONTROL STATION DATA SHEET

Approximate Location: University of Michigan Diagonal

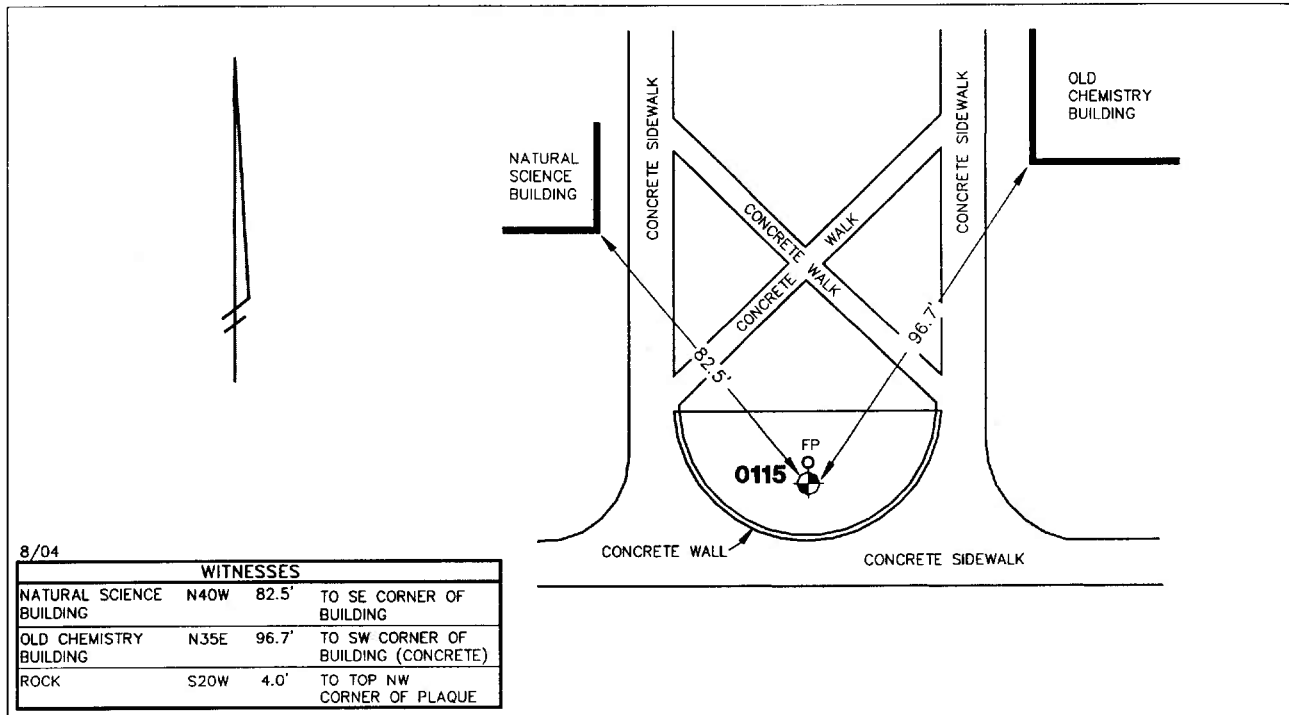

8/04

WITNESSES			
NATURAL SCIENCE BUILDING	N40W	82.5'	TO SE CORNER OF BUILDING
OLD CHEMISTRY BUILDING	N35E	96.7'	TO SW CORNER OF BUILDING (CONCRETE)
ROCK	S20W	4.0'	TO TOP NW CORNER OF PLAQUE

STATION 0115 IS LOCATED IN THE DIAGONAL ON THE GROUNDS OF THE UNIVERSITY OF MICHIGAN, 403' SOUTH OF NORTH UNIVERSITY AVENUE, SAID STATION BEING IN THE SOUTHWEST 1/4 OF SECTION 28, ANN ARBOR TOWNSHIP IN THE CITY OF ANN ARBOR, MICHIGAN. THE STATION IS IN THE SOUTH SIDE OF THE CONCRETE BASE OF THE FLAGPOLE LOCATED BETWEEN THE OLD CHEMISTRY BUILDING AND THE NATURAL SCIENCE BUILDING AND 12.6' NORTH OF THE SOUTHERLY MOST EDGE OF THE SEMICIRCULAR CONCRETE WALL AROUND THE FLAGPOLE. SAID STATION IS A VERTICAL CONTROL STATION AND IS DESCRIBED AS A U.S. COAST AND GEODETIC SURVEY DISC STAMPED: UNIV OF MICHIGAN 1934. THIS IS A NATIONAL GEODETIC SURVEY STATION WITH THE DESIGNATION: UNIV OF MICHIGAN, AND PID: NE0655.

Benchmark

Vertical

Accuracy	1st Order Class II
Datum	NAVD 88
Elevation in meters	267.769
Elevation in International feet	878.51

No. 0115
Sector: WC