

Primary Control Point

AAGRS No. 0007B

City of Ann Arbor  
Public Services Area • Project Management Unit  
CONTROL STATION DATA SHEET

NGS PID AA5182

Approximate Location: Plymouth Rd. and US-23

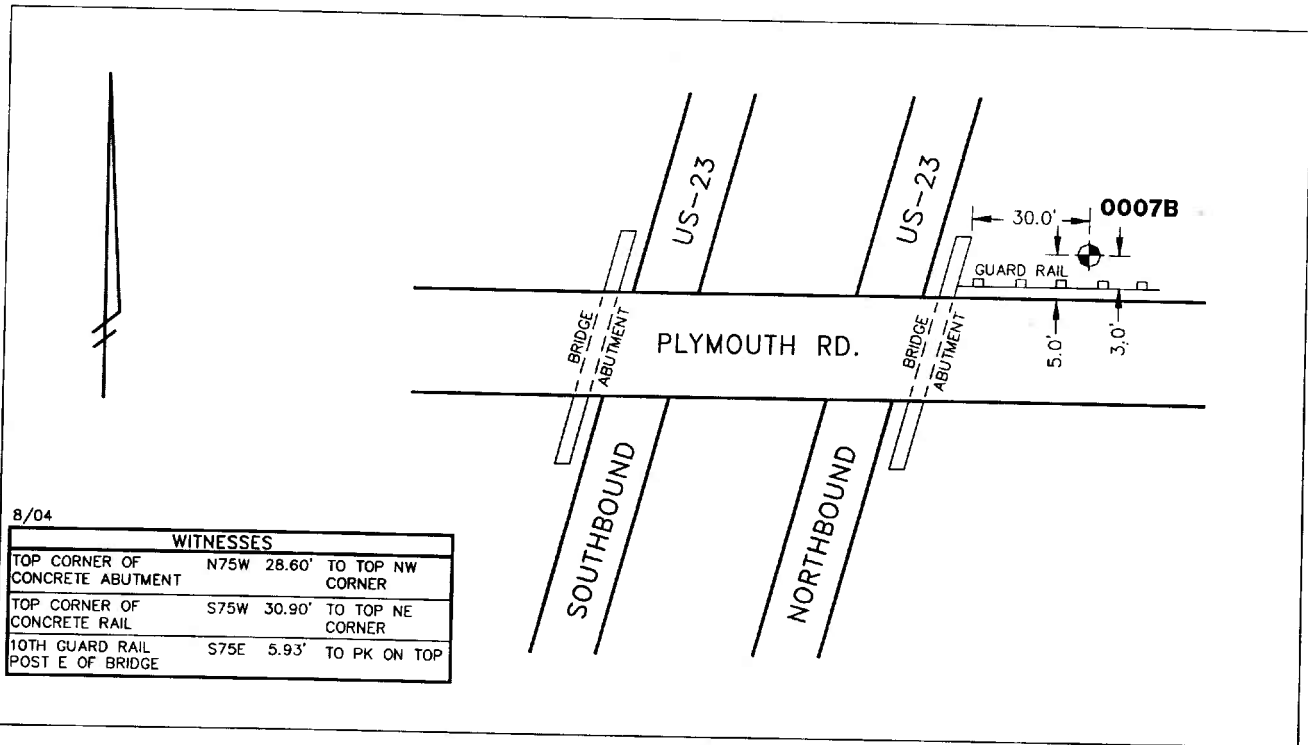

8/04

WITNESSES		
TOP CORNER OF CONCRETE ABUTMENT	N75W 28.60'	TO TOP NW CORNER
TOP CORNER OF CONCRETE RAIL	S75W 30.90'	TO TOP NE CORNER
10TH GUARD RAIL POST E OF BRIDGE	S75E 5.93'	TO PK ON TOP

STATION 0007B IS LOCATED ON THE NORTH SIDE OF PLYMOUTH ROAD, EAST OF THE US-23 BRIDGE, SAID STATION BEING IN THE SOUTHEAST 1/4 OF SECTION 14, ANN ARBOR TOWNSHIP, MICHIGAN. THE STATION IS LOCATED 30' EAST OF THE EAST EDGE OF THE EASTERLY CONCRETE BRIDGE ABUTMENT AND 3' NORTH OF THE GUARDRAIL ALONG THE NORTH SIDE OF PLYMOUTH ROAD. SAID STATION IS A PRIMARY CONTROL STATION AND IS DESCRIBED AS THE 1993 EDITION OF THE CITY OF ANN ARBOR BRASS DISC, SET IN CONCRETE PER DETAIL I AND IS FLUSH WITH THE GROUND. THIS STATION WAS SET BY THE CITY OF ANN ARBOR IN 1993 AND IS PAIRED WITH STATION 0007A.

Horizontal		Vertical	
Latitude (dms)	N 42 18 24.53279	Accuracy	2nd Order Class II
Longitude (dms)	W 83 41 12.07007	Datum	NAVD 88
State Plane Zone	2113 MI South	Elevation in meters	277.709
Scale	0.99995745	Elevation in International feet	911.12
Geoid Height in meters	-33.86		
Convergence (dms)	0 27 45.9		
Accuracy	1st Order		
Datum	NAD 83		
Easting (X) in meters	4056062.473		No. 0007B
Northing (Y) in meters	89845.853		Sector: NE
Easting (X) in International feet	13307291.578		
Northing (Y) in International feet	294769.859	Grid Azimuth to Control Station 0007A	351°45'34"