

City of Ann Arbor
Public Services Area • Project Management Unit
CONTROL STATION DATA SHEET

Approximate Location: Fuller Rd. and Furstenberg Park Nature Area

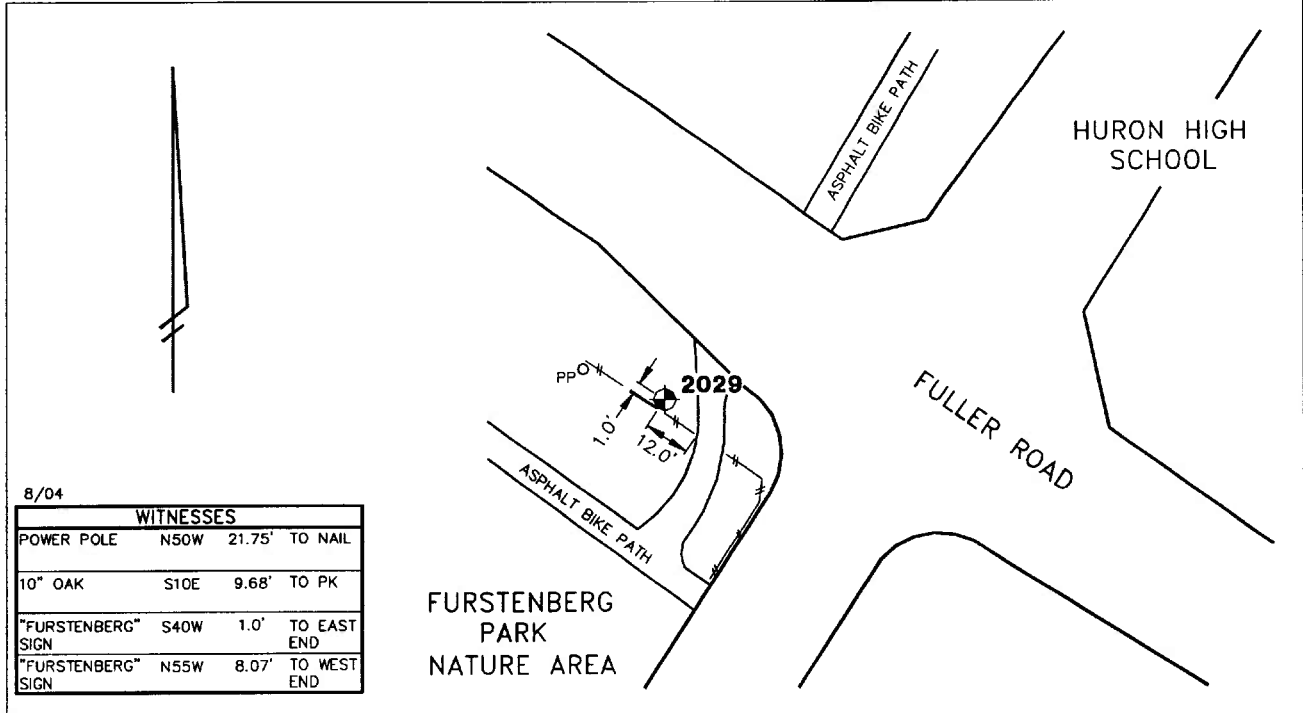

8/04

WITNESSES			
POWER POLE	N50W	21.75'	TO NAIL
10" OAK	S10E	9.68'	TO PK
"FURSTENBERG" SIGN	S40W	1.0'	TO EAST END
"FURSTENBERG" SIGN	N55W	8.07'	TO WEST END

STATION 2029 IS LOCATED AT THE SOUTHWESTERLY SIDE OF FULLER ROAD AND NORTHWESTERLY OF THE ENTRANCE TO FURSTENBERG PARK NATURE AREA, SAID STATION BEING IN THE NORTHEAST 1/4 OF SECTION 27, ANN ARBOR TOWNSHIP IN THE CITY OF ANN ARBOR, MICHIGAN. THE STATION IS LOCATED 11.3' SOUTHWESTERLY OF THE SOUTHWESTERLY EDGE OF THE ASPHALT PAVEMENT ALONG FULLER ROAD AND 40' NORTHWESTERLY OF THE NORTHWESTERLY BACK OF CURB (EXTENDED) OF THE ASPHALT DRIVE INTO FURSTENBERG PARK NATURE AREA. SAID STATION IS A VERTICAL CONTROL STATION AND IS DESCRIBED AS THE 1993 EDITION OF THE CITY OF ANN ARBOR BRASS DISC, SET IN CONCRETE PER DETAIL II AND IS FLUSH WITH THE GROUND. THE STATION WAS SET BY THE CITY OF ANN ARBOR IN 2001.

Benchmark

Vertical	
Accuracy	Local Control
Datum	NAVD 88
Elevation in meters	231.009
Elevation in International feet	757.90

No. 2029
Sector: EC