

City of Ann Arbor
Public Services Area • Project Management Unit
CONTROL STATION DATA SHEET

Approximate Location: Green Rd. and Frederick Dr.

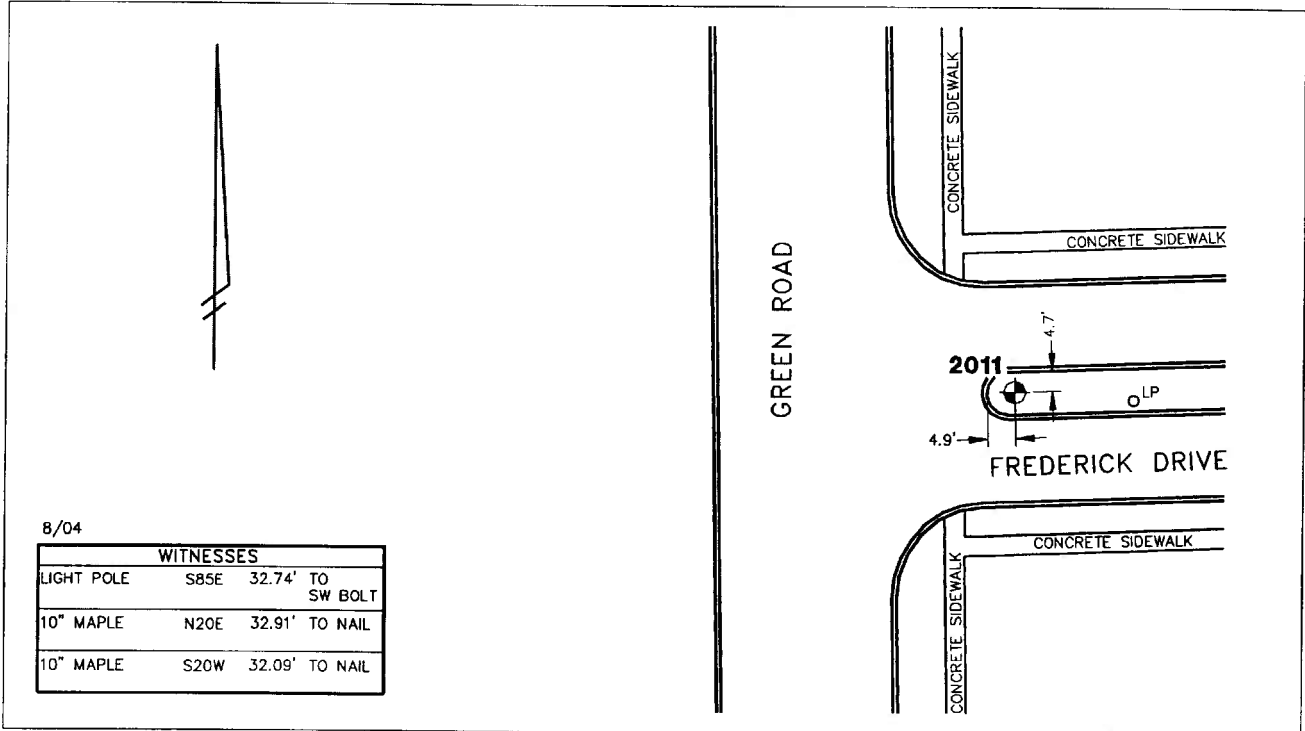

STATION 2011 IS LOCATED IN THE GRASS TRAFFIC ISLAND ON FREDERICK DRIVE AND EASTERLY OF GREEN ROAD, SAID STATION BEING IN THE NORTHEAST 1/4 OF SECTION 23, ANN ARBOR TOWNSHIP IN THE CITY OF ANN ARBOR, MICHIGAN. THE STATION IS LOCATED 4.9' EAST OF THE BACK OF CURB AT THE WEST END OF SAID TRAFFIC ISLAND AND 4.7' SOUTH OF THE NORTH BACK OF CURB OF SAID TRAFFIC ISLAND. SAID STATION IS A VERTICAL CONTROL STATION AND IS DESCRIBED AS THE 1972 EDITION OF THE CITY OF ANN ARBOR BRASS DISC, SET IN CONCRETE PER DETAIL III AND IS FLUSH WITH THE THE GROUND. THE STATION WAS SET BY THE CITY OF ANN ARBOR IN 1972.

Benchmark

	Vertical	
Accuracy		Local Control
Datum		NAVD 88
Elevation in meters		270.384
Elevation in International feet		887.09

No. 2011
Sector: NE