

City of Ann Arbor
Public Services Area • Project Management Unit
CONTROL STATION DATA SHEET

NGS PID

Approximate Location: Green Rd. and Glazier Way

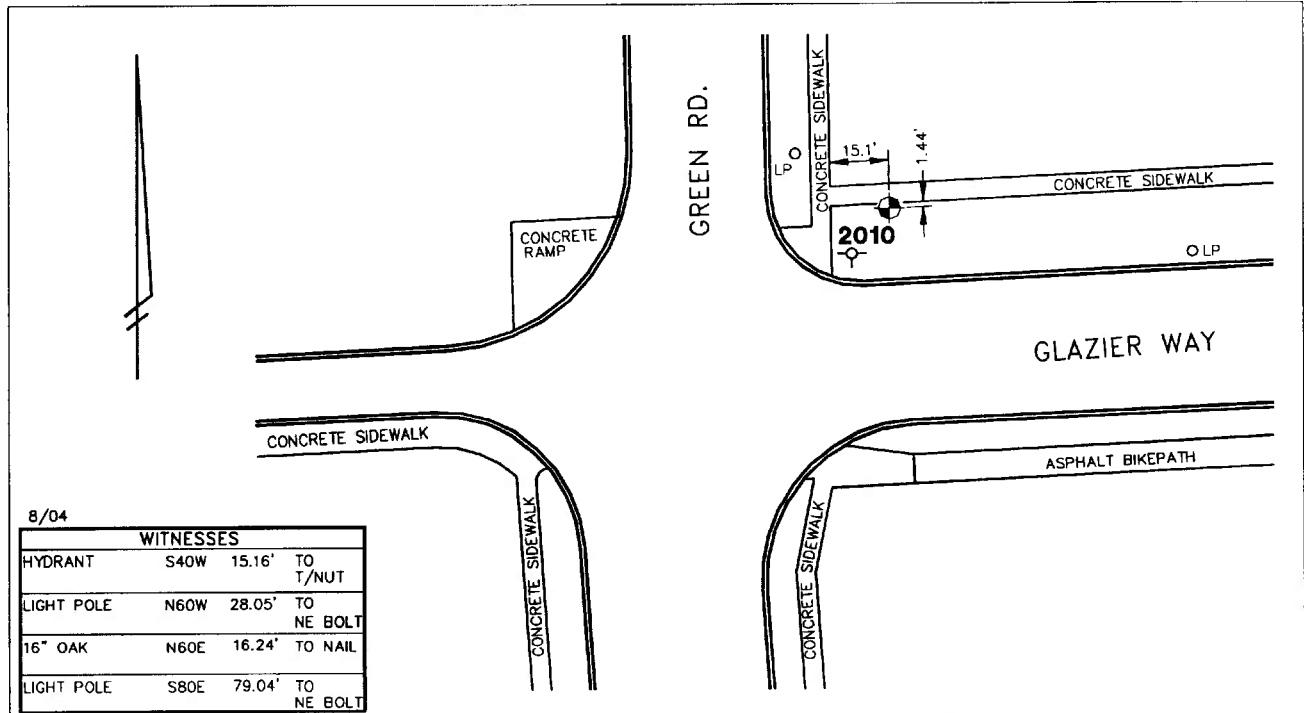

STATION 2010 IS LOCATED AT THE NORTHEAST CORNER OF GREEN ROAD AND GLAZIER WAY, SAID STATION BEING IN THE SOUTHEAST 1/4 OF SECTION 23, ANN ARBOR TOWNSHIP IN THE CITY OF ANN ARBOR, MICHIGAN. THE STATION IS LOCATED 1.44' SOUTH OF THE SOUTH EDGE OF THE 5.0' CONCRETE WALK ALONG THE NORTH SIDE OF GLAZIER WAY AND 15.1' EAST OF THE EAST EDGE OF THE 5.0' CONCRETE WALK ALONG THE EAST SIDE OF GREEN ROAD. SAID STATION IS A VERTICAL CONTROL STATION AND IS DESCRIBED AS THE 1993 EDITION OF THE CITY OF ANN ARBOR BRASS DISC, SET IN CONCRETE PER DETAIL II AND IS FLUSH WITH THE GROUND. THE STATION WAS SET BY THE CITY OF ANN ARBOR IN 1998.

Benchmark

Vertical	
Accuracy	Local Control
Datum	NAVD 88
Elevation in meters	271.281
Elevation in International feet	890.03

No. 2010
Sector: EC