

**City of Ann Arbor  
Public Services Area • Project Management Unit  
CONTROL STATION DATA SHEET**

**Approximate Location: Earhart Rd. and Glazier Way**

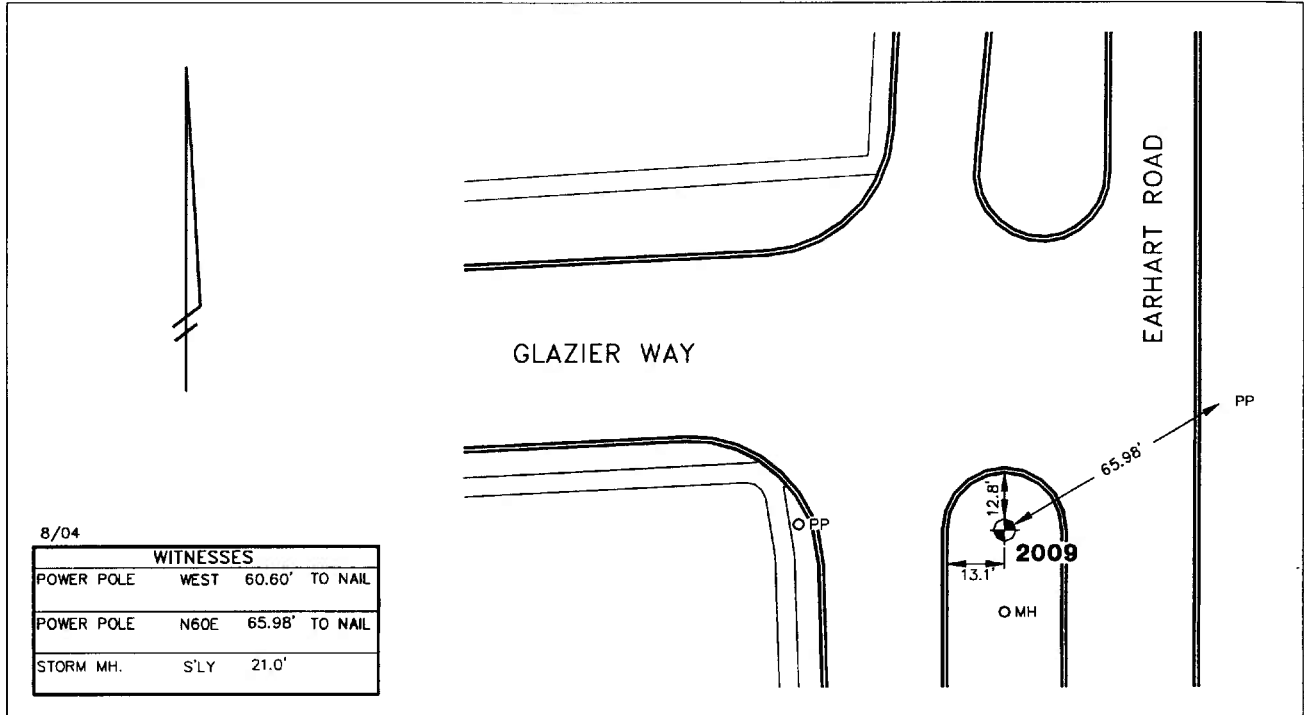

STATION 2009 IS LOCATED IN THE GRASS TRAFFIC ISLAND ON EARHART ROAD AND SOUTHERLY OF GLAZIER WAY, SAID STATION BEING IN THE NORTHEAST 1/4 OF SECTION 26, ANN ARBOR TOWNSHIP IN THE CITY OF ANN ARBOR, MICHIGAN. THE STATION IS LOCATED 12.8 SOUTH OF THE BACK OF CURB AT THE NORTH END OF SAID TRAFFIC ISLAND AND 13.1' EAST OF THE WEST BACK OF CURB OF SAID TRAFFIC ISLAND. SAID STATION IS A VERTICAL CONTROL STATION AND IS DESCRIBED AS THE 1993 EDITION OF THE CITY OF ANN ARBOR BRASS DISC, SET IN CONCRETE PER DETAIL II AND IS FLUSH WITH THE GROUND. THE STATION WAS SET BY THE CITY OF ANN ARBOR IN 2001.

**Benchmark**

**Vertical**

Accuracy	Local Control
Datum	NAVD 88
Elevation in meters	271.901
Elevation in International feet	892.06

**No. 2009  
Sector: EC**