

City of Ann Arbor  
Public Services Area • Project Management Unit  
**CONTROL STATION DATA SHEET**

Approximate Location: Packard Rd. and Platt Rd.

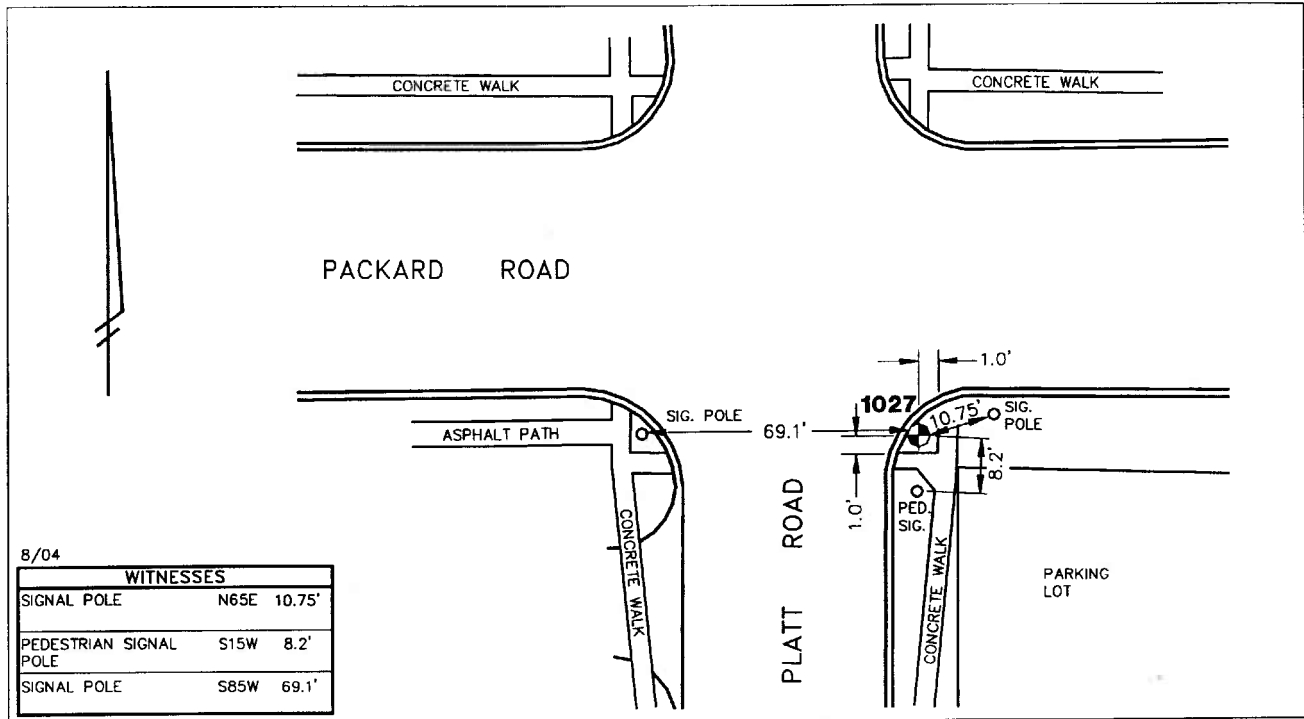

STATION 1027 IS LOCATED AT THE SOUTHEAST CORNER OF PACKARD ROAD AND PLATT ROAD, SAID STATION BEING IN THE NORTHWEST 1/4 OF SECTION 11, PITTSFIELD TOWNSHIP IN THE CITY OF ANN ARBOR, MICHIGAN. THE STATION IS LOCATED 1.0' WEST OF THE WEST EDGE OF THE 5.0' CONCRETE RAMP ALONG THE EAST SIDE OF PLATT ROAD AND 1.0' NORTH OF THE NORTH EDGE OF THE CONCRETE RAMP ALONG THE SOUTH SIDE OF PACKARD ROAD. SAID STATION IS A VERTICAL CONTROL STATION AND IS DESCRIBED AS THE 1993 EDITION OF THE CITY OF ANN ARBOR BRASS DISC, SET IN CONCRETE PER DETAIL II AND IS SET FLUSH WITH THE GROUND. THE STATION WAS SET BY THE CITY OF ANN ARBOR IN 1993.

**Benchmark**

**Vertical**

Accuracy	2nd Order Class II
Datum	NAVD 88
Elevation in meters	250.478
Elevation in International feet	821.78

**No. 1027**  
**Sector: SE**