

ELEVATION

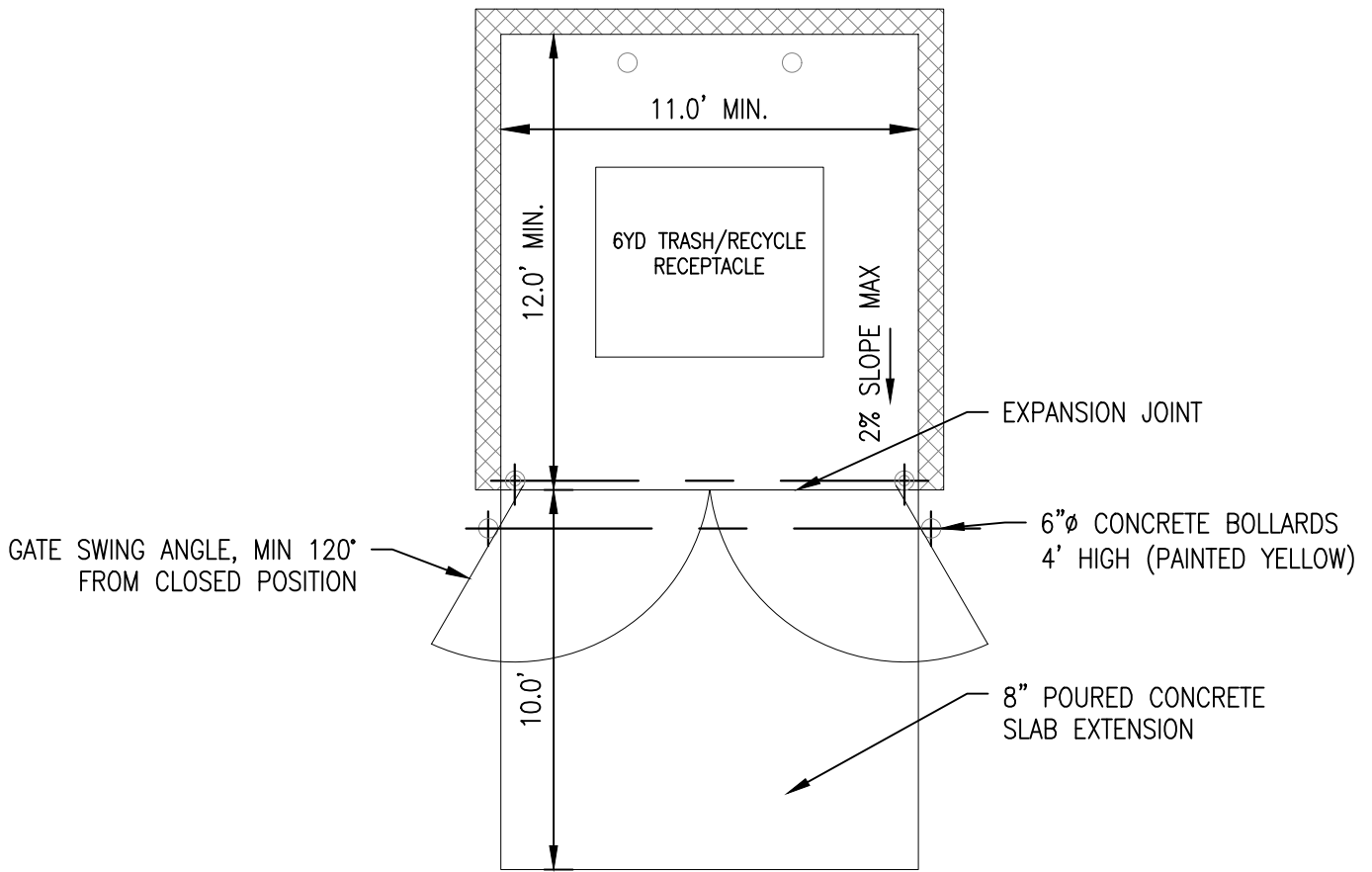

PLAN

SINGLE BIN ENCLOSURE DETAIL



**CITY OF ANN ARBOR
PUBLIC SERVICES**
301 EAST HURON STREET
P.O. BOX 8647
ANN ARBOR, MI 48107-8647
734-794-6410
www.a2gov.org

00	06/04/18	OHM	CJE
REV. NO.	DATE	DRAWN BY	CHECKED BY
SOLID WASTE STANDARD DETAILS			
DR. OHM	CH. CJE	DRAWING NO.	
SCALE N.T.S.	DATE 12/29/15	PAGE 1	

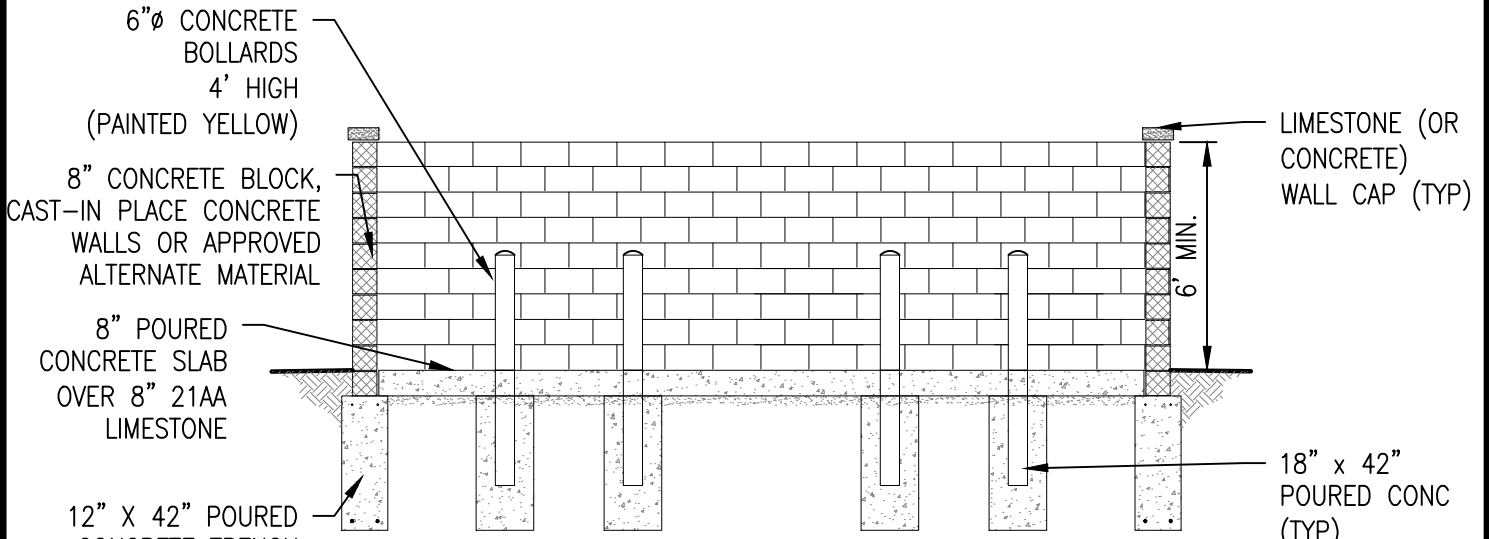

ELEVATION

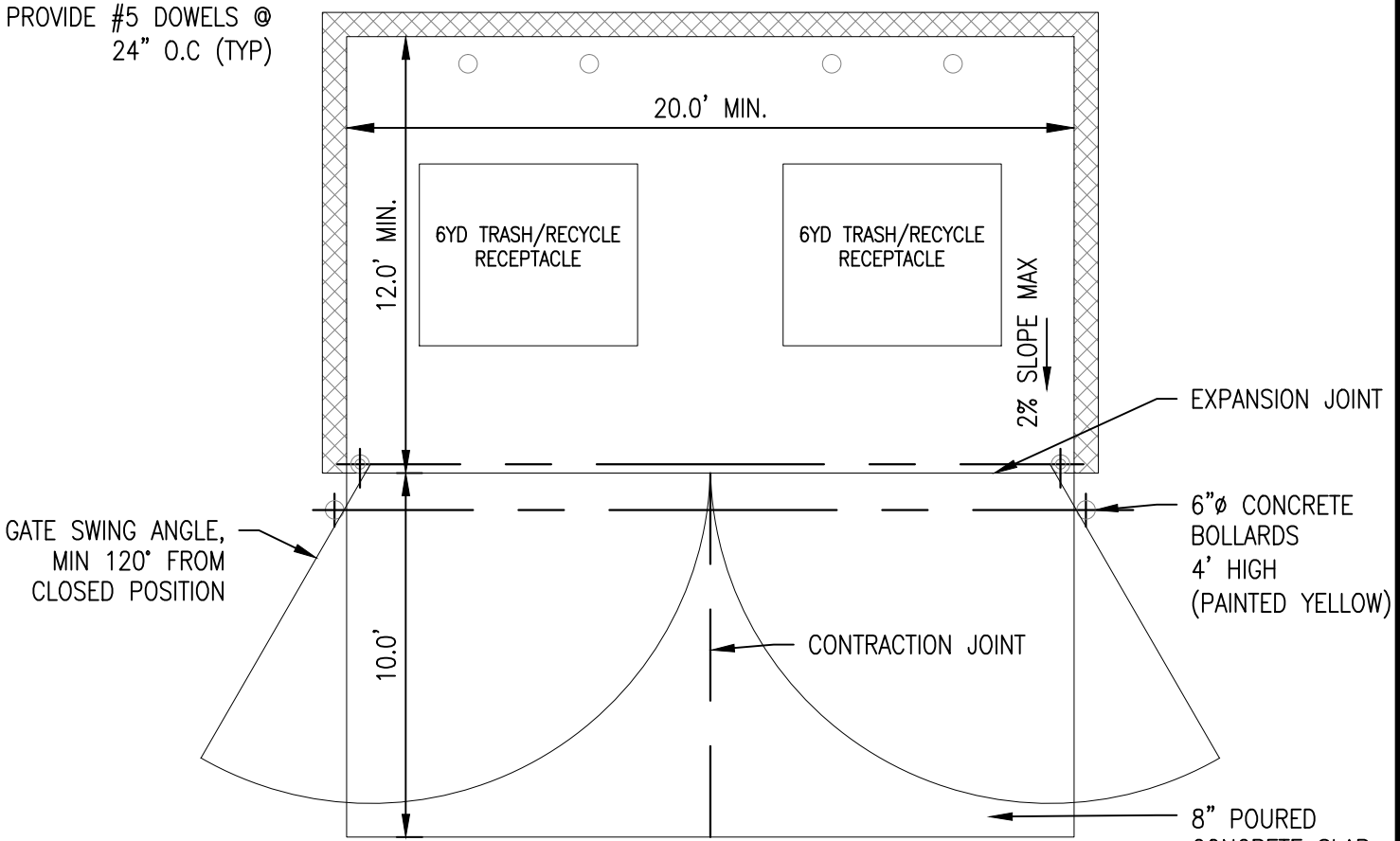

PLAN

DOUBLE BIN ENCLOSURE DETAIL



**CITY OF ANN ARBOR
PUBLIC SERVICES**
301 EAST HURON STREET
P.O. BOX 8647
ANN ARBOR, MI 48107-8647
734-794-6410
www.a2gov.org

REV. NO.	DATE	DRAWN BY	CHECKED BY
SOLID WASTE STANDARD DETAILS			
DR. OHM	CH. CJE	DRAWING NO.	
SCALE N.T.S.	DATE 12/29/15	PAGE 2	

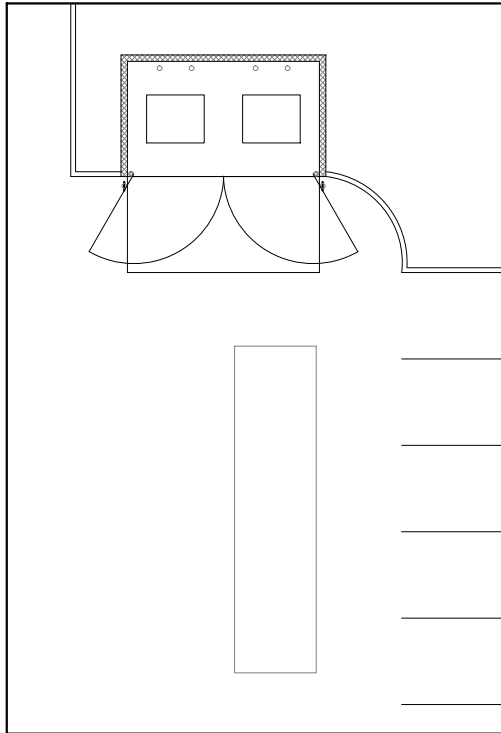

DIRECT ACCESS
(PREFERRED)

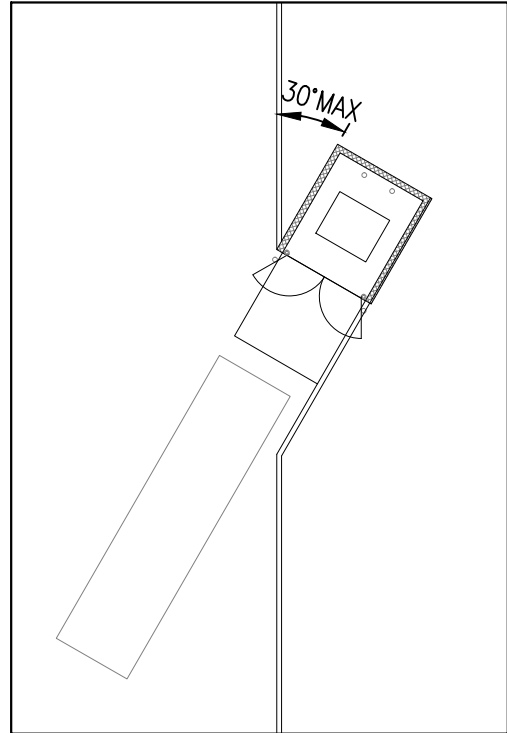

OPTIONAL ANGLED DIRECT ACCESS
(ACCEPTABLE WITH APPROVAL)

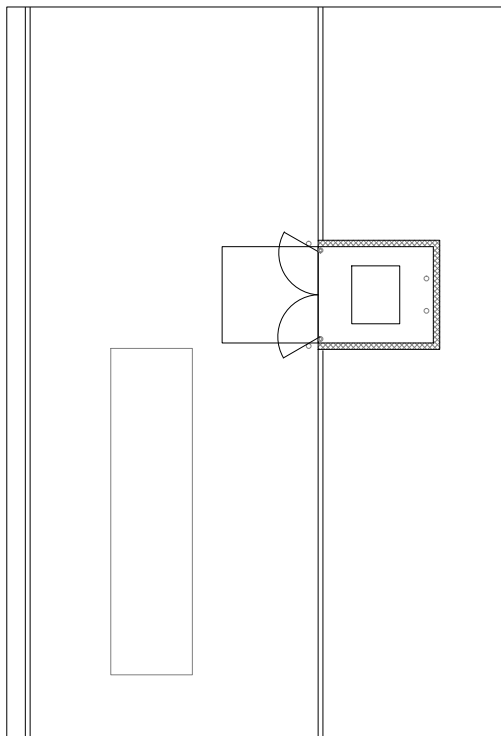

NON-DIRECT ACCESS
(NOT ACCEPTABLE)

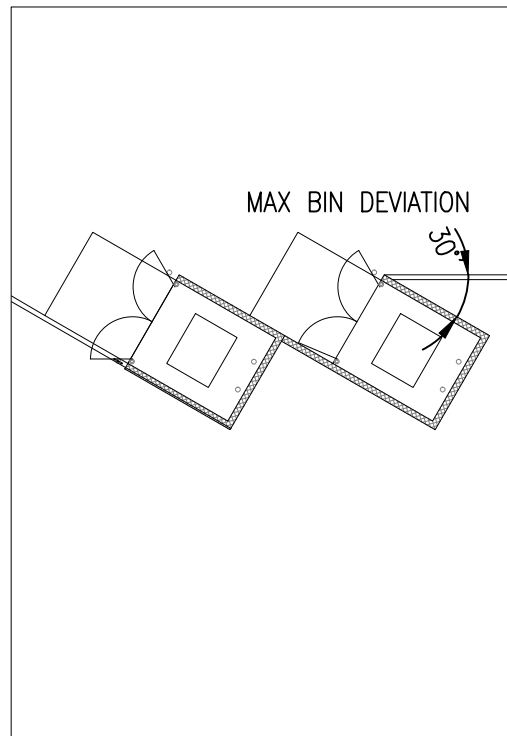

OPTIONAL ANGLED DIRECT ACCESS
(ACCEPTABLE WITH APPROVAL)

STANDARD BIN ENCLOSURE LAYOUTS



**CITY OF ANN ARBOR
PUBLIC SERVICES**
301 EAST HURON STREET
P.O. BOX 8647
ANN ARBOR, MI 48107-8647
734-794-6410
www.a2gov.org

REV. NO.	DATE	DRAWN BY	CHECKED BY
SOLID WASTE STANDARD DETAILS			
DR. OHM	CH. CJE	DRAWING NO.	
SCALE N.T.S.	DATE 12/29/15	PAGE 3	

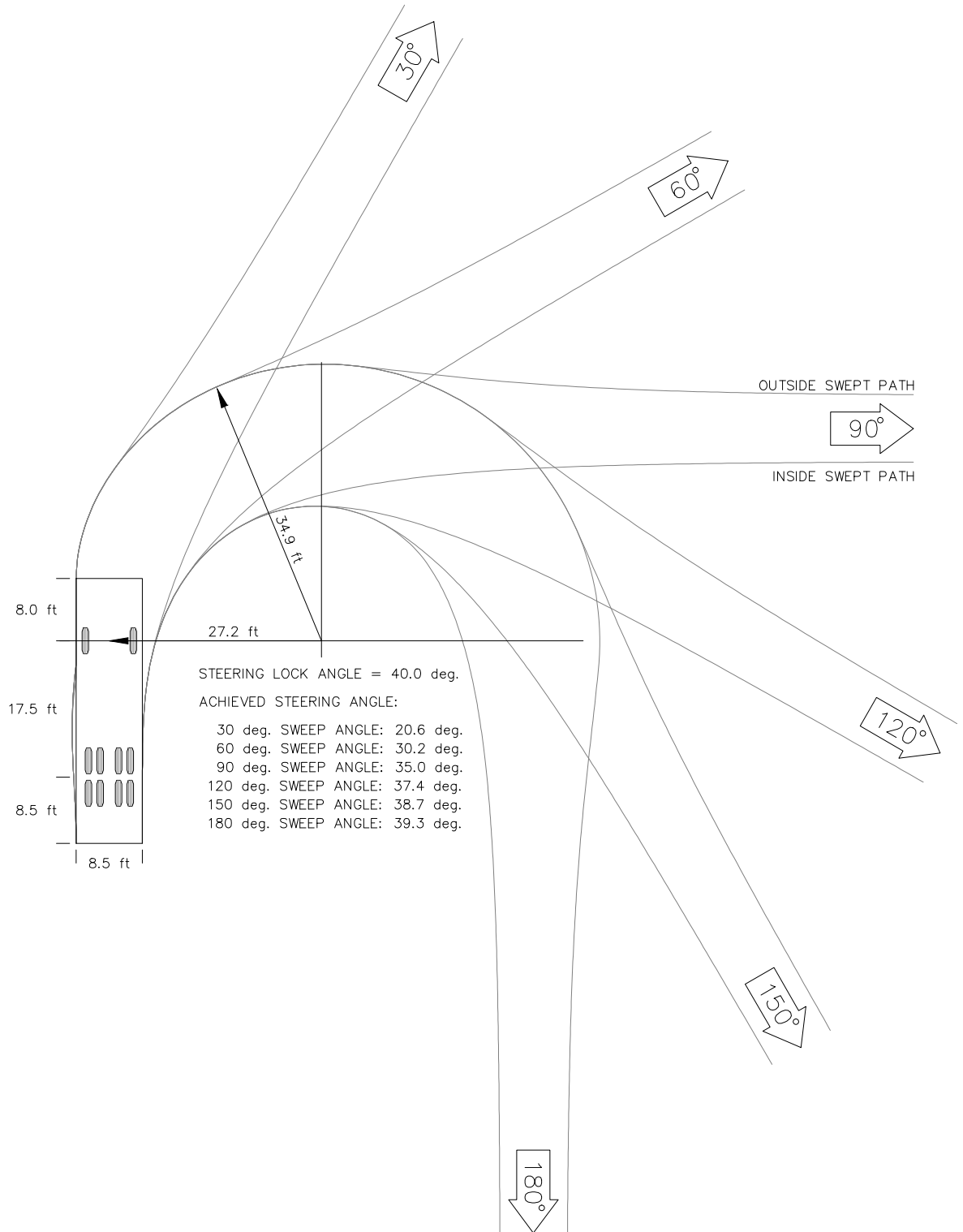

CLEARANCE REQUIREMENTS FOR FRONT LOAD SOLID WASTE VEHICLE



**CITY OF ANN ARBOR
PUBLIC SERVICES**
301 EAST HURON STREET
P.O. BOX 8647
ANN ARBOR, MI 48107-8647
734-794-6410
www.a2gov.org

REV. NO.	DATE	DRAWN BY	CHECKED BY
SOLID WASTE STANDARD DETAILS			
DR. OHM	CH. CJE	DRAWING NO.	
SCALE N.T.S.	DATE 12/08/15	PAGE 4	

GENERAL NOTES:

1. A CLEAR SPACE MUST BE MAINTAINED DIRECTLY IN FRONT OF THE SOLID WASTE ENCLOSURE. THE CLEAR SPACE SHALL BE A MINIMUM OF FIFTY (50) FEET LONG BY THE WIDTH OF THE INSIDE DIMENSION OF THE ENCLOSURE PLUS FOUR (4) FEET ON BOTH SIDES. A MINIMUM VERTICAL CLEARANCE OF AT LEAST TWENTY-FIVE (25) FEET MUST BE PROVIDED ABOVE THIS AREA.
2. INGRESS AND EGRESS ROUTES MUST BE DEVELOPED BASED ON SOLID WASTE SWEEP PATH REQUIREMENTS. A MINIMUM HORIZONTAL CLEARANCE OF TWO (2) FEET FROM THE EDGE OF THE SWEEP PATH AND A MINIMUM VERTICAL CLEARANCE OF AT LEAST FIFTEEN (15) FEET MUST BE PROVIDED ALONG THE ENTIRE ROUTE.
3. GATES ON ENCLOSURES MUST BE DESIGNED TO OPEN A MINIMUM OF 120 DEGREES FROM THE CLOSED POSITION. THE GATES MUST NOT REDUCE THE REQUIRED ENCLOSURE OPENING WIDTH, BLOCK ADJACENT PARKING SPOTS, OR BE IMPEDED BY ADJACENT CURBS OR LANDSCAPING.
4. GATES SHALL BE DESIGNED TO BE FREE STANDING WITHOUT A CENTER POLE. IF A CENTER POLE DESIGN IS NECESSARY, 12-INCHES SHALL BE ADDED TO THE OVERALL WIDTH OF THE ENCLOSURE.
5. GATE DESIGN SHALL INCLUDE A RELIABLE MEANS TO SECURE THE DOOR IN BOTH THE OPEN AND CLOSED POSITIONS.
6. THE CONCRETE SLAB IN FRONT OF THE BIN ENCLOSURE SHALL HAVE PAVEMENT MARKINGS TO INDICATE "NO PARKING", AS APPROVED BY CITY.
7. THE PROPERTY OWNER SHALL BE RESPONSIBLE FOR THE INSTALLATION AND MAINTENANCE OF NO PARKING SIGNS ALONG THE SOLID WASTE INGRESS/EGRESS ROUTE TO ENSURE THE ROUTE REMAINS FREE OF OBSTRUCTIONS.
8. REFER TO ASSOCIATED STANDARD DETAILS FOR REQUIREMENTS ON SINGLE AND DOUBLE WIDE SOLID WASTE BIN ENCLOSURE LAYOUT AND DESIGN CRITERIA. THE CITY SHALL HAVE THE ABILITY TO MODIFY OR INTERPRET THESE DETAILS AS NECESSARY, TO ACCOMMODATE THE CITY OR CITY CONTRACTOR NEEDS IN REGARDS TO SOLID WASTE PICK-UP.
9. SOLID WASTE ACCESS ROADS AND SERVICE AREA SURFACES SHALL BE DESIGNED AND MAINTAINED TO SUPPORT THE IMPOSED LOADS OF COLLECTION TRUCKS WEIGHING UP TO 66,000 LBS GROSS VEHICLE WEIGHT (GVW) AND SHALL BE PROVIDED WITH AN APPROVED SURFACE SO AS TO PROVIDE ALL WEATHER DRIVING CAPABILITIES. PROPERTY OWNER SHALL BE RESPONSIBLE FOR ALL SNOW AND ICE REMOVAL REQUIRED FOR SAFE ACCESS OF SOLID WASTE VEHICLES.
10. THE SOLID WASTE COLLECTION LOCATION SHALL BE LOCATED A MINIMUM OF TEN (10) FEET AWAY FROM MAJOR ELECTRICAL EQUIPMENT, ABOVE GROUND UTILITY SERVICES, TREE BRANCHES, BALCONIES OR OTHER OVERHEAD OBSTRUCTIONS.



**CITY OF ANN ARBOR
PUBLIC SERVICES**
301 EAST HURON STREET
P.O. BOX 8647
ANN ARBOR, MI 48107-8647
734-794-6410
www.a2gov.org

00	06/05/18	OHM	CJE
REV. NO.	DATE	DRAWN BY	CHECKED BY
SOLID WASTE STANDARD DETAILS			
DR. OHM	CH. CJE	DRAWING NO.	
SCALE N.T.S.	DATE 02/01/16	PAGE 5	

GENERAL NOTES CONTINUED:

11. IF FORWARD ACCESS TO THE PUBLIC STREET IS NOT AVAILABLE FOR THE SOLID WASTE TRUCK, THE SITE DEVELOPMENT LAYOUT MUST ACCOMMODATE A TURN-AROUND LOCATION.
12. FOR SITES THAT CANNOT ACCOMMODATE A TURN-AROUND, THE FOLLOWING REQUIREMENTS MUST BE MET:
 - 12.1. SOLID WASTE TRUCKS MUST BE ABLE TO SERVICE DUMPSTERS WITHOUT IMPEDING THE PUBLIC STREET OR SIDEWALK.
 - 12.2. THE DUMPSTER COLLECTION LOCATION SHALL BE CLEARLY DELINEATED AND NOT HAVE A SLOPE GREATER THAN 2% IN ANY DIRECTION.
 - 12.3. BOLLARDS OR ADEQUATE CLEAR SPACE MUST BE PROVIDED BEHIND THE LIFT POINT SO THE DUMPSTERS ARE NOT POTENTIALLY PUSHED INTO ANY BUILDING OR ACCESS ROUTE.
 - 12.4. ALL SWEEP-PATH CLEARANCE REQUIREMENTS PREVIOUSLY IDENTIFIED SHALL BE PROVIDED.
 - 12.5. A VERTICAL CLEARANCE OF 25 FEET SHALL BE PROVIDED ABOVE THE COLLECTION LOCATION.
13. FOR SITES THAT CANNOT ACCOMMODATE A STANDARD DUMPSTER ENCLOSURE, THE DUMPSTERS MAY BE ROLLED OUT OF A BUILDING OR ALTERNATE ENCLOSURE BY THE PROPERTY OWNER TO A PROPOSED COLLECTION LOCATION. A COLLECTION SCHEDULE FOR RECYCLING AND TRASH COLLECTION SHALL BE PROVIDED ON THE SITE PLAN.
14. FOR SITES ADJACENT TO A PUBLIC ALLEY, SOLID WASTE TRUCKS ARE PERMITTED TO ACCESS THE PROPERTY THROUGH THE ALLEY IF SWEEP-PATH CLEARANCE REQUIREMENTS CAN BE PROVIDED.
15. SOLID WASTE COLLECTION LOCATIONS MUST BE LOCATED WITHIN THE BOUNDARIES OF THE PROPERTY.



**CITY OF ANN ARBOR
PUBLIC SERVICES**
301 EAST HURON STREET
P.O. BOX 8647
ANN ARBOR, MI 48107-8647
734-794-6410
www.a2gov.org

00	06/05/18	OHM	CJE
REV. NO.	DATE	DRAWN BY	CHECKED BY
SOLID WASTE STANDARD DETAILS			
DR. OHM	CH. CJE	DRAWING NO.	
SCALE N.T.S.	DATE 02/01/16	PAGE 6	