

**City of Ann Arbor, Michigan**  
**FY2008-2013 Capital Improvements Plan**  
**Transportation – Other Transportation Projects**

# Other Transportation Projects

*Installation and modernization of traffic signals or street lighting; studies; repairs & rehabilitation in R.O.W., etc.*

---

## **CAPITAL PROGRAM SUMMARY**

This section of the Capital Improvements Plan includes miscellaneous transportation projects which meet the criteria for inclusion in the plan but cannot be categorized elsewhere. This may include the design and programming for: installation of new traffic signals; signal interconnections; street lighting; repair and replacement of roadside facilities such as retaining walls, guard rails, etc. These projects are designed to improve safety for motorists and pedestrians, as well as to improve the traffic capacity of the roadways and intersections throughout the City.

This may also include the programming of resources to undertake or update various transportation related studies and master plans.

## **NEEDS ASSESSMENT AND EVALUATION**

Items for the program are selected by the Public Services Area, as well as through citizen and other City service area requests. Locations are evaluated based on condition and the amount of traffic in the area. Projects that eliminate dangerous hazards are priorities.

## **PROJECT SELECTION CRITERIA**

- 2030 Long Range Transportation Plan Update for Washtenaw County (2004)
- FY2006-2008 Transportation Improvement Plan for Washtenaw County (2006)
- Transportation Plan Update (1990)
- Number and type of crashes
- Number of cars and trucks
- Number of pedestrians
- Physical condition or operational function
- Elimination of public hazard

# TABLE OF CONTENTS FOR PROJECT SHEETS

Project Name	Project ID	Page No.
Accessible Pedestrian Signals	TR-OT-10-09	314
Bird Road Retaining Wall	TR-OT-10-06	315
Central Campus Transit Center	TR-OT-10-01	316
Citywide Transportation Plan Update	TR-OT-01-01	317
Devonshire Drive Retaining Wall	TR-OT-10-13	318
Dhu Varren/Nixon Road Intersection Water Encroachment	TR-OT-10-03	319
Ellsworth Road Corridor Study	TR-OT-10-07	320
First and Ashley Streets SCOOT expansion	TR-OT-08-04	321
Fuller/Geddes SCOOT expansion and Interconnect (Glen to US-23)	TR-OT-02-10	322
Geddes Avenue Sloughing Correction	TR-OT-10-04	323
Geddes Road Sloughing Correction	TR-OT-10-05	324
LED Streetlight Conversion	TR-OT-08-09	325
Newport Road Retaining Walls	TR-OT-10-14	326
Newport/Miller Signal	TR-OT-10-15	327
Nixon Road Study	TR-OT-04-04	328
Packard Road Signal Interconnect	TR-OT-01-06	329
Pavement Marking & Sign Systems Replacements	TR-OT-10-10	330
Pedestrian Signal Countdown Heads	TR-OT-10-11	331
Plymouth Road/Commonwealth Signal	TR-OT-01-07	332
S. State and Ellsworth SCOOT Expansion	TR-OT-08-03	333
Safety Projects	TR-OT-08-02	334
Seventh Street Signal Interconnect	TR-OT-01-09	335
State Street Corridor Study	TR-OT-10-08	336
State Street/Hilton Boulevard Intersection	TR-OT-08-07	337
Washtenaw and Platt/Glenwood Intersection Improvements	TR-OT-08-08	338
Watershed Drive Retaining Wall	TR-OT-10-12	339

**PROJECT NAME: Accessible Pedestrian Signals**

**PROJECT ID:** TR-OT-10-09  
**PROJECT TYPE:** Replacement  
**SUBMITTED BY:** PUBLIC SERVICES  
 FIELD OPERATIONS

**PLANNING AREA:** Citywide  
**PRIORITY:** Urgent  
**TOTAL COST:** \$637,500  
**YEARS IN CIP:**

**IDENTIFIED NEED:****LOCATION MAP:****SCOPE ITEMS:**

Status of PROWAG regulations; MMUTCD requirements; Identify existing intersections with audible signals for upgrade per MMUTCD; Coordinate with Ped Countdown Heads need; Investigate what trigger is for Accessible Ped Signal requirements;

**PROJECT JUSTIFICATION:**

Value indicates the degree to which the project will impact the below items:

-1 = Negative Impact; 0 = No Impact; 1 = Minimal Positive Impact;  
 2 = Some Positive Impact; 3 = Positive Impact; 4 = High Positive Impact

- Protects health, safety, lives of citizens
- Meets new, or maintains existing, regulatory compliance
- Provides a net savings in operations and/or maintenance costs
- Enhances social, cultural, recreational or aesthetic opportunities
- Improves customer service, convenience for citizens
- Maintains or improves existing infrastructure, facilities [Expansion = (-1)]
- Reduces energy consumption, impacts on the environment
- TOTAL SCORE**

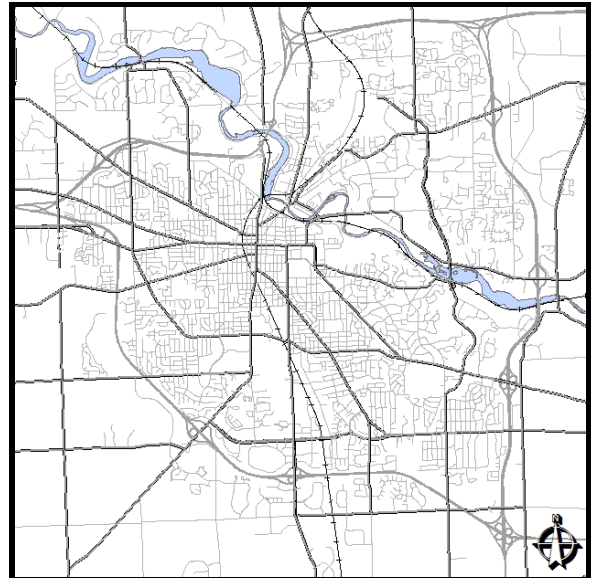
**BENEFICIAL IMPACTS:****MASTER PLAN REFERENCE:**
**STUDY REFERENCE:**  
**POLICY/OTHER REFERENCE:**
**SCHEDULE:**

	Start	End
Study:		
Design/Acquisition:		
Construction:		

**SCHEDULE JUSTIFICATION:**

Rev	Revenue Source Name	Prior Years	Funding (in thousands) *							Beyond FY15	Total
			FY10	FY11	FY12	FY13	FY14	FY15			
2721	OPERATING TRANSFER FROM 0021	\$0	\$0	\$128	\$128	\$128	\$128	\$128	\$128	\$0	\$638
		\$0	\$0	\$128	\$128	\$128	\$128	\$128	\$128	\$0	\$638

**PROJECT NAME: Bird Road Retaining Wall**

**PROJECT ID:** TR-OT-10-06  
**PROJECT TYPE:** Replacement  
**SUBMITTED BY:** PUBLIC SERVICES  
 FIELD OPERATIONS

**PLANNING AREA:** West  
**PRIORITY:** Urgent  
**TOTAL COST:** \$100,000  
**YEARS IN CIP:**

**IDENTIFIED NEED:**

**SCOPE ITEMS:**

Mature trees; Public/ neighbors engagement; Potential to regrade slope? - trees vs. on-going maintenance of wall;

**LOCATION MAP:**

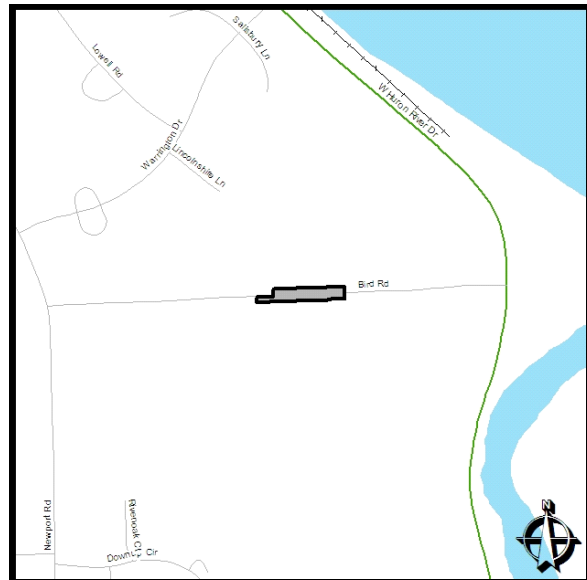

**PROJECT JUSTIFICATION:**

Value indicates the degree to which the project will impact the below items:

-1 = Negative Impact; 0 = No Impact; 1 = Minimal Positive Impact;  
 2 = Some Positive Impact; 3 = Positive Impact; 4 = High Positive Impact

- Protects health, safety, lives of citizens
- Meets new, or maintains existing, regulatory compliance
- Provides a net savings in operations and/or maintenance costs
- Enhances social, cultural, recreational or aesthetic opportunities
- Improves customer service, convenience for citizens
- Maintains or improves existing infrastructure, facilities [Expansion = (-1)]
- Reduces energy consumption, impacts on the environment
- TOTAL SCORE**

**BENEFICIAL IMPACTS:**

**MASTER PLAN REFERENCE:**

**STUDY REFERENCE:  
 POLICY/OTHER REFERENCE:**

**SCHEDULE: Start End SCHEDULE JUSTIFICATION:**

Study:	<input type="text"/>	<input type="text"/>
Design/Acquisition:	<input type="text"/>	<input type="text"/>
Construction:	<input type="text"/>	<input type="text"/>

Rev	Revenue Source Name	Prior Years	Funding (in thousands) *							Beyond FY15	Total
			FY10	FY11	FY12	FY13	FY14	FY15			
2721	OPERATING TRANSFER FROM 0021	\$0	\$100	\$0	\$0	\$0	\$0	\$0	\$0	\$0	\$100
		\$0	\$100	\$0	\$0	\$0	\$0	\$0	\$0	\$0	\$100

**PROJECT NAME: Central Campus Transit Center**

**PROJECT ID:** TR-OT-10-01  
**PROJECT TYPE:** New Construction  
**SUBMITTED BY:** PUBLIC SERVICES  
 SYSTEM PLANNING

**PLANNING AREA:** Central  
**PRIORITY:** Desirable  
**TOTAL COST:** \$1,900,000  
**YEARS IN CIP:**

**IDENTIFIED NEED:**

Improved bus and pedestrian access to existing transit center serving Central Campus

**SCOPE ITEMS:**

To be coordinated with North University resurfacing project

**LOCATION MAP:**



**PROJECT JUSTIFICATION:**

Value indicates the degree to which the project will impact the below items:

-1 = Negative Impact; 0 = No Impact; 1 = Minimal Positive Impact;  
 2 = Some Positive Impact; 3 = Positive Impact; 4 = High Positive Impact

- 2 Protects health, safety, lives of citizens
- 0 Meets new, or maintains existing, regulatory compliance
- 0 Provides a net savings in operations and/or maintenance costs
- 3 Enhances social, cultural, recreational or aesthetic opportunities
- 3 Improves customer service, convenience for citizens
- 0 Maintains or improves existing infrastructure, facilities [Expansion = (-1)]
- 4 Reduces energy consumption, impacts on the environment

0 **TOTAL SCORE**

**BENEFICIAL IMPACTS:**

**MASTER PLAN REFERENCE:**

**STUDY REFERENCE:**

**POLICY/OTHER REFERENCE:** UM Initiated

**SCHEDULE:**

	Start	End
Study:		
Design/Acquisition:		
Construction:	5/1/2011	8/31/2011

**SCHEDULE JUSTIFICATION:**

Request from UM

Rev	Revenue Source Name	Prior Years	Funding (in thousands) *							Beyond FY15	Total
			FY10	FY11	FY12	FY13	FY14	FY15			
6988	DEVELOPER CONTRIBUTIONS	\$0	\$0	\$0	\$1,900	\$0	\$0	\$0	\$0	\$0	\$1,900
		\$0	\$0	\$0	\$1,900	\$0	\$0	\$0	\$0	\$0	\$1,900

**PROJECT NAME: Citywide Transportation Plan Update**

**PROJECT ID:** TR-OT-01-01  
**PROJECT TYPE:** Study  
**SUBMITTED BY:** PUBLIC SERVICES  
 SYSTEM PLANNING

**PLANNING AREA:** City-wide  
**PRIORITY:** Important  
**TOTAL COST:** \$394,375  
**YEARS IN CIP:** 7

**IDENTIFIED NEED:**

**LOCATION MAP:**

**SCOPE ITEMS:**

**PROJECT JUSTIFICATION:**

Value indicates the degree to which the project will impact the below items:

-1 = Negative Impact; 0 = No Impact; 1 = Minimal Positive Impact;  
 2 = Some Positive Impact; 3 = Positive Impact; 4 = High Positive Impact

- 2 Protects health, safety, lives of citizens
- 2 Meets new, or maintains existing, regulatory compliance
- 2 Provides a net savings in operations and/or maintenance costs
- 2 Enhances social, cultural, recreational or aesthetic opportunities
- 3 Improves customer service, convenience for citizens
- 2 Maintains or improves existing infrastructure, facilities [Expansion = (-1)]
- 2 Reduces energy consumption, impacts on the environment

**15 TOTAL SCORE**

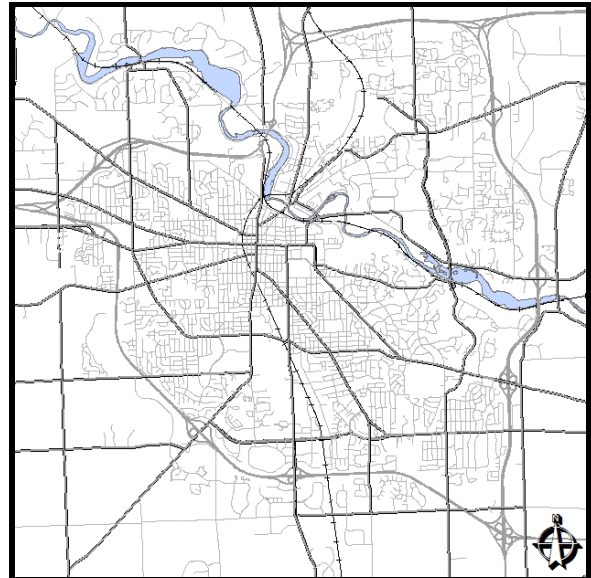

**BENEFICIAL IMPACTS:**

Update will take into account community values towards zoning, land use, multimodal transportation.

**MASTER PLAN REFERENCE:** 2004-2006 Transportation Improvement Program for Washtenaw County (2001)  
 2030 Long Range Transportation Plan Update for Washtenaw County (2004)

**STUDY REFERENCE:  
 POLICY/OTHER REFERENCE:**

**SCHEDULE:**

	Start	End
Study:	12/1/2006	12/1/2008
Design/Acquisition:		
Construction:		

**SCHEDULE JUSTIFICATION:**

Consultant selection is being combined with AATA who is performing two studies using similar data. AATA's first study will be completed spring 2005 so to maintain momentum of efforts, this project should start shortly thereafter.

Rev	Revenue Source Name	Prior Years	Funding (in thousands) *							Total
			FY10	FY11	FY12	FY13	FY14	FY15	Beyond FY15	
6988	DEVELOPER CONTRIBUTIONS	\$20	\$0	\$0	\$0	\$0	\$0	\$0	\$0	\$20
2721	OPERATING TRANSFER FROM 0021	\$14	\$0	\$0	\$0	\$0	\$0	\$0	\$0	\$14
6998	PRIOR YEAR FUND BALANCE	\$360	\$0	\$0	\$0	\$0	\$0	\$0	\$0	\$360
		\$394	\$0	\$0	\$0	\$0	\$0	\$0	\$0	\$394

**PROJECT NAME: Devonshire Drive Retaining Wall**

**PROJECT ID:** TR-OT-10-13  
**PROJECT TYPE:** Capital Maintenance  
**SUBMITTED BY:** PUBLIC SERVICES  
 FIELD OPERATIONS

**PLANNING AREA:** Northeast  
**PRIORITY:** Desirable  
**TOTAL COST:** \$50,000  
**YEARS IN CIP:**

**IDENTIFIED NEED:**

**SCOPE ITEMS:**

Smaller issue compared to other retaining walls in plan, could be done with others or wait

**PROJECT JUSTIFICATION:**

Value indicates the degree to which the project will impact the below items:

-1 = Negative Impact; 0 = No Impact; 1 = Minimal Positive Impact;  
 2 = Some Positive Impact; 3 = Positive Impact; 4 = High Positive Impact

- Protects health, safety, lives of citizens
- Meets new, or maintains existing, regulatory compliance
- Provides a net savings in operations and/or maintenance costs
- Enhances social, cultural, recreational or aesthetic opportunities
- Improves customer service, convenience for citizens
- Maintains or improves existing infrastructure, facilities [Expansion = (-1)]
- Reduces energy consumption, impacts on the environment
- TOTAL SCORE**

**LOCATION MAP:**



**BENEFICIAL IMPACTS:**

**MASTER PLAN REFERENCE:**

**STUDY REFERENCE:**  
**POLICY/OTHER REFERENCE:**

**SCHEDULE:**

	Start	End
Study:		
Design/Acquisition:		
Construction:		

**SCHEDULE JUSTIFICATION:**

Rev	Revenue Source Name	Prior Years	Funding (in thousands) *							Beyond FY15	Total
			FY10	FY11	FY12	FY13	FY14	FY15			
2721	OPERATING TRANSFER FROM 0021	\$0	\$0	\$0	\$0	\$0	\$50	\$0	\$0	\$50	
		\$0	\$0	\$0	\$0	\$0	\$50	\$0	\$0	\$50	

**PROJECT NAME: Dhu Varren/Nixon Road Intersection Water Encroachment**

**PROJECT ID:** TR-OT-10-03

**PLANNING AREA:** Northeast

**PROJECT TYPE:** Capital Maintenance

**PRIORITY:** Important

**SUBMITTED BY:** PUBLIC SERVICES

**TOTAL COST:** \$75,000

FIELD OPERATIONS

**YEARS IN CIP:**

**IDENTIFIED NEED:**

Water is further encroaching and eroding the road shoulder

**SCOPE ITEMS:**

Open water, permitting issues to be examined; shoulder on north side is gone; Future intersection realignment; Perhaps deal with issue in short term as maintenance issue;

**PROJECT JUSTIFICATION:**

Value indicates the degree to which the project will impact the below items:

-1 = Negative Impact; 0 = No Impact; 1 = Minimal Positive Impact;  
2 = Some Positive Impact; 3 = Positive Impact; 4 = High Positive Impact

- 3 Protects health, safety, lives of citizens
- 1 Meets new, or maintains existing, regulatory compliance
- 1 Provides a net savings in operations and/or maintenance costs
- 2 Enhances social, cultural, recreational or aesthetic opportunities
- 2 Improves customer service, convenience for citizens
- 3 Maintains or improves existing infrastructure, facilities [Expansion = (-1)]
- 4 Reduces energy consumption, impacts on the environment

0 **TOTAL SCORE**

**BENEFICIAL IMPACTS:**

**LOCATION MAP:**



**MASTER PLAN REFERENCE:**

**STUDY REFERENCE:**

**POLICY/OTHER REFERENCE:**

**SCHEDULE:**

**Start**                      **End**

**SCHEDULE JUSTIFICATION:**

Study:		
Design/Acquisition:	9/1/2010	4/1/2011
Construction:	5/1/2011	7/1/2011

Rev	Revenue Source Name	Prior Years	Funding (in thousands) *							Beyond FY15	Total
			FY10	FY11	FY12	FY13	FY14	FY15			
2721	OPERATING TRANSFER FROM 0021	\$0	\$0	\$75	\$0	\$0	\$0	\$0	\$0	\$0	\$75
		\$0	\$0	\$75	\$0	\$0	\$0	\$0	\$0	\$0	\$75



**PROJECT NAME: First and Ashley Streets SCOOT expansion**

**PROJECT ID:** TR-OT-08-04  
**PROJECT TYPE:** New Construction  
**SUBMITTED BY:** PUBLIC SERVICES  
 PROJECT MANAGEMENT

**PLANNING AREA:** Central  
**PRIORITY:** Important  
**TOTAL COST:** \$255,872  
**YEARS IN CIP:** 0

**IDENTIFIED NEED:**

**LOCATION MAP:**

**SCOPE ITEMS:**

**PROJECT JUSTIFICATION:**

Value indicates the degree to which the project will impact the below items:

-1 = Negative Impact; 0 = No Impact; 1 = Minimal Positive Impact;  
 2 = Some Positive Impact; 3 = Positive Impact; 4 = High Positive Impact

- 3 Protects health, safety, lives of citizens
- 0 Meets new, or maintains existing, regulatory compliance
- 3 Provides a net savings in operations and/or maintenance costs
- 1 Enhances social, cultural, recreational or aesthetic opportunities
- 3 Improves customer service, convenience for citizens
- 3 Maintains or improves existing infrastructure, facilities [Expansion = (-1)]
- 4 Reduces energy consumption, impacts on the environment

**17 TOTAL SCORE**

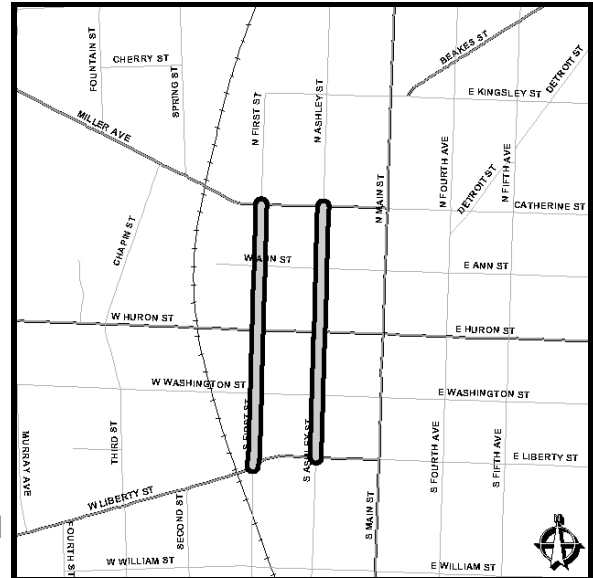

**BENEFICIAL IMPACTS:**

Reduction of delays and air pollution, increased reliability.

**MASTER PLAN REFERENCE:** 2002-2004 Transportation Improvement Program for Washtenaw County (2001)  
 2025 Long Range Transportation Plan Update for Washtenaw County (2000)

**STUDY REFERENCE:**  
**POLICY/OTHER REFERENCE:**

**SCHEDULE:**

	Start	End
Study:		
Design/Acquisition:	1/1/2007	3/1/2008
Construction:	5/1/2009	12/1/2009

**SCHEDULE JUSTIFICATION:**

The schedule is based on requirements for the federal funding for this project.

Rev	Revenue Source Name	Prior Years	Funding (in thousands) *							Beyond FY15	Total
			FY10	FY11	FY12	FY13	FY14	FY15			
2299	MDOT/OTHER GRANTS	\$217	\$0	\$0	\$0	\$0	\$0	\$0	\$0	\$0	\$217
6998	PRIOR YEAR FUND BALANCE	\$39	\$0	\$0	\$0	\$0	\$0	\$0	\$0	\$0	\$39
		\$256	\$0	\$0	\$0	\$0	\$0	\$0	\$0	\$0	\$256

**PROJECT NAME: Fuller/Geddes SCOOT expansion and Interconnect (Glen to US-23)**

**PROJECT ID:** TR-OT-02-10  
**PROJECT TYPE:** New Construction  
**SUBMITTED BY:** PUBLIC SERVICES  
 PROJECT MANAGEMENT

**PLANNING AREA:** Northeast  
**PRIORITY:** Desirable  
**TOTAL COST:** \$861,000  
**YEARS IN CIP:** 6

**IDENTIFIED NEED:**

**LOCATION MAP:**

**SCOPE ITEMS:**

**PROJECT JUSTIFICATION:**

Value indicates the degree to which the project will impact the below items:

-1 = Negative Impact; 0 = No Impact; 1 = Minimal Positive Impact;  
 2 = Some Positive Impact; 3 = Positive Impact; 4 = High Positive Impact

- 3 Protects health, safety, lives of citizens
- 0 Meets new, or maintains existing, regulatory compliance
- 3 Provides a net savings in operations and/or maintenance costs
- 1 Enhances social, cultural, recreational or aesthetic opportunities
- 3 Improves customer service, convenience for citizens
- 3 Maintains or improves existing infrastructure, facilities [Expansion = (-1)]
- 4 Reduces energy consumption, impacts on the environment

**17 TOTAL SCORE**

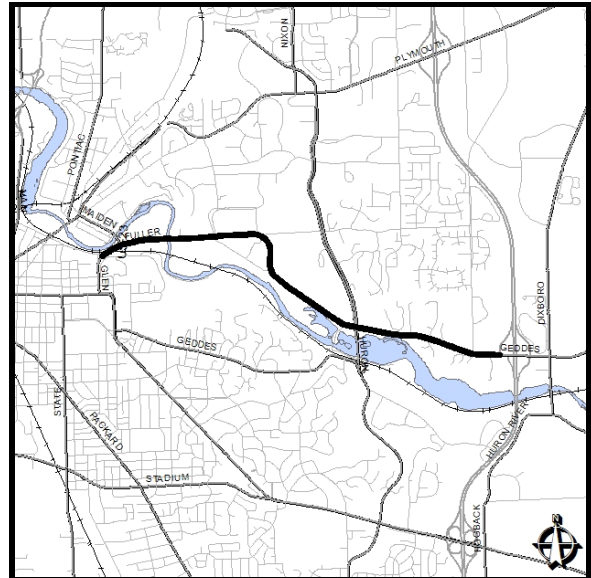

**BENEFICIAL IMPACTS:**

Coordination of US-23 signals with Earhart will reduce delay and air pollution. Signals are closely spaced. Coordination is critical for optimal operation of the system.

**MASTER PLAN REFERENCE:** 2025 Long Range Transportation Plan Update for Washtenaw County (2000)

**STUDY REFERENCE:**

**POLICY/OTHER REFERENCE:**

**SCHEDULE:**

	Start	End
Study:		
Design/Acquisition:	7/1/2007	12/1/2007
Construction:	3/1/2010	10/1/2010

**SCHEDULE JUSTIFICATION:**

Rev	Revenue Source Name	Prior Years	Funding (in thousands) *							Beyond FY15	Total
			FY10	FY11	FY12	FY13	FY14	FY15			
2299	MDOT/OTHER GRANTS	\$0	\$711	\$0	\$0	\$0	\$0	\$0	\$0	\$0	\$711
6998	PRIOR YEAR FUND BALANCE	\$0	\$150	\$0	\$0	\$0	\$0	\$0	\$0	\$0	\$150
		\$0	\$861	\$0	\$0	\$0	\$0	\$0	\$0	\$0	\$861

**PROJECT NAME: Geddes Avenue Sloughing Correction**

**PROJECT ID:** TR-OT-10-04  
**PROJECT TYPE:** Capital Maintenance  
**SUBMITTED BY:** PUBLIC SERVICES  
 FIELD OPERATIONS

**PLANNING AREA:** Northeast  
**PRIORITY:** Urgent  
**TOTAL COST:** \$850,000  
**YEARS IN CIP:**

**IDENTIFIED NEED:**

North side of the road is eroding/sloughing into RR ROW, and shoulder/lost is disappearing

**SCOPE ITEMS:**

RR permitting, review, approval and involvement; Parks involvement relative to Gallup Park; Coordinate with other items in corridor;

**LOCATION MAP:**

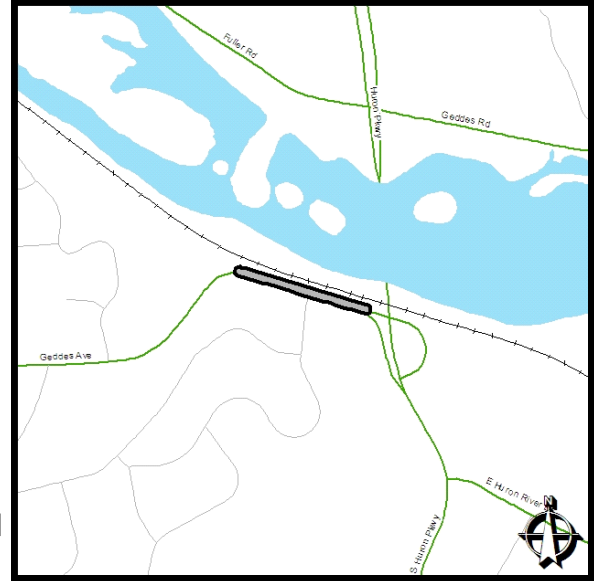

**PROJECT JUSTIFICATION:**

Value indicates the degree to which the project will impact the below items:

-1 = Negative Impact; 0 = No Impact; 1 = Minimal Positive Impact;  
 2 = Some Positive Impact; 3 = Positive Impact; 4 = High Positive Impact

- 4 Protects health, safety, lives of citizens
- 1 Meets new, or maintains existing, regulatory compliance
- 3 Provides a net savings in operations and/or maintenance costs
- 2 Enhances social, cultural, recreational or aesthetic opportunities
- 1 Improves customer service, convenience for citizens
- 3 Maintains or improves existing infrastructure, facilities [Expansion = (-1)]
- 3 Reduces energy consumption, impacts on the environment
- 0 **TOTAL SCORE**

**BENEFICIAL IMPACTS:**

**MASTER PLAN REFERENCE:**

**STUDY REFERENCE:  
 POLICY/OTHER REFERENCE:**

**SCHEDULE: Start End SCHEDULE JUSTIFICATION:**

Study:		
Design/Acquisition:		
Construction:		

Rev	Revenue Source Name	Prior Years	Funding (in thousands) *							Beyond FY15	Total
			FY10	FY11	FY12	FY13	FY14	FY15			
2721	OPERATING TRANSFER FROM 0021	\$0	\$0	\$0	\$0	\$350	\$500	\$0	\$0	\$850	
		\$0	\$0	\$0	\$0	\$350	\$500	\$0	\$0	\$850	

**PROJECT NAME: Geddes Road Sloughing Correction**

**PROJECT ID:** TR-OT-10-05

**PROJECT TYPE:**

**SUBMITTED BY:** PUBLIC SERVICES  
FIELD OPERATIONS

**PLANNING AREA:** Northeast

**PRIORITY:** Urgent

**TOTAL COST:** \$450,000

**YEARS IN CIP:**

**IDENTIFIED NEED:**

South side of the road is eroding/sloughing into river at Millers Creek Outlet, and shoulder/lost is disappearing

**SCOPE ITEMS:**

At Millers Creek Outlet under Geddes; Coordinate with other items in corridor; Road condition declining - 2 overlays have been done; Need slope stabilization - - guardrail must be addressed;

**LOCATION MAP:**

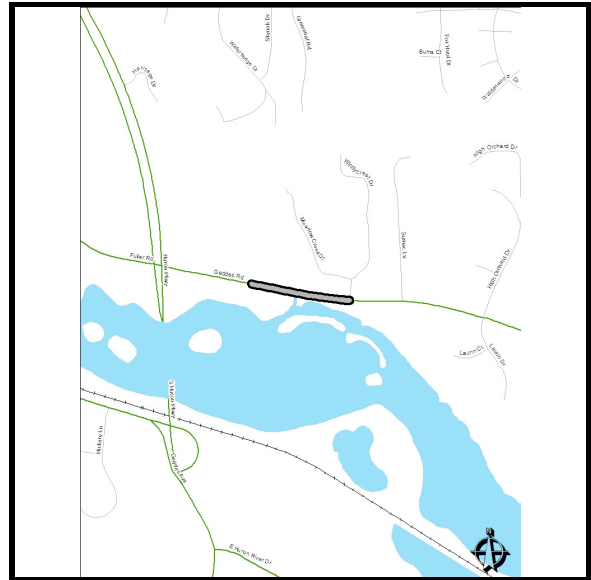

**PROJECT JUSTIFICATION:**

Value indicates the degree to which the project will impact the below items:

-1 = Negative Impact; 0 = No Impact; 1 = Minimal Positive Impact;  
2 = Some Positive Impact; 3 = Positive Impact; 4 = High Positive Impact

- Protects health, safety, lives of citizens
- Meets new, or maintains existing, regulatory compliance
- Provides a net savings in operations and/or maintenance costs
- Enhances social, cultural, recreational or aesthetic opportunities
- Improves customer service, convenience for citizens
- Maintains or improves existing infrastructure, facilities [Expansion = (-1)]
- Reduces energy consumption, impacts on the environment
- TOTAL SCORE**

**BENEFICIAL IMPACTS:**

**MASTER PLAN REFERENCE:**

**STUDY REFERENCE:  
POLICY/OTHER REFERENCE:**

**SCHEDULE:**

**Start                      End**

**SCHEDULE JUSTIFICATION:**

Study:	<input type="text"/>	<input type="text"/>
Design/Acquisition:	<input type="text"/>	<input type="text"/>
Construction:	<input type="text"/>	<input type="text"/>

Rev	Revenue Source Name	Prior Years	Funding (in thousands) *							Beyond FY15	Total
			FY10	FY11	FY12	FY13	FY14	FY15			
2721	OPERATING TRANSFER FROM 0021	\$0	\$0	\$150	\$300	\$0	\$0	\$0	\$0	\$450	
		\$0	\$0	\$150	\$300	\$0	\$0	\$0	\$0	\$450	

**PROJECT NAME: LED Streetlight Conversion**

**PROJECT ID:** TR-OT-08-09  
**PROJECT TYPE:** Capital Maintenance  
**SUBMITTED BY:** PUBLIC SERVICES  
 FIELD OPERATIONS

**PLANNING AREA:** City-wide  
**PRIORITY:** Urgent  
**TOTAL COST:** \$1,720,000  
**YEARS IN CIP:** 0

**IDENTIFIED NEED:**

**LOCATION MAP:**

**SCOPE ITEMS:**

**PROJECT JUSTIFICATION:**

Value indicates the degree to which the project will impact the below items:  
 -1 = Negative Impact; 0 = No Impact; 1 = Minimal Positive Impact;  
 2 = Some Positive Impact; 3 = Positive Impact; 4 = High Positive Impact

- 0 Protects health, safety, lives of citizens
  - 0 Meets new, or maintains existing, regulatory compliance
  - 4 Provides a net savings in operations and/or maintenance costs
  - 1 Enhances social, cultural, recreational or aesthetic opportunities
  - 3 Improves customer service, convenience for citizens
  - 3 Maintains or improves existing infrastructure, facilities [Expansion = (-1)]
  - 4 Reduces energy consumption, impacts on the environment
- 15 TOTAL SCORE**

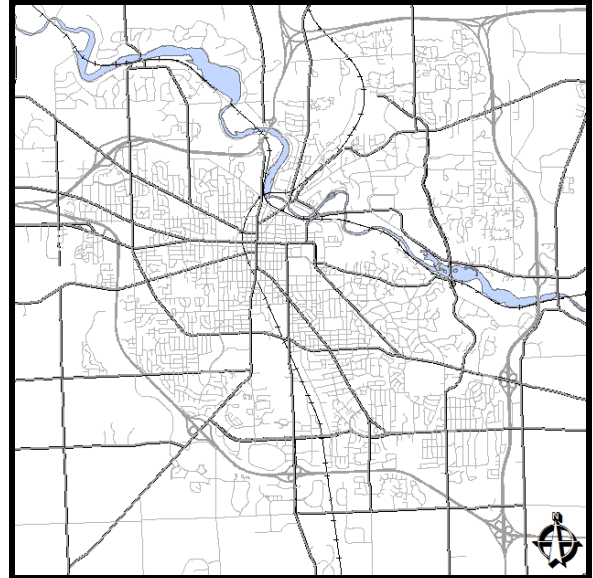

**BENEFICIAL IMPACTS:**

Reduces overall O&M costs associated with street lighting.

**MASTER PLAN REFERENCE:**

**STUDY REFERENCE:**

**POLICY/OTHER REFERENCE:** Staff Initiated

**SCHEDULE:**

	Start	End
Study:		
Design/Acquisition:		
Construction:	7/1/2008	10/1/2012

**SCHEDULE JUSTIFICATION:**

The cost savings from operating the LED fixtures will offset the capital costs to upgrade the fixtures.

Rev	Revenue Source Name	Prior Years	Funding (in thousands) *							Beyond FY15	Total
			FY10	FY11	FY12	FY13	FY14	FY15			
2710	OPERATING TRANSFER FROM 0010	\$430	\$430	\$430	\$430	\$0	\$0	\$0	\$0	\$1,720	
		\$430	\$430	\$430	\$430	\$0	\$0	\$0	\$0	\$1,720	

**PROJECT NAME: Newport Road Retaining Walls**

**PROJECT ID:** TR-OT-10-14  
**PROJECT TYPE:** Capital Maintenance  
**SUBMITTED BY:** PUBLIC SERVICES  
 FIELD OPERATIONS

**PLANNING AREA:** West  
**PRIORITY:** Desirable  
**TOTAL COST:** \$200,000  
**YEARS IN CIP:**

**IDENTIFIED NEED:**

**LOCATION MAP:**

**SCOPE ITEMS:**

Flatstone, sandstone walls; No row issues; Both sides of street; Accommodate for s/w on east side in future; Mature trees; Resident engagement; Potential for lot splits - - drive access?;

**PROJECT JUSTIFICATION:**

Value indicates the degree to which the project will impact the below items:

-1 = Negative Impact; 0 = No Impact; 1 = Minimal Positive Impact;  
 2 = Some Positive Impact; 3 = Positive Impact; 4 = High Positive Impact

- Protects health, safety, lives of citizens
- Meets new, or maintains existing, regulatory compliance
- Provides a net savings in operations and/or maintenance costs
- Enhances social, cultural, recreational or aesthetic opportunities
- Improves customer service, convenience for citizens
- Maintains or improves existing infrastructure, facilities [Expansion = (-1)]
- Reduces energy consumption, impacts on the environment
- TOTAL SCORE**



**BENEFICIAL IMPACTS:**

**MASTER PLAN REFERENCE:**

**STUDY REFERENCE:  
 POLICY/OTHER REFERENCE:**

**SCHEDULE: Start End SCHEDULE JUSTIFICATION:**

Study:		
Design/Acquisition:		
Construction:		

Rev	Revenue Source Name	Prior Years	Funding (in thousands) *							Beyond FY15	Total
			FY10	FY11	FY12	FY13	FY14	FY15			
2721	OPERATING TRANSFER FROM 0021	\$0	\$0	\$0	\$0	\$0	\$0	\$0	\$200	\$0	\$200
		\$0	\$0	\$0	\$0	\$0	\$0	\$0	\$200	\$0	\$200

**PROJECT NAME: Newport/Miller Signal**

**PROJECT ID:** TR-OT-10-15

**PROJECT TYPE:** New Construction

**SUBMITTED BY:** PUBLIC SERVICES

PROJECT MANAGEMENT

**PLANNING AREA:** West

**PRIORITY:** Important

**TOTAL COST:** \$90,000

**YEARS IN CIP:**

**IDENTIFIED NEED:**

**SCOPE ITEMS:**

Hasn't yet met volume warrants; Interest/ concern raised due to new high school; Sight distance - - outbound Miller traffic;

**PROJECT JUSTIFICATION:**

Value indicates the degree to which the project will impact the below items:

-1 = Negative Impact; 0 = No Impact; 1 = Minimal Positive Impact;

2 = Some Positive Impact; 3 = Positive Impact; 4 = High Positive Impact

- Protects health, safety, lives of citizens
- Meets new, or maintains existing, regulatory compliance
- Provides a net savings in operations and/or maintenance costs
- Enhances social, cultural, recreational or aesthetic opportunities
- Improves customer service, convenience for citizens
- Maintains or improves existing infrastructure, facilities [Expansion = (-1)]
- Reduces energy consumption, impacts on the environment
- TOTAL SCORE**

**LOCATION MAP:**



**BENEFICIAL IMPACTS:**

**MASTER PLAN REFERENCE:**

**STUDY REFERENCE:**

**POLICY/OTHER REFERENCE:**

**SCHEDULE:**

**Start**

**End**

**SCHEDULE JUSTIFICATION:**

Study:	<input type="text"/>	<input type="text"/>
Design/Acquisition:	<input type="text"/>	<input type="text"/>
Construction:	<input type="text"/>	<input type="text"/>

Rev	Revenue Source Name	Prior Years	Funding (in thousands) *							Beyond FY15	Total
			FY10	FY11	FY12	FY13	FY14	FY15			
6998	PRIOR YEAR FUND BALANCE	\$0	\$0	\$0	\$0	\$90	\$0	\$0	\$0	\$90	
		\$0	\$0	\$0	\$0	\$90	\$0	\$0	\$0	\$90	

**PROJECT NAME: Nixon Road Study**

**PROJECT ID:** TR-OT-04-04

**PROJECT TYPE:** Study

**SUBMITTED BY:** PUBLIC SERVICES  
SYSTEM PLANNING

**PLANNING AREA:** Northeast

**PRIORITY:** Desirable

**TOTAL COST:** \$200,000

**YEARS IN CIP:** 4

**IDENTIFIED NEED:**

**SCOPE ITEMS:**

Anticipated to be included in Transportation Plan Update to be further studied;

**PROJECT JUSTIFICATION:**

Value indicates the degree to which the project will impact the below items:

-1 = Negative Impact; 0 = No Impact; 1 = Minimal Positive Impact;  
2 = Some Positive Impact; 3 = Positive Impact; 4 = High Positive Impact

- 3 Protects health, safety, lives of citizens
- 0 Meets new, or maintains existing, regulatory compliance
- 1 Provides a net savings in operations and/or maintenance costs
- 3 Enhances social, cultural, recreational or aesthetic opportunities
- 3 Improves customer service, convenience for citizens
- 0 Maintains or improves existing infrastructure, facilities [Expansion = (-1)]
- 1 Reduces energy consumption, impacts on the environment

**11 TOTAL SCORE**

**LOCATION MAP:**

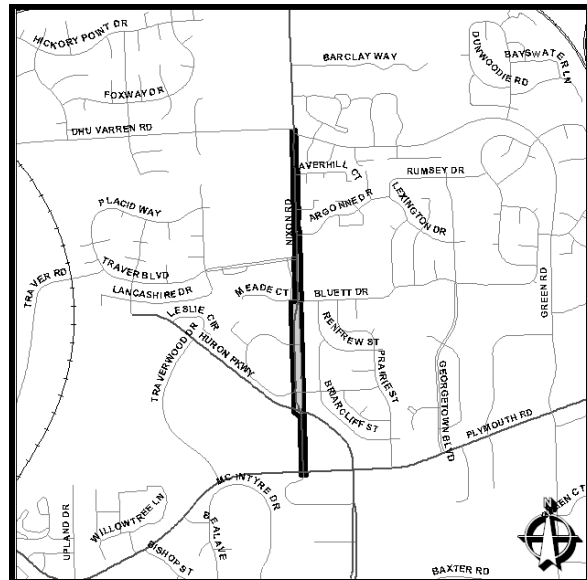

**BENEFICIAL IMPACTS:**

By studying this varied portion of the city's street system, relative to land use and transportation in the area, an improved and more efficient transportation system will result.

**MASTER PLAN REFERENCE:** 2025 Long Range Transportation Plan Update for Washtenaw County (2000)

**STUDY REFERENCE:**

**POLICY/OTHER REFERENCE:**

**SCHEDULE:**

	Start	End
Study:	10/1/2011	12/1/2012
Design/Acquisition:		
Construction:		

**SCHEDULE JUSTIFICATION:**

The Citywide Transportation Plan Update (Project TR-OT-01-01) must be completed to guide the refined prioritization and scheduling of this study.

Rev	Revenue Source Name	Prior Years	Funding (in thousands) *							Beyond FY15	Total
			FY10	FY11	FY12	FY13	FY14	FY15			
2710	OPERATING TRANSFER FROM 0010	\$0	\$0	\$0	\$200	\$0	\$0	\$0	\$0	\$0	\$200
		\$0	\$0	\$0	\$200	\$0	\$0	\$0	\$0	\$0	\$200

**PROJECT NAME: Packard Road Signal Interconnect**

**PROJECT ID:** TR-OT-01-06  
**PROJECT TYPE:** New Construction  
**SUBMITTED BY:** PUBLIC SERVICES  
 PROJECT MANAGEMENT

**PLANNING AREA:** South  
**PRIORITY:** Important  
**TOTAL COST:** \$360,000  
**YEARS IN CIP:** 7

**IDENTIFIED NEED:**

**LOCATION MAP:**

**SCOPE ITEMS:**

Additional phase of SCOOT?;

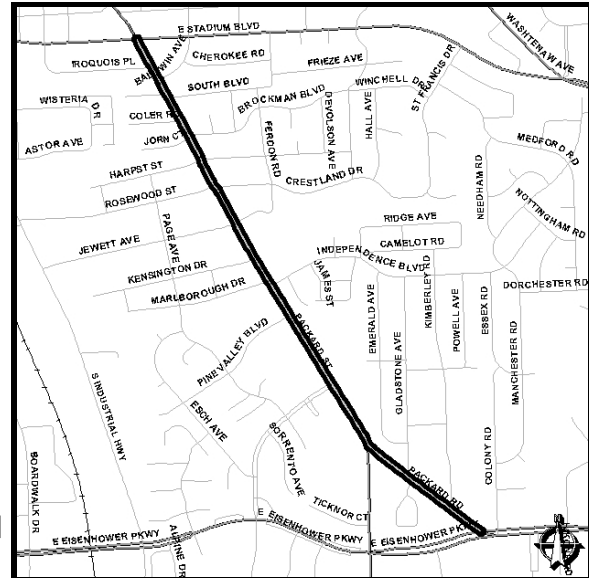

**PROJECT JUSTIFICATION:**

Value indicates the degree to which the project will impact the below items:

-1 = Negative Impact; 0 = No Impact; 1 = Minimal Positive Impact;  
 2 = Some Positive Impact; 3 = Positive Impact; 4 = High Positive Impact

- 3 Protects health, safety, lives of citizens
- 0 Meets new, or maintains existing, regulatory compliance
- 3 Provides a net savings in operations and/or maintenance costs
- 1 Enhances social, cultural, recreational or aesthetic opportunities
- 3 Improves customer service, convenience for citizens
- 3 Maintains or improves existing infrastructure, facilities [Expansion = (-1)]
- 4 Reduces energy consumption, impacts on the environment

**17 TOTAL SCORE**

**BENEFICIAL IMPACTS:**

Reduction of delays and air pollution, increased reliability.

**MASTER PLAN REFERENCE:** 2002-2004 Transportation Improvement Program for Washtenaw County (2001)  
 2025 Long Range Transportation Plan Update for Washtenaw County (2000)

**STUDY REFERENCE:**

**POLICY/OTHER REFERENCE:**

**SCHEDULE:**

	Start	End
Study:		
Design/Acquisition:	7/1/2010	10/1/2010
Construction:	4/1/2011	7/1/2011

**SCHEDULE JUSTIFICATION:**

The schedule is based on requirements for the federal funding for this project.

Rev	Revenue Source Name	Prior Years	Funding (in thousands) *							Beyond FY15	Total
			FY10	FY11	FY12	FY13	FY14	FY15			
2299	MDOT/OTHER GRANTS	\$0	\$0	\$0	\$0	\$0	\$0	\$300	\$0	\$0	\$300
2721	OPERATING TRANSFER FROM 0021	\$0	\$0	\$0	\$0	\$0	\$0	\$60	\$0	\$0	\$60
		\$0	\$0	\$0	\$0	\$0	\$0	\$360	\$0	\$0	\$360

**PROJECT NAME: Pavement Marking & Sign Systems Replacements**

**PROJECT ID:** TR-OT-10-10  
**PROJECT TYPE:** Replacement  
**SUBMITTED BY:** PUBLIC SERVICES  
 FIELD OPERATIONS

**PLANNING AREA:** Citywide  
**PRIORITY:** Urgent  
**TOTAL COST:** \$750,000  
**YEARS IN CIP:**

**IDENTIFIED NEED:**

**LOCATION MAP:**

**SCOPE ITEMS:**

Retroreflectivity must be maintained on installations - - must be inspected and documented; "Asset Management Plan needs to be in place" is a planned requirement per MMUTCD;

**PROJECT JUSTIFICATION:**

Value indicates the degree to which the project will impact the below items:

-1 = Negative Impact; 0 = No Impact; 1 = Minimal Positive Impact;  
 2 = Some Positive Impact; 3 = Positive Impact; 4 = High Positive Impact

- Protects health, safety, lives of citizens
- Meets new, or maintains existing, regulatory compliance
- Provides a net savings in operations and/or maintenance costs
- Enhances social, cultural, recreational or aesthetic opportunities
- Improves customer service, convenience for citizens
- Maintains or improves existing infrastructure, facilities [Expansion = (-1)]
- Reduces energy consumption, impacts on the environment
- TOTAL SCORE**

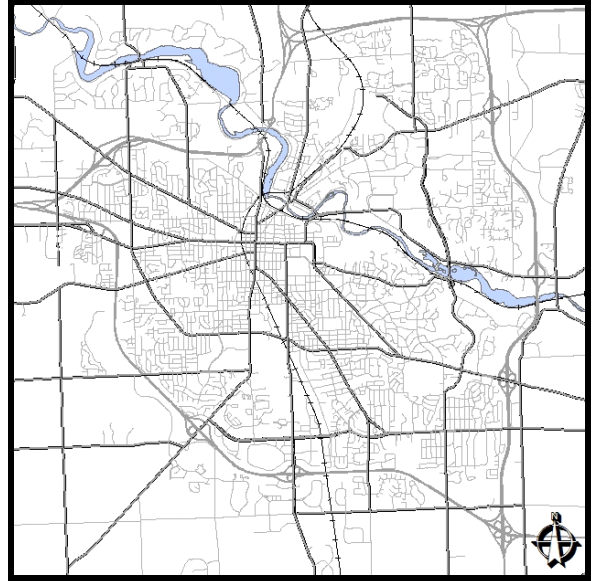

**BENEFICIAL IMPACTS:**

**MASTER PLAN REFERENCE:**

**STUDY REFERENCE:**  
**POLICY/OTHER REFERENCE:**

**SCHEDULE:**

	Start	End
Study:		
Design/Acquisition:		
Construction:		

**SCHEDULE JUSTIFICATION:**

Rev	Revenue Source Name	Prior Years	Funding (in thousands) *							Beyond FY15	Total
			FY10	FY11	FY12	FY13	FY14	FY15			
2721	OPERATING TRANSFER FROM 0021	\$0	\$0	\$150	\$150	\$150	\$150	\$150	\$150	\$0	\$750
		\$0	\$0	\$150	\$150	\$150	\$150	\$150	\$150	\$0	\$750

**PROJECT NAME: Pedestrian Signal Countdown Heads**

**PROJECT ID:** TR-OT-10-11  
**PROJECT TYPE:** Replacement  
**SUBMITTED BY:** PUBLIC SERVICES  
 FIELD OPERATIONS

**PLANNING AREA:** Citywide  
**PRIORITY:** Urgent  
**TOTAL COST:** \$637,500  
**YEARS IN CIP:**

**IDENTIFIED NEED:**

All need to be converted per MMUTCD; approximately 1200 in system;

**LOCATION MAP:**

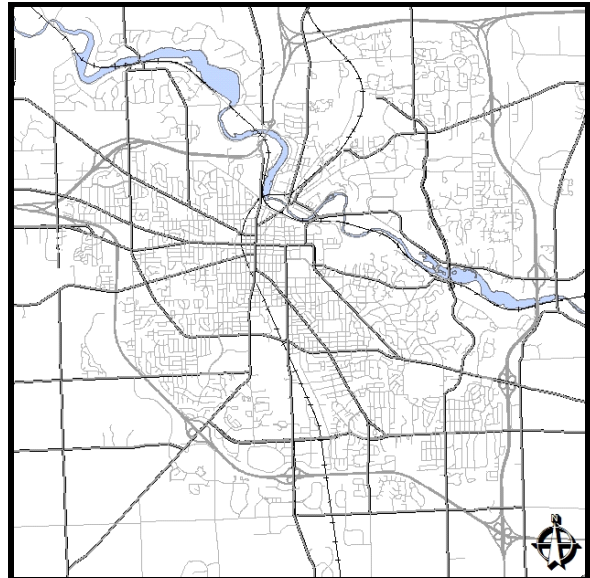

**SCOPE ITEMS:**

Coordinate w/ Accessible Ped Signals; New installs & replacements; High volume x-walks AND those over 50' long; Some ped signals may need full replacment; Plan as a programmed approach over several (5) years

**PROJECT JUSTIFICATION:**

Value indicates the degree to which the project will impact the below items:

-1 = Negative Impact; 0 = No Impact; 1 = Minimal Positive Impact;  
 2 = Some Positive Impact; 3 = Positive Impact; 4 = High Positive Impact

- Protects health, safety, lives of citizens
- Meets new, or maintains existing, regulatory compliance
- Provides a net savings in operations and/or maintenance costs
- Enhances social, cultural, recreational or aesthetic opportunities
- Improves customer service, convenience for citizens
- Maintains or improves existing infrastructure, facilities [Expansion = (-1)]
- Reduces energy consumption, impacts on the environment
- TOTAL SCORE**

**BENEFICIAL IMPACTS:**

**MASTER PLAN REFERENCE:**

**STUDY REFERENCE:  
 POLICY/OTHER REFERENCE:**

**SCHEDULE:**

**Start**                      **End**

Study:		
Design/Acquisition:		
Construction:		

**SCHEDULE JUSTIFICATION:**

Rev	Revenue Source Name	Prior Years	Funding (in thousands) *							Beyond FY15	Total
			FY10	FY11	FY12	FY13	FY14	FY15			
2721	OPERATING TRANSFER FROM 0021	\$0	\$0	\$128	\$128	\$128	\$128	\$128	\$128	\$0	\$638
		\$0	\$0	\$128	\$128	\$128	\$128	\$128	\$128	\$0	\$638

**PROJECT NAME: Plymouth Road/Commonwealth Signal**

**PROJECT ID:** TR-OT-01-07  
**PROJECT TYPE:** New Construction  
**SUBMITTED BY:** PUBLIC SERVICES  
 PROJECT MANAGEMENT

**PLANNING AREA:** Northeast  
**PRIORITY:** Desirable  
**TOTAL COST:** \$90,000  
**YEARS IN CIP:** 7

**IDENTIFIED NEED:**

Signal need anticipated with Commonwealth Park development

**LOCATION MAP:**

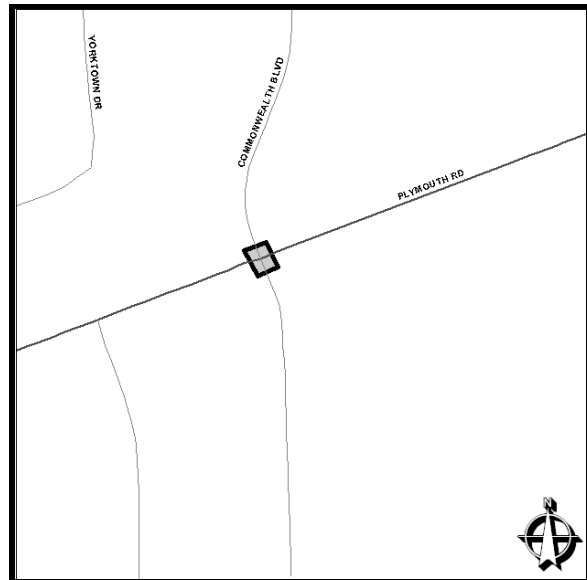

**SCOPE ITEMS:**

First Martin contributed \$10,000 as part of development; Doesn't meet warrants yet

**PROJECT JUSTIFICATION:**

Value indicates the degree to which the project will impact the below items:

-1 = Negative Impact; 0 = No Impact; 1 = Minimal Positive Impact;  
 2 = Some Positive Impact; 3 = Positive Impact; 4 = High Positive Impact

- 3 Protects health, safety, lives of citizens
- 2 Meets new, or maintains existing, regulatory compliance
- 1 Provides a net savings in operations and/or maintenance costs
- 0 Enhances social, cultural, recreational or aesthetic opportunities
- 3 Improves customer service, convenience for citizens
- 1 Maintains or improves existing infrastructure, facilities [Expansion = (-1)]
- 3 Reduces energy consumption, impacts on the environment

**9 TOTAL SCORE**

**BENEFICIAL IMPACTS:**

Reduction of delay and increased safety at this intersection.

**MASTER PLAN REFERENCE:** 2002-2004 Transportation Improvement Program for Washtenaw County (2001  
 2025 Long Range Transportation Plan Update for Washtenaw County (2000)

**STUDY REFERENCE:  
 POLICY/OTHER REFERENCE:**

**SCHEDULE:**

	Start	End
Study:		
Design/Acquisition:	10/1/2011	3/1/2012
Construction:	3/1/2012	6/1/2012

**SCHEDULE JUSTIFICATION:**

The actual traffic in the intersection needs to meet at least one signal warrant.

Rev	Revenue Source Name	Prior Years	Funding (in thousands) *							Beyond FY15	Total
			FY10	FY11	FY12	FY13	FY14	FY15			
6988	DEVELOPER CONTRIBUTIONS	\$0	\$0	\$0	\$10	\$0	\$0	\$0	\$0	\$0	\$10
6998	PRIOR YEAR FUND BALANCE	\$0	\$0	\$0	\$80	\$0	\$0	\$0	\$0	\$0	\$80
		\$0	\$0	\$0	\$90	\$0	\$0	\$0	\$0	\$0	\$90

**PROJECT NAME: S. State and Ellsworth SCOOT Expansion**

**PROJECT ID:** TR-OT-08-03  
**PROJECT TYPE:** New Construction  
**SUBMITTED BY:** PUBLIC SERVICES  
 PROJECT MANAGEMENT

**PLANNING AREA:** South  
**PRIORITY:** Important  
**TOTAL COST:** \$526,800  
**YEARS IN CIP:** 0

**IDENTIFIED NEED:**

**LOCATION MAP:**

**SCOPE ITEMS:**

**PROJECT JUSTIFICATION:**

Value indicates the degree to which the project will impact the below items:

-1 = Negative Impact; 0 = No Impact; 1 = Minimal Positive Impact;  
 2 = Some Positive Impact; 3 = Positive Impact; 4 = High Positive Impact

- 3 Protects health, safety, lives of citizens
- 0 Meets new, or maintains existing, regulatory compliance
- 3 Provides a net savings in operations and/or maintenance costs
- 1 Enhances social, cultural, recreational or aesthetic opportunities
- 3 Improves customer service, convenience for citizens
- 3 Maintains or improves existing infrastructure, facilities [Expansion = (-1)]
- 4 Reduces energy consumption, impacts on the environment

**17 TOTAL SCORE**

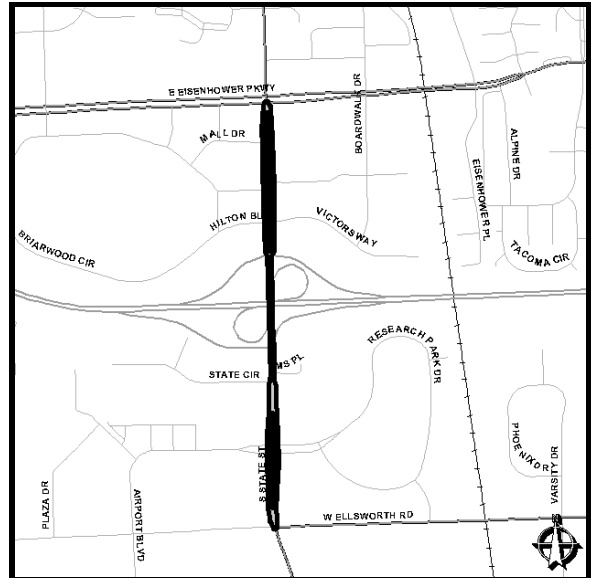

**BENEFICIAL IMPACTS:**

Reduction of delays and air pollution, increased reliability.

**MASTER PLAN REFERENCE:** 2002-2004 Transportation Improvement Program for Washtenaw County (2001)  
 2025 Long Range Transportation Plan Update for Washtenaw County (2000)

**STUDY REFERENCE:**  
**POLICY/OTHER REFERENCE:**

**SCHEDULE:**

	Start	End
Study:		
Design/Acquisition:	1/1/2007	3/1/2007
Construction:	1/1/2009	10/1/2009

**SCHEDULE JUSTIFICATION:**

The schedule is based on requirements for the federal funding for this project.

Rev	Revenue Source Name	Prior Years	Funding (in thousands) *							Beyond FY15	Total
			FY10	FY11	FY12	FY13	FY14	FY15			
2299	MDOT/OTHER GRANTS	\$479	\$0	\$0	\$0	\$0	\$0	\$0	\$0	\$0	\$479
6998	PRIOR YEAR FUND BALANCE	\$48	\$0	\$0	\$0	\$0	\$0	\$0	\$0	\$0	\$48
		\$527	\$0	\$0	\$0	\$0	\$0	\$0	\$0	\$0	\$527

**PROJECT NAME: Safety Projects**

**PROJECT ID:** TR-OT-08-02  
**PROJECT TYPE:** New Construction  
**SUBMITTED BY:** PUBLIC SERVICES  
 SYSTEM PLANNING

**PLANNING AREA:** City-wide  
**PRIORITY:** Important  
**TOTAL COST:** \$200,000  
**YEARS IN CIP:** 0

**IDENTIFIED NEED:**

Safety Grant matching funds

**SCOPE ITEMS:**

Keep for programming funds; Don't double count for any identified Safety Funding projects;

**PROJECT JUSTIFICATION:**

Value indicates the degree to which the project will impact the below items:

-1 = Negative Impact; 0 = No Impact; 1 = Minimal Positive Impact;  
 2 = Some Positive Impact; 3 = Positive Impact; 4 = High Positive Impact

- 4 Protects health, safety, lives of citizens
- 0 Meets new, or maintains existing, regulatory compliance
- 3 Provides a net savings in operations and/or maintenance costs
- 0 Enhances social, cultural, recreational or aesthetic opportunities
- 3 Improves customer service, convenience for citizens
- 0 Maintains or improves existing infrastructure, facilities [Expansion = (-1)]
- 3 Reduces energy consumption, impacts on the environment

**13 TOTAL SCORE**

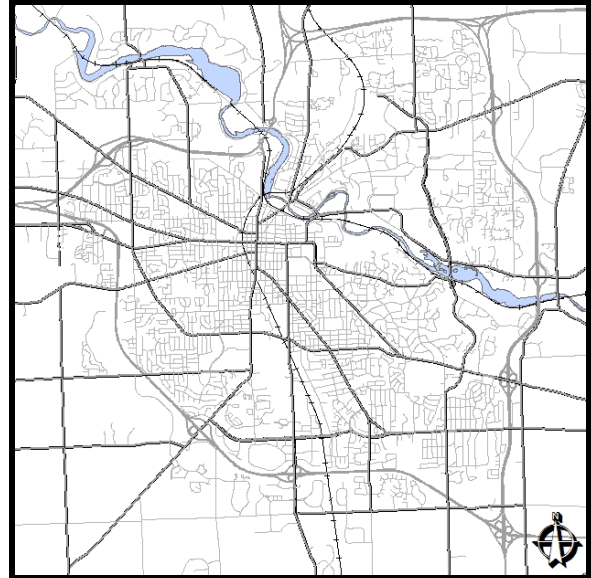
**LOCATION MAP:****BENEFICIAL IMPACTS:**

By having city grant match funding programmed, the city will be in a better position to obtain Safety Grant funds.

**MASTER PLAN REFERENCE:****STUDY REFERENCE:**

**POLICY/OTHER REFERENCE:** Staff Initiated

**SCHEDULE:**

	Start	End
Study:		
Design/Acquisition:	7/1/2009	6/30/2013
Construction:		

**SCHEDULE JUSTIFICATION:**

Rev	Revenue Source Name	Prior Years	Funding (in thousands) *							Beyond FY15	Total
			FY10	FY11	FY12	FY13	FY14	FY15			
6998	PRIOR YEAR FUND BALANCE	\$0	\$50	\$50	\$50	\$50	\$0	\$0	\$0	\$200	
		\$0	\$50	\$50	\$50	\$50	\$0	\$0	\$0	\$200	

**PROJECT NAME: Seventh Street Signal Interconnect**

**PROJECT ID:** TR-OT-01-09  
**PROJECT TYPE:** New Construction  
**SUBMITTED BY:** PUBLIC SERVICES  
 PROJECT MANAGEMENT

**PLANNING AREA:** West  
**PRIORITY:** Desirable  
**TOTAL COST:** \$600,000  
**YEARS IN CIP:** 7

**IDENTIFIED NEED:**

**LOCATION MAP:**

**SCOPE ITEMS:**

**PROJECT JUSTIFICATION:**

Value indicates the degree to which the project will impact the below items:

-1 = Negative Impact; 0 = No Impact; 1 = Minimal Positive Impact;  
 2 = Some Positive Impact; 3 = Positive Impact; 4 = High Positive Impact

- Protects health, safety, lives of citizens
- Meets new, or maintains existing, regulatory compliance
- Provides a net savings in operations and/or maintenance costs
- Enhances social, cultural, recreational or aesthetic opportunities
- Improves customer service, convenience for citizens
- Maintains or improves existing infrastructure, facilities [Expansion = (-1)]
- Reduces energy consumption, impacts on the environment

**17 TOTAL SCORE**

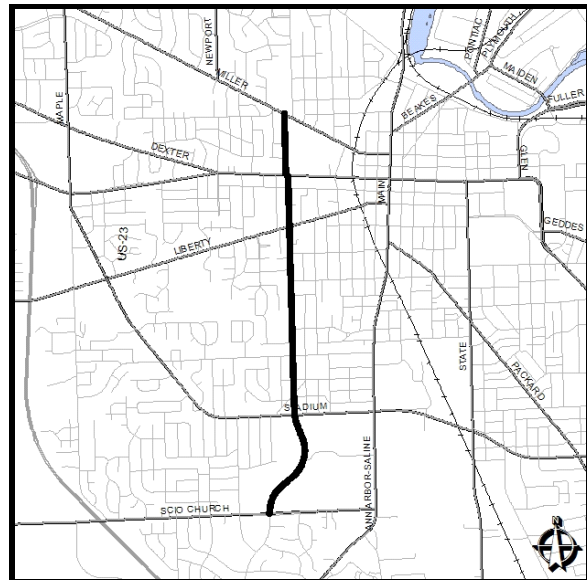

**BENEFICIAL IMPACTS:**

Reduction of delays and air pollution, increased reliability.

**MASTER PLAN REFERENCE:** 2002-2004 Transportation Improvement Program for Washtenaw County (2001)  
 2025 Long Range Transportation Plan Update for Washtenaw County (2000)

**STUDY REFERENCE:**  
**POLICY/OTHER REFERENCE:**

**SCHEDULE:**

	Start	End
Study:		
Design/Acquisition:	7/1/2011	2/1/2012
Construction:	3/1/2012	7/1/2012

**SCHEDULE JUSTIFICATION:**

The schedule is based on requirements for the federal funding for this project.

Rev	Revenue Source Name	Prior Years	Funding (in thousands) *							Beyond FY15	Total
			FY10	FY11	FY12	FY13	FY14	FY15			
2299	MDOT/OTHER GRANTS	\$0	\$0	\$0	\$500	\$0	\$0	\$0	\$0	\$0	\$500
2721	OPERATING TRANSFER FROM 0021	\$0	\$0	\$0	\$100	\$0	\$0	\$0	\$0	\$0	\$100
		\$0	\$0	\$0	\$600	\$0	\$0	\$0	\$0	\$0	\$600



**PROJECT NAME: State Street/Hilton Boulevard Intersection**

**PROJECT ID:** TR-OT-08-07  
**PROJECT TYPE:** New Construction  
**SUBMITTED BY:** PUBLIC SERVICES  
 PROJECT MANAGEMENT

**PLANNING AREA:** South  
**PRIORITY:** Important  
**TOTAL COST:** \$228,000  
**YEARS IN CIP:** 0

**IDENTIFIED NEED:**

**LOCATION MAP:**

**SCOPE ITEMS:**

**PROJECT JUSTIFICATION:**

Value indicates the degree to which the project will impact the below items:

-1 = Negative Impact; 0 = No Impact; 1 = Minimal Positive Impact;  
 2 = Some Positive Impact; 3 = Positive Impact; 4 = High Positive Impact

- 4 Protects health, safety, lives of citizens
- 2 Meets new, or maintains existing, regulatory compliance
- 1 Provides a net savings in operations and/or maintenance costs
- 1 Enhances social, cultural, recreational or aesthetic opportunities
- 3 Improves customer service, convenience for citizens
- 1 Maintains or improves existing infrastructure, facilities [Expansion = (-1)]
- 3 Reduces energy consumption, impacts on the environment

**11 TOTAL SCORE**

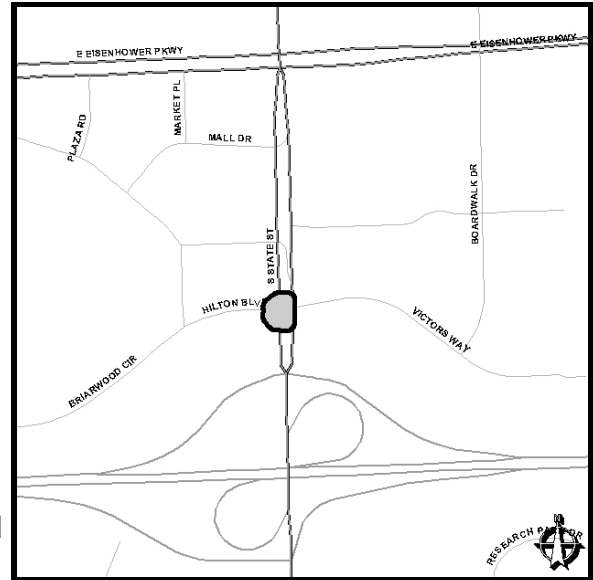

**BENEFICIAL IMPACTS:**

Increased safety and improved traffic flow reducing emissions.

**MASTER PLAN REFERENCE:**

**STUDY REFERENCE:**

**POLICY/OTHER REFERENCE:**

**SCHEDULE:**

	Start	End
Study:		
Design/Acquisition:	3/1/2007	6/30/2007
Construction:	7/1/2011	10/1/2011

**SCHEDULE JUSTIFICATION:**

Needed to utilize State Safety grant funds

Rev	Revenue Source Name	Prior Years	Funding (in thousands) *							Beyond FY15	Total
			FY10	FY11	FY12	FY13	FY14	FY15			
2299	MDOT/OTHER GRANTS	\$0	\$0	\$120	\$0	\$0	\$0	\$0	\$0	\$0	\$120
6998	PRIOR YEAR FUND BALANCE	\$14	\$0	\$94	\$0	\$0	\$0	\$0	\$0	\$0	\$108
		\$14	\$0	\$214	\$0	\$0	\$0	\$0	\$0	\$0	\$228

**PROJECT NAME: Washtenaw and Platt/Glenwood Intersection Improvements**

**PROJECT ID:** TR-OT-08-08  
**PROJECT TYPE:** New Construction  
**SUBMITTED BY:** PUBLIC SERVICES  
 SYSTEM PLANNING

**PLANNING AREA:** South  
**PRIORITY:** Important  
**TOTAL COST:** \$150,000  
**YEARS IN CIP:** 0

**IDENTIFIED NEED:**

Improved intersection required as part of proposed Arlington Shoppes development

**LOCATION MAP:**

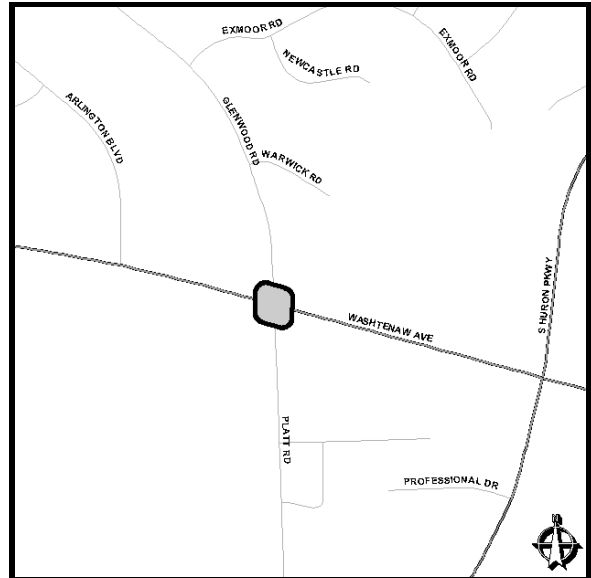

**SCOPE ITEMS:**

To be performed by Arlington Shoppes developer by site development agreement and site plan; Need to check with Planning to see if site plan is still valid or expiring;

**PROJECT JUSTIFICATION:**

Value indicates the degree to which the project will impact the below items:

-1 = Negative Impact; 0 = No Impact; 1 = Minimal Positive Impact;  
 2 = Some Positive Impact; 3 = Positive Impact; 4 = High Positive Impact

- 4 Protects health, safety, lives of citizens
- 3 Meets new, or maintains existing, regulatory compliance
- 1 Provides a net savings in operations and/or maintenance costs
- 1 Enhances social, cultural, recreational or aesthetic opportunities
- 2 Improves customer service, convenience for citizens
- 1 Maintains or improves existing infrastructure, facilities [Expansion = (-1)]
- 2 Reduces energy consumption, impacts on the environment

**10 TOTAL SCORE**

**BENEFICIAL IMPACTS:**

This project is needed to mitigate the traffic impacts at the intersection by the new Shops at Huron Village development.

**MASTER PLAN REFERENCE:**

**STUDY REFERENCE:** Shops at Huron Village Traffic Impact Study  
**POLICY/OTHER REFERENCE:**

**SCHEDULE:**

	Start	End
Study:		
Design/Acquisition:		
Construction:		

**SCHEDULE JUSTIFICATION:**

Tied to the site development.

Rev	Revenue Source Name	Prior Years	Funding (in thousands) *							Beyond FY15	Total
			FY10	FY11	FY12	FY13	FY14	FY15			
6988	DEVELOPER CONTRIBUTIONS	\$0	\$0	\$150	\$0	\$0	\$0	\$0	\$0	\$0	\$150
		\$0	\$0	\$150	\$0	\$0	\$0	\$0	\$0	\$0	\$150

**PROJECT NAME: Watershed Drive Retaining Wall**

**PROJECT ID:** TR-OT-10-12  
**PROJECT TYPE:** Replacement  
**SUBMITTED BY:** PUBLIC SERVICES  
 FIELD OPERATIONS

**PLANNING AREA:** Northeast  
**PRIORITY:** Important  
**TOTAL COST:** \$350,000  
**YEARS IN CIP:**

**IDENTIFIED NEED:**

**LOCATION MAP:**

**SCOPE ITEMS:**

Timber retaining wall, with split rail fence at top, private landscaping behind; Every 5 years, ~\$25,000 spent on repairs; Past point of repair, Can do one more short term fix, but won't last past 5 years at best; Limited ROW; cost-sharing w/ resident?

**PROJECT JUSTIFICATION:**

Value indicates the degree to which the project will impact the below items:

-1 = Negative Impact; 0 = No Impact; 1 = Minimal Positive Impact;  
 2 = Some Positive Impact; 3 = Positive Impact; 4 = High Positive Impact

- Protects health, safety, lives of citizens
- Meets new, or maintains existing, regulatory compliance
- Provides a net savings in operations and/or maintenance costs
- Enhances social, cultural, recreational or aesthetic opportunities
- Improves customer service, convenience for citizens
- Maintains or improves existing infrastructure, facilities [Expansion = (-1)]
- Reduces energy consumption, impacts on the environment
- TOTAL SCORE**

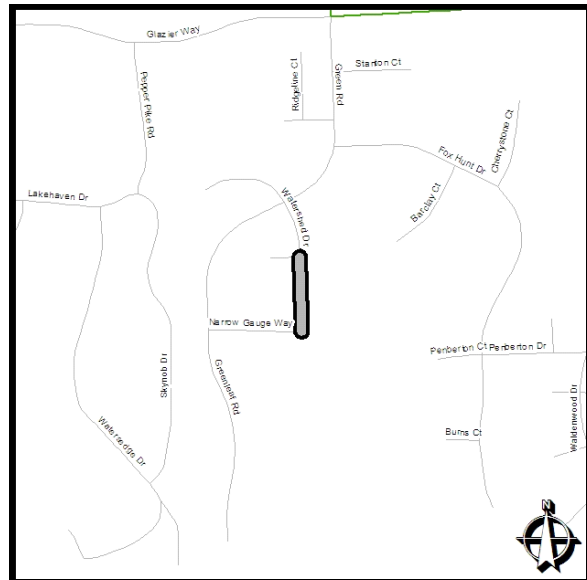

**BENEFICIAL IMPACTS:**

**MASTER PLAN REFERENCE:**

**STUDY REFERENCE:**  
**POLICY/OTHER REFERENCE:**

**SCHEDULE:**                      **Start**                      **End**                      **SCHEDULE JUSTIFICATION:**

Study:	<input type="text"/>	<input type="text"/>
Design/Acquisition:	<input type="text"/>	<input type="text"/>
Construction:	<input type="text"/>	<input type="text"/>

Rev	Revenue Source Name	Prior Years	Funding (in thousands) *							Beyond FY15	Total
			FY10	FY11	FY12	FY13	FY14	FY15			
2721	OPERATING TRANSFER FROM 0021	\$0	\$0	\$0	\$0	\$0	\$350	\$0	\$0	\$350	
		\$0	\$0	\$0	\$0	\$0	\$350	\$0	\$0	\$350	