

**City of Ann Arbor, Michigan
FY2008-2013 Capital Improvements Plan**

Transportation - Bridges

Bridges

The rehabilitation or reconstruction of bridges that carry vehicles or new bridge development

CAPITAL PROGRAM SUMMARY

The Public Services Area is responsible for 14 road bridges as well as non-motorized path bridges within the public rights-of-way. The Capital Improvements Plan provides for major rehabilitation of these structures and for new bridge construction where justified by planned development. The benefits of this bridge program are reduced maintenance costs, improved safety and improved traffic flow.

NEEDS ASSESSMENT AND EVALUATION

In accordance with Federal law, all road bridges in the City are inspected at least once every two years, and the Public Services Area rates their physical condition. The City's inspection program reviews one-half of the bridges every year. The need for rehabilitation or reconstruction of a structure is based on these condition ratings, along with the measures of traffic volume, accident rates, and coordination with other improvements in the area. Structures in greatest need of improvement are given highest priority and are programmed against available funds.

PROJECT SELECTION CRITERIA

- Structural conditions ratings (AASHTO Compliance, MDOT P2502 and Q1717A Forms)
- Traffic volumes (number of cars and trucks)
- Coordination with other improvements in the area (roads, sewer and water)
- Weight restriction (posted tons)
- FY2006-2008 Transportation Improvement Plan for Washtenaw County (2006)

TABLE OF CONTENTS FOR PROJECT SHEETS

Project Name	Project ID	Page No.
Allen Creek Greenway Bridges	TR-BR-10-08	292
Ann Arbor-Saline Road Shared Use Path Bridge	TR-BR-10-03	293
Biennial Bridge Inspection Program	TR-BR-10-01	294
East Stadium Bridge Emergency Repairs (over South State Street)	TR-BR-10-02	295
East Stadium Bridge Replacement (over AARR)	TR-BR-02-03	296
East Stadium Bridge Replacement (over South State Street)	TR-BR-02-04	297
Fuller Road/Maiden Lane/East Medical Center Drive Bridges Rehabilitation	TR-BR-10-06	298
Morehead-Delaware Pedestrian Bridge	TR-BR-10-05	299
Pedestrian Access at Interstates (Washtenaw/US-23;AA-Saline/I-94;State Street Corridor)	TR-BR-10-04	300
Traver Road Pedestrian Bridge	TR-BR-10-07	301

PROJECT NAME: Allen Creek Greenway Bridges

PROJECT ID: TR-BR-10-08
PROJECT TYPE: New Construction
SUBMITTED BY: PUBLIC SERVICES
 SYSTEM PLANNING

PLANNING AREA: Central
PRIORITY: Desirable
TOTAL COST: \$1,500,000
YEARS IN CIP:

IDENTIFIED NEED:

LOCATION MAP:

SCOPE ITEMS:

PROJECT JUSTIFICATION:

Value indicates the degree to which the project will impact the below items:

-1 = Negative Impact; 0 = No Impact; 1 = Minimal Positive Impact;
 2 = Some Positive Impact; 3 = Positive Impact; 4 = High Positive Impact

- Protects health, safety, lives of citizens
- Meets new, or maintains existing, regulatory compliance
- Provides a net savings in operations and/or maintenance costs
- Enhances social, cultural, recreational or aesthetic opportunities
- Improves customer service, convenience for citizens
- Maintains or improves existing infrastructure, facilities [Expansion = (-1)]
- Reduces energy consumption, impacts on the environment
- TOTAL SCORE**

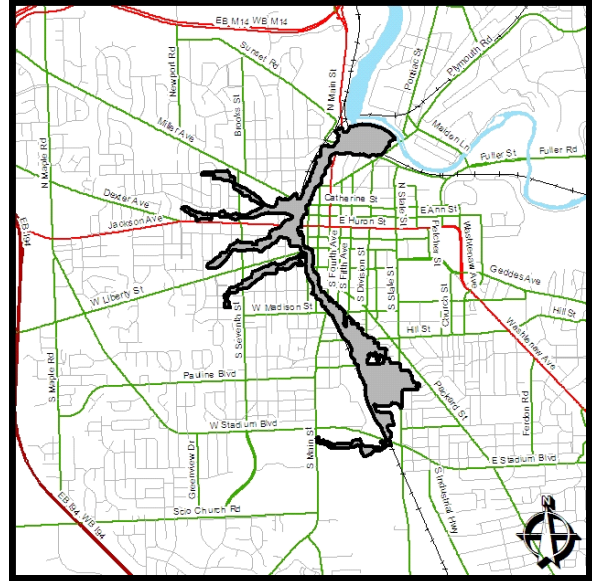

BENEFICIAL IMPACTS:

MASTER PLAN REFERENCE:

STUDY REFERENCE:
POLICY/OTHER REFERENCE:

SCHEDULE: **Start** **End** **SCHEDULE JUSTIFICATION:**

Study:		
Design/Acquisition:		
Construction:		

Rev	Revenue Source Name	Prior Years	Funding (in thousands) *							Beyond FY15	Total
			FY10	FY11	FY12	FY13	FY14	FY15			
2180	US DEPT OF TRANS - GRANT	\$0	\$0	\$0	\$0	\$0	\$0	\$0	\$1,500	\$0	\$1,500
		\$0	\$0	\$0	\$0	\$0	\$0	\$0	\$1,500	\$0	\$1,500

PROJECT NAME: Biennial Bridge Inspection Program

PROJECT ID: TR-BR-10-01
PROJECT TYPE: Study
SUBMITTED BY: PUBLIC SERVICES
 PROJECT MANAGEMENT

PLANNING AREA: Citywide
PRIORITY: Urgent
TOTAL COST: \$555,000
YEARS IN CIP:

IDENTIFIED NEED:
 Federal requirement

LOCATION MAP:

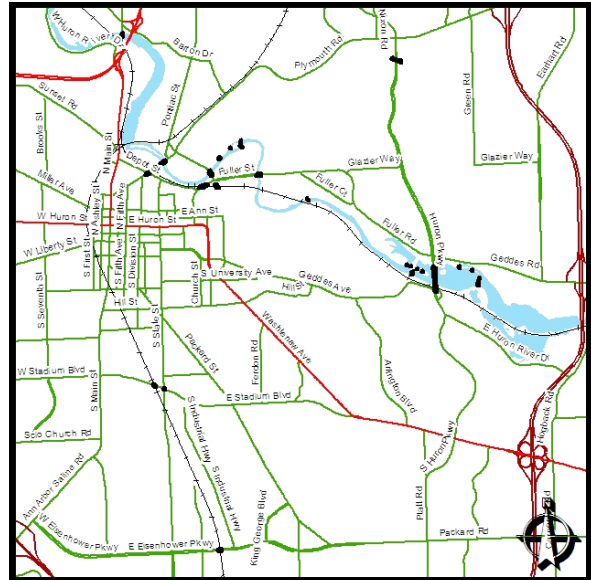

SCOPE ITEMS:

PROJECT JUSTIFICATION:

Value indicates the degree to which the project will impact the below items:

-1 = Negative Impact; 0 = No Impact; 1 = Minimal Positive Impact;
 2 = Some Positive Impact; 3 = Positive Impact; 4 = High Positive Impact

- Protects health, safety, lives of citizens
 - Meets new, or maintains existing, regulatory compliance
 - Provides a net savings in operations and/or maintenance costs
 - Enhances social, cultural, recreational or aesthetic opportunities
 - Improves customer service, convenience for citizens
 - Maintains or improves existing infrastructure, facilities [Expansion = (-1)]
 - Reduces energy consumption, impacts on the environment
- TOTAL SCORE**

BENEFICIAL IMPACTS:

MASTER PLAN REFERENCE:

STUDY REFERENCE:
POLICY/OTHER REFERENCE:

SCHEDULE: **Start** **End** **SCHEDULE JUSTIFICATION:**

Study:	<input type="text"/>	<input type="text"/>
Design/Acquisition:	<input type="text"/>	<input type="text"/>
Construction:	<input type="text"/>	<input type="text"/>

Rev	Revenue Source Name	Prior Years	Funding (in thousands) *							Beyond FY15	Total
			FY10	FY11	FY12	FY13	FY14	FY15			
2721	OPERATING TRANSFER FROM 0021	\$0	\$90	\$90	\$90	\$95	\$95	\$95	\$0	\$555	
		\$0	\$90	\$90	\$90	\$95	\$95	\$95	\$0	\$555	

PROJECT NAME: East Stadium Bridge Emergency Repairs (over South State Street)

PROJECT ID: TR-BR-10-02
PROJECT TYPE: Capital Maintenance
SUBMITTED BY: PUBLIC SERVICES
 PROJECT MANAGEMENT

PLANNING AREA: South
PRIORITY: Urgent
TOTAL COST: \$300,000
YEARS IN CIP:

IDENTIFIED NEED:

LOCATION MAP:

SCOPE ITEMS:

PROJECT JUSTIFICATION:

Value indicates the degree to which the project will impact the below items:

-1 = Negative Impact; 0 = No Impact; 1 = Minimal Positive Impact;
 2 = Some Positive Impact; 3 = Positive Impact; 4 = High Positive Impact

- Protects health, safety, lives of citizens
- Meets new, or maintains existing, regulatory compliance
- Provides a net savings in operations and/or maintenance costs
- Enhances social, cultural, recreational or aesthetic opportunities
- Improves customer service, convenience for citizens
- Maintains or improves existing infrastructure, facilities [Expansion = (-1)]
- Reduces energy consumption, impacts on the environment
- TOTAL SCORE**

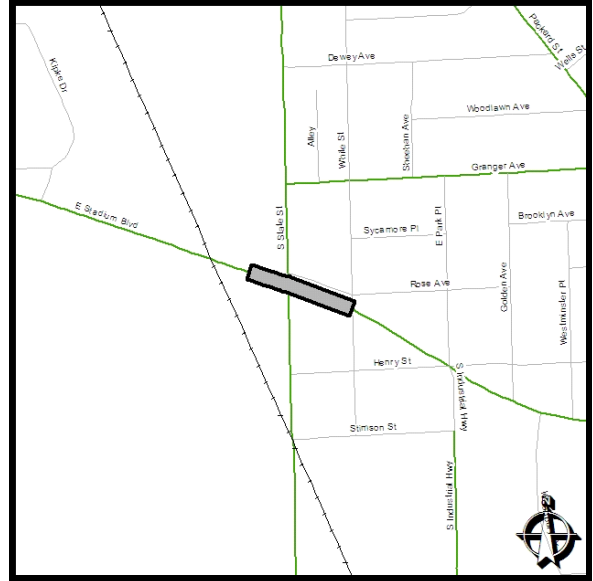

BENEFICIAL IMPACTS:

MASTER PLAN REFERENCE:

**STUDY REFERENCE:
 POLICY/OTHER REFERENCE:**

SCHEDULE: Start End SCHEDULE JUSTIFICATION:

Study:	<input type="text"/>	<input type="text"/>
Design/Acquisition:	<input type="text"/>	<input type="text"/>
Construction:	<input type="text"/>	<input type="text"/>

Rev	Revenue Source Name	Prior Years	Funding (in thousands) *							Beyond FY15	Total
			FY10	FY11	FY12	FY13	FY14	FY15			
2721	OPERATING TRANSFER FROM 0021	\$0	\$300	\$0	\$0	\$0	\$0	\$0	\$0	\$0	\$300
		\$0	\$300	\$0	\$0	\$0	\$0	\$0	\$0	\$0	\$300

PROJECT NAME: East Stadium Bridge Replacement (over South State Street)

PROJECT ID: TR-BR-02-04

PLANNING AREA: South

PROJECT TYPE: Replacement

PRIORITY: Urgent

SUBMITTED BY: PUBLIC SERVICES

TOTAL COST: \$7,960,000

SYSTEM PLANNING

YEARS IN CIP: 6

IDENTIFIED NEED:

LOCATION MAP:

SCOPE ITEMS:

PROJECT JUSTIFICATION:

Value indicates the degree to which the project will impact the below items:

-1 = Negative Impact; 0 = No Impact; 1 = Minimal Positive Impact;
2 = Some Positive Impact; 3 = Positive Impact; 4 = High Positive Impact

- 3 Protects health, safety, lives of citizens
- 2 Meets new, or maintains existing, regulatory compliance
- 1 Provides a net savings in operations and/or maintenance costs
- 4 Enhances social, cultural, recreational or aesthetic opportunities
- 2 Improves customer service, convenience for citizens
- 3 Maintains or improves existing infrastructure, facilities [Expansion = (-1)]
- 1 Reduces energy consumption, impacts on the environment

16 TOTAL SCORE

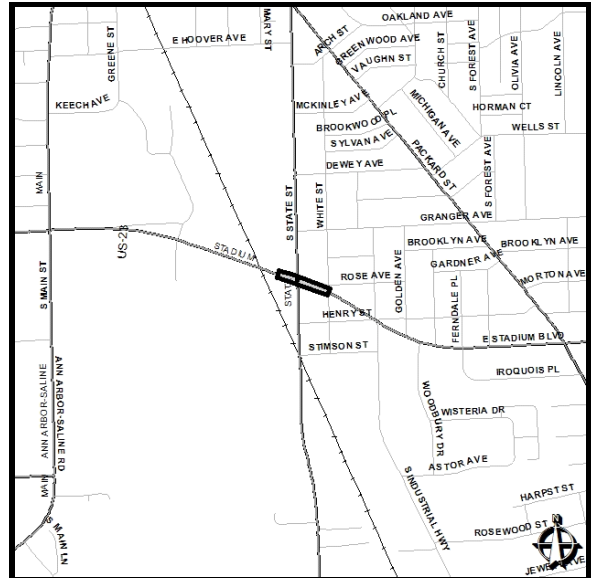

BENEFICIAL IMPACTS:

The replacement bridge will meet all applicable state and federal standards. Improvements to pedestrian traffic flow will be achieved. Project corridor aesthetics will be greatly improved.

MASTER PLAN REFERENCE: 2025 Long Range Transportation Plan Update for Washtenaw County (2000)

STUDY REFERENCE:

POLICY/OTHER REFERENCE:

SCHEDULE:

	Start	End
Study:		
Design/Acquisition:	9/19/2006	7/15/2011
Construction:	10/15/2011	2/1/2014

SCHEDULE JUSTIFICATION:

This project is included in the 2006-2010 segment of the 2025 Long Range Transportation Plan Update. The project will be a federal-aid project, coordinated with the East Stadium Reconstruction & bridge replacement over the AARR requiring lead time.

Rev	Revenue Source Name	Prior Years	Funding (in thousands) *							Beyond FY15	Total
			FY10	FY11	FY12	FY13	FY14	FY15			
2299	MDOT/OTHER GRANTS	\$0	\$0	\$0	\$2,873	\$1,000	\$0	\$0	\$0	\$3,873	
2721	OPERATING TRANSFER FROM 0021	\$0	\$0	\$500	\$2,087	\$1,000	\$0	\$0	\$0	\$3,587	
2762	OPERATING TRANSFER FROM 0062	\$0	\$500	\$0	\$0	\$0	\$0	\$0	\$0	\$500	
		\$0	\$500	\$500	\$4,960	\$2,000	\$0	\$0	\$0	\$7,960	

PROJECT NAME: Fuller Road/Maiden Lane/East Medical Center Drive Bridges Rehabilitatio

PROJECT ID: TR-BR-10-06
PROJECT TYPE: Capital Maintenance
SUBMITTED BY: PUBLIC SERVICES
 PROJECT MANAGEMENT

PLANNING AREA: Central, Northeast
PRIORITY: Urgent
TOTAL COST: \$1,217,000
YEARS IN CIP:

IDENTIFIED NEED:

LOCATION MAP:

SCOPE ITEMS:

Repaint structure; repair deck; expansion joint repair; rip-rap; etc.

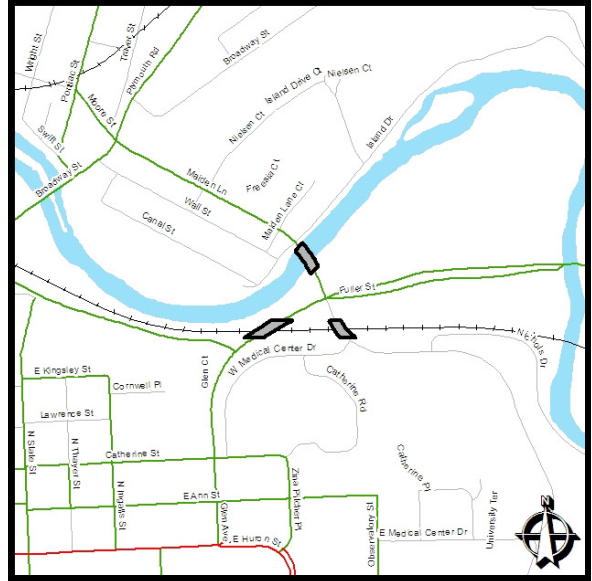

PROJECT JUSTIFICATION:

Value indicates the degree to which the project will impact the below items:

-1 = Negative Impact; 0 = No Impact; 1 = Minimal Positive Impact;
 2 = Some Positive Impact; 3 = Positive Impact; 4 = High Positive Impact

- Protects health, safety, lives of citizens
- Meets new, or maintains existing, regulatory compliance
- Provides a net savings in operations and/or maintenance costs
- Enhances social, cultural, recreational or aesthetic opportunities
- Improves customer service, convenience for citizens
- Maintains or improves existing infrastructure, facilities [Expansion = (-1)]
- Reduces energy consumption, impacts on the environment
- TOTAL SCORE**

BENEFICIAL IMPACTS:

MASTER PLAN REFERENCE:

**STUDY REFERENCE:
 POLICY/OTHER REFERENCE:**

SCHEDULE:

	Start	End
Study:		
Design/Acquisition:		
Construction:		

SCHEDULE JUSTIFICATION:

Rev	Revenue Source Name	Prior Years	Funding (in thousands) *							Beyond FY15	Total
			FY10	FY11	FY12	FY13	FY14	FY15			
2721	OPERATING TRANSFER FROM 0021	\$0	\$0	\$0	\$0	\$400	\$601	\$0	\$0	\$1,001	
2762	OPERATING TRANSFER FROM 0062	\$0	\$0	\$0	\$0	\$100	\$116	\$0	\$0	\$216	
		\$0	\$0	\$0	\$0	\$500	\$717	\$0	\$0	\$1,217	

PROJECT NAME: Morehead-Delaware Pedestrian Bridge

PROJECT ID: TR-BR-10-05
PROJECT TYPE: Capital Maintenance
SUBMITTED BY: PUBLIC SERVICES
 PROJECT MANAGEMENT

PLANNING AREA: South
PRIORITY: Desirable
TOTAL COST: \$130,000
YEARS IN CIP:

IDENTIFIED NEED:

SCOPE ITEMS:

Structure in good shape, weir supporting bridge is being undermined; need to check Non-Motorized Plan to see if designated in plan - - can stay at 10', or must be 12' ?

LOCATION MAP:



PROJECT JUSTIFICATION:

Value indicates the degree to which the project will impact the below items:

-1 = Negative Impact; 0 = No Impact; 1 = Minimal Positive Impact;
 2 = Some Positive Impact; 3 = Positive Impact; 4 = High Positive Impact

- Protects health, safety, lives of citizens
- Meets new, or maintains existing, regulatory compliance
- Provides a net savings in operations and/or maintenance costs
- Enhances social, cultural, recreational or aesthetic opportunities
- Improves customer service, convenience for citizens
- Maintains or improves existing infrastructure, facilities [Expansion = (-1)]
- Reduces energy consumption, impacts on the environment
- TOTAL SCORE**

BENEFICIAL IMPACTS:

MASTER PLAN REFERENCE:

STUDY REFERENCE:
POLICY/OTHER REFERENCE:

SCHEDULE: **Start** **End** **SCHEDULE JUSTIFICATION:**

Study:		
Design/Acquisition:		
Construction:		

Rev	Revenue Source Name	Prior Years	Funding (in thousands) *							Beyond FY15	Total
			FY10	FY11	FY12	FY13	FY14	FY15			
2710	OPERATING TRANSFER FROM 0010	\$0	\$0	\$0	\$130	\$0	\$0	\$0	\$0	\$0	\$130
		\$0	\$0	\$0	\$130	\$0	\$0	\$0	\$0	\$0	\$130

PROJECT NAME: Traver Road Pedestrian Bridge

PROJECT ID: TR-BR-10-07
PROJECT TYPE: Capital Maintenance
SUBMITTED BY: PUBLIC SERVICES
 FIELD OPERATIONS

PLANNING AREA: Northeast
PRIORITY: Desirable
TOTAL COST: \$40,000
YEARS IN CIP:

IDENTIFIED NEED:

LOCATION MAP:

SCOPE ITEMS:

PROJECT JUSTIFICATION:

Value indicates the degree to which the project will impact the below items:

-1 = Negative Impact; 0 = No Impact; 1 = Minimal Positive Impact;
 2 = Some Positive Impact; 3 = Positive Impact; 4 = High Positive Impact

- Protects health, safety, lives of citizens
- Meets new, or maintains existing, regulatory compliance
- Provides a net savings in operations and/or maintenance costs
- Enhances social, cultural, recreational or aesthetic opportunities
- Improves customer service, convenience for citizens
- Maintains or improves existing infrastructure, facilities [Expansion = (-1)]
- Reduces energy consumption, impacts on the environment
- TOTAL SCORE**

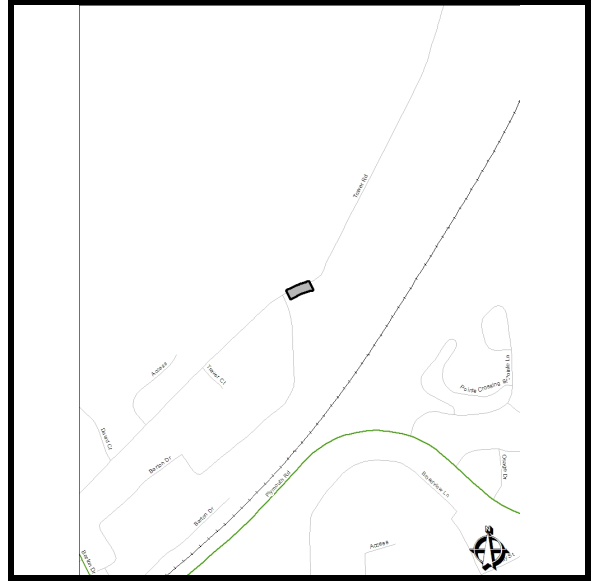

BENEFICIAL IMPACTS:

MASTER PLAN REFERENCE:

**STUDY REFERENCE:
 POLICY/OTHER REFERENCE:**

SCHEDULE:

	Start	End
Study:		
Design/Acquisition:		
Construction:		

SCHEDULE JUSTIFICATION:

Rev	Revenue Source Name	Prior Years	Funding (in thousands) *							Beyond FY15	Total
			FY10	FY11	FY12	FY13	FY14	FY15			
2721	OPERATING TRANSFER FROM 0021	\$0	\$0	\$0	\$0	\$40	\$0	\$0	\$0	\$40	
		\$0	\$0	\$0	\$0	\$40	\$0	\$0	\$0	\$40	