

Chapter 104 Fences Guidelines

City Code Chapter 104 regulates the placement and type of fences that are permitted in residential districts. The guidelines below will help interpret this difficult to understand chapter of City Code.

Typical Residential Lot

Corner Residential Lot

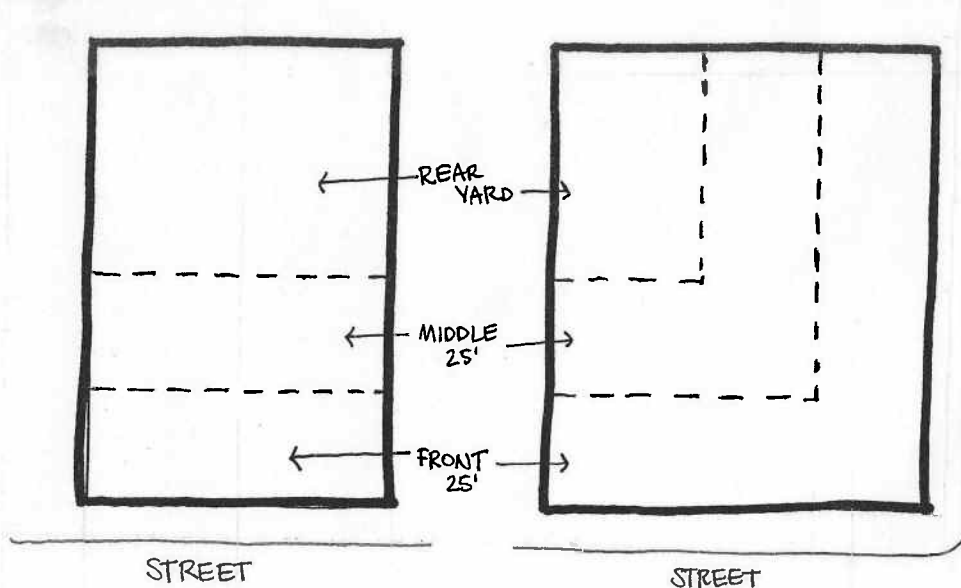

First 25 feet – any fence within this area can be up to 4 feet in height and no more than 50% opaque (i.e. must be at least 50% open, such as chain link, wrought iron or picket fencing).

Middle 25 feet – any fence within this area can be no more than 6 feet in height and no more than 80% opaque (i.e. must be at least 20% open).

Rear Yard – any fence within this area can be up to 8 feet in height and 100 % opaque (i.e. a solid fence).

Other Important Information:

- Opacity is measured "head on" or perpendicular to the fence.
- All distance measurements are taken from the lot lines.
- There is no minimum set back requirement – fences can be located on the lot line so long as the entire fence is located on your lot.
- The City cannot locate or identify the lot lines – if you do not know where your lot lines are you must have a private surveyor locate them for you.

For more information about Chapter 104 contact a city planner in the Planning & Development Services unit at 734-794-6265 or planning@a2gov.org. For information about application forms or fees contact a Permit Desk clerk at 734-794-6267 or go to www.a2gov.org/government/communityservices/planninganddevelopment to print a zoning compliance permit application.