



## PARK ADVISORY COMMISSION CALENDAR FEBRUARY- MARCH

---

February 20	PAC Meeting 4:00 PM Senior Center in Burns Park at 1320 Baldwin
March 6	LAC Meeting 4:00 PM City Council Workroom
March 20	PAC Meeting 4:00 PM City Hall Council Chambers

**PARK ADVISORY COMMISSION MEETING - TUESDAY, FEBRUARY 20, 2007**  
**4:00 P.M. – SENIOR CENTER**  
**AGENDA**

**CALL TO ORDER**

**ROLL CALL**

**APPROVAL OF AGENDA**

**PUBLIC COMMENTARY - AGENDA ITEMS (3 Minutes per Speaker)**

**A - APPROVAL OF MINUTES**

A-1 Minutes of the January 16, 2007 Regular Session

**SPECIAL PRESENTATIONS**

**B - UNFINISHED BUSINESS**

**C - NEW BUSINESS**

C-1 Off-Lease Designation in Park Areas

**D - COMMISSION PROPOSED BUSINESS**

D-1 Greenbelt Boundary Expansion Update

**E - REPORT FROM PARKS AND RECREATION MANAGER**

E-1 Update - Park Security

E-2 Sculpture Plaza Update

E-3 Bandemer Park Update

E-3a Bandemer Map

E-4 Financial Reports

**F - REPORT FROM MANAGER OF FIELD OPERATIONS**

**G - REPORT FROM RECREATION ADVISORY COMMISSION**

**H - REPORTS FROM RELEVANT COMMISSIONS, COMMITTEES, BOARDS AND/OR TASK FORCES**

**I - PUBLIC COMMENTARY – GENERAL (3 Minutes per Speaker)**

**J - CLOSED SESSION TO DEAL WITH LAND ACQUISITION ISSUES (If Applicable)**

**K - TRANSMITTALS**

K-1 City Council Items Update

K-2 Park Project Update

K-3 Park and Recreation Events for March 2007

TELEVISED ON ANN ARBOR COMMUNITY TELEVISION NETWORK CHANNEL 16

*\*\*\*Persons with disabilities are encouraged to participate. Accommodations, including sign language interpreters, may be arranged by contacting the City Clerk's Office at 994-2700 (V/TDD) at least 24 hours in advance.\*\*\**



**DRAFT**

**CITY OF ANN ARBOR – PARKS ADVISORY COMMISSION  
MEETING MINUTES  
January 16, 2007**

The regular meeting of the Park Advisory Commission was held on Tuesday, January 16, 2007 at 4:13 p.m. in the Council Chambers located in City Hall, 100 N. Fifth Avenue, Ann Arbor, Michigan.

I. The meeting was called to order at 4:13 p.m. by Chair L. Berauer

II. Roll Call:

- Members Present: (8) L. Berauer, B. Macomber, J. Satarino, S. Offen, C. Riseng, G. Nystuen, T. Berla, J. Lawter
- Ex-Officio Members Present (2) R. Johnson, S. Kunselman
- Ex- Officio Members Absent (0) None.
- Members Absent: (1) D. Barrett
- Staff Present: (8) C. Smith, J. Dehring, K.C. Bemish, P. Kohring, G. Leikam, A. Kuras, K. Levinsohn, L. Bowen F. Krawcke

**APPROVAL OF AGENDA – L. Berauer stated that there would be an addition to the agenda. The Commission will consider a resolution as New Business (item C-1)**

**PUBLIC COMMENTARY - AGENDA ITEMS (3 Minutes per Speaker) – None.**

**SPECIAL PRESENTATIONS - None**

**A - APPROVAL OF MINUTES**

**A-1 Commissioner Satarino moved, supported by the Commission to approve the minutes of December 5, 2006 with corrections on page 2, line 75. The December 19, 2006 minutes were approved with corrections on page 1, lines 19 & 21. The minutes were approved unanimously.**

**B - UNFINISHED BUSINESS**

**B-1 Leslie Science Center Strategic Planning Recommendation**

**C. Smith** reviewed the December presentation from the Leslie Science Center Strategic Planning Committee.

**J. Satarino** requested a summary of the January 14, 2007 public meeting for the Leslie Science Center Strategic Planning Committee recommendation.

**Andy Buchshawer** summarized the public meeting discussions. The proposed Leslie Science Center strategic plan was well-received by the Leslie neighbors.

**S. Kunselman** expressed his concerns with the proposed management of the Leslie Science Center by a separate non-profit organization.

**C Rising** moved, supported by **J Satarino** to consider the Resolution Recommending Approval of a Three-year Transition Plan for Governance of the Leslie Science Center by a 501c3 Non-profit Organization that will Work in Partnership with the City of Ann Arbor and Other Community Agencies.

**Ayes:** (8) **L. Berauer, B. Macomber, S. Offen, C. Riseng, G. Nystuen, T. Berla, J. Satarino, J. Lawter**

**Nays:** (1) **None.**

**Absent:** (1) **D. Barrett**

*On a voice vote – Motion Passed – Unanimous*

**T. Berla** stated he is comfortable authorizing the Leslie Science Center Strategic Planning Committee to continue with their planning process.

**L. Berauer** stated this is an instance of the Leslie Science center being proactive in addressing continuing reduction in the City’s General Fund support for recreation facility operations and proposing alternative opportunities that will enable the City to provide high quality of park and recreation services to the community.

**S. Offen** offered a friendly amendment to the resolution: replace the language of “The Three Year Transition Plan for Governance of The Leslie Science Center” to read “The City of Ann Arbor Leslie Science Center Strategic Plan”.

**Ayes:** (8) **L. Berauer, B. Macomber, S. Offen, C. Riseng, G. Nystuen, T. Berla, J. Satarino, J. Lawter**

**Nays:** (1) **None.**

**Absent:** (1) **D. Barrett**

*On a voice vote – Motion Passed – Unanimous*

**C - NEW BUSINESS**

**C-1** Resolution

**J. Satarino** discussed a resolution addressing Bandemer Ridge and reviewed the Zoning regulation that apply to the slopes of the Huron River.

**L. Berauer** read a second addition to the second resolve to state, *The Park Advisory Commission advises the City Council that the proposed access to Bluff’s Park is not sufficient to grant planned project status.*

Resolved, that PAC advises The Planning Commission and City Council to assure that the impact of the proposed development on the view scape in the two parks and on the river is clearly and publicly documented and that the territorial impact on the view scape is minimal.

*On a voice vote – Motion Passed – Unanimous*

After further discussion;

The Commission voted on both resolutions with the amendments.

**Ayes:** (7) **L. Berauer, B. Macomber, C. Riseng, G. Nystuen, T. Berla, J. Satarino, J. Lawter**

Nays: (1) S. Offen

Absent: (1) D. Barrett

On a voice vote – **Motion Passed** – Unanimous

**RESOLUTION REGARDING DETRIMENTAL EFFECTS OF PROPOSED DEVELOPMENT ON CITY PARK VIEWSCAPES**

Whereas, the bylaws of the Park Advisory Commission (PAC) allows for examination and advice on the effects of new development within the city on city parks;

Whereas the PAC is a citizen advisory board charged in part with the responsibility of preserving the aesthetic qualities of city parks;

Whereas, a primary goal (Goal #5, pg. D6) of the Parks, Recreation and Open Space Plan (2006-2011) is to foster quality of life in Ann Arbor by paying particular attention to the Parks and Open Space system as a visual resource;

Whereas, the City through actions of parks staff, PAC, and City council has sought to preserve and protect a green corridor and natural character of the Huron River valley through investment of millions of dollars in land purchases, facility development and recreational opportunities along the Huron River within the city;

Whereas, PAC was informed at the 19 December 2006 meeting that a residential development called “Bandemer Ridge” was being reviewed by the Planning Commission, and that PAC agreed to a full discussion of the possible impacts on parks property at the 16 January 2007 meeting;

Whereas, the developer proposes to construct a 56-foot tall building on the steep slopes of North Main Street overlooking Bandemer Park, Argo Pond and Argo canoe livery, which according to ordinance (Natural Features Ordinance) must be considered for its impact on the scenic Huron River valley;

Whereas, the proposed plans for “Bandemer Ridge” would remove trees, including landmark trees, along the north slope of North Main St. that currently form a continuous natural tree line along the valley ridge from Barton to Argo dam;

Whereas, the proposed development would be a dominant structure along the Huron River valley that would have aesthetic impacts on four city parks (Bluffs (directly adjacent), Argo, Bandemer and Longshore Parks), the Argo canoe livery, and the potential Allen Creek greenway which would terminate near the proposed development thus potentially affecting all users of the parks, greenways and Argo Pond;

Whereas, the developer has offered a potential public access to Bluffs Park through “Bandemer Ridge” property as an inducement for the city to accept greater building height and length and reduced setbacks as a “planned project”;

Resolved, that PAC advises City Council that the mass and height of the proposed development will have a detrimental effect on the view scape for all citizens of Ann Arbor using four city parks, Argo Pond and a potential future greenway along Allen Creek;

Resolved, that PAC advises The Planning Commission and City Council to assure that the impact of the proposed development on the view scape in the two parks and on the river is clearly and publicly documented and that the territorial impact on the view scape is minimal.

Resolved, that PAC advises City Council that the proposed access to Bluffs Park is not a great enough public benefit to grant Planned Project status to the proposed development.

Approved by PAC January 16, 2007

187 **S. Kunselman** asked whether a representative of PAC should be included on the Planning  
188 Commission.  
189

190  
191 **S. Offen** stated there was not enough information to make a determination at this point.  
192

193 **L. Berauer** suggested inviting the developer make a presentation to PAC at a future  
194 meeting  
195

196 **J. Satarino** agreed to the suggestion of the developer attending a PAC meeting.  
197

198 **L. Berauer** read a second addition to the second resolve to state, *The Park Advisory*  
199 *Commission advises the City Council that the proposed access to Bluff's Park is not*  
200 *sufficient to grant planned project status.*  
201

202 *On a voice vote – **Motion Passed** – Unanimous*  
203

204 **S. Offen** stated the “whereas” should be statements of fact.  
205

206 After further discussion;  
207

208 The Commission voted on both resolutions with the amendments.  
209

210 **Ayes: (7) L. Berauer, B. Macomber, C. Riseng, G. Nystuen,**  
211 **T. Berla, J. Satarino, J. Lawter**  
212

213 **Nays: (1) S. Offen**  
214

215 **Absent: (1) D. Barrett**  
216

217 *On a voice vote – **Motion Passed** – Unanimous*  
218

219 **D - COMMISSION PROPOSED BUSINESS**  
220

221 **D-1** PAC Annual Work Plan Timeline for Completion (schedule Work Session)  
222

223 **L. Berauer** stated a date for this session would be determined via email.  
224

225 **D-2** Ice Skating Pass  
226

227 **S. Kunselman** read the resolution printed below and explained to the Commission and  
228 stated the private sector has fees that are less than the City of Ann Arbor.  
229

230 **RESOLUTION RECOMMENDING THE CITY OF ANN ARBOR REDUCE ADMISSION**  
231 **FEES AT CITY ICE RINKS FOR CHILDREN 17 & UNDER FOR THE REMAINDER OF**  
232 **THE 2006/07 ICE SKATING SEASON**  
233

234 Whereas, the City of Ann Arbor is mandated by the City Charter to provide for the parks and  
235 recreational needs of its citizens, and  
236

237 Whereas, the City in years past provided free ice skating rinks at it's city parks such as  
238 West Park, Allmendinger Park, Burns Park, Northside, Scheffler Park, Wheeler Park and  
239 Hunt Park; and  
240

241 Whereas, due to climatic and budgetary conditions, the City only provides ice skating  
242 opportunities for its residents today at Veterans Park and Buhr Park for which admission  
243 fees are charged that mimic privately operated ice skating facility admission fees; and  
244

245 Whereas, City staff has identified over \$200,000 in discretionary funds to be used to create  
246 a “for profit canoe livery” enterprise operation; and  
247  
248

Whereas, the “for profit canoe livery” enterprise operation proposal did not receive any approval from City Council and subsequently was not selected by the Huron-Clinton Metropark Authority; and

Whereas, the Park Advisory Commission, at the January 17, 2006 meeting discussed the concern that admission fees were too high and resulting in lower participation rates at City recreational facilities and resolved to recommend to City Council that admission fees be reduced; and

Whereas, the over \$200,000 in discretionary funds identified by staff are available immediately to reduce the admission fees to the City ice rinks at Veterans Park and Buhr Park by \$2.00 per child 17 & under that reside in Ann Arbor;

Now, therefore, be it resolved on this day, January 16, 2007, that the City of Ann Arbor Parks Advisory Commission recommends to the City Council of Ann Arbor to reduce the admission fees to the City ice rinks at Veterans Park and Buhr Park by \$2.00 per child 17 & under that reside in Ann Arbor effective immediately and for the duration of the remaining 2006/07 ice skating season.

Submitted by Stephen Kunselman, Councilmember, Ward 3

**S. Kunselman** stated that public skate session fees are too high and the ice arena facilities are under used. Kunselman also stating that fees should be reduced for youth.

**C. Riseng** stated that in the past staff has brought fee recommendations to the Commission as a part of the budget discussion.

**Dennis Simon** reviewed fees and skate pass options at the ice arenas.

**S. Kunselman** stated he concern with providing affordable access to ice skating facilities in the community and expressed his opinion that the City has lost sight of the needs of working people in this community

After further discussion;

**T. Berla** moved to table the resolution, supported by J. Satarino.

*On a voice vote – Motion Passed – Unanimous*

**E - REPORT FROM PARKS AND RECREATION MANAGER**

**E-1** Bandemer Park Improvements

**E-1a** Bandemer Park Improvement Memo

**E-1b** Bandemer Park Map

**E-2** Sculpture Plaza Improvements

**F - REPORT FROM MANAGER OF FIELD OPERATIONS – None.**

**G - REPORT FROM RECREATION ADVISORY COMMISSION – None.**

**H - REPORTS FROM RELEVANT COMMISSIONS, COMMITTEES, BOARDS AND/OR TASK FORCES**

**H-1** Land Acquisition Business – Property Scoring Criteria

**Ginny Leikam** distributed strategic planning materials for land acquisition activities. After further discussion;

311  
312  
313  
314  
315  
316  
317  
318  
319  
320  
321  
322  
323  
324  
325  
326  
327  
328  
329  
330  
331  
332  
333  
334  
335  
336  
337  
338  
339  
340  
341  
342  
343  
344  
345

J. Satarino moved for the Park Advisory Commission to go into the closed session.

A-1

On a roll call vote – **Motion Passed** – Unanimous

I - **PUBLIC COMMENTARY – GENERAL**(3 Minutes per Speaker) – **None.**

J - **CLOSED SESSION TO DEAL WITH LAND ACQUISITION ISSUES** (If Applicable)

CLOSED SESSION TO DISCUSS LAND ACQUISITION AND ATTORNEY/CLIENT PRIVILEGED COMMUNICATION.

K - **TRANSMITTALS**

**K-1** City Council Items Update – (Information in Packet)

**K-2** Parks and Recreation Events for October 2006 – (Information in Packet)

**K-3** Parks and Recreation System – (Information in Packet)

**K-4** Park and Recreation Events for November 2006 – (Information in Packet)

There being no further business to come before the Commission, Commissioner Satarino moved that the meeting be adjourned at 5:40 p.m.

Respectfully submitted,

*Lynn Bowen*

Lynn Bowen

Administrative Support Specialist V

## MEMORANDUM

E-2

TO: Park Advisory Committee

FROM: Amy Kuras

DATE: January 16, 2007

SUBJECT: Sculpture Plaza Design Update

Last summer, the City Parks and Recreation and DDA held three public meetings to discuss Sculpture Plaza. Below is a summary of the input we received and decisions that were made. Before proceeding with the final drawings, the designs are being put on the City and DDA website for any final comments. At the end of the document is a drawing of the proposed design.

Issues discussed and decisions reached are summarized below:

### Sculpture:

There was a healthy discussion about whether to keep the sculpture there or remove it, to place it on a pedestal, to light it, to place a fountain around it, to renovate it, or just leave it alone. The final decision was to leave it where it is, to clean off the graffiti and repair the areas where it has rusted through.

### Bricks:

Discussion centered around whether to leave the bricks, remove and replace them, that they are slippery when wet, whether or not to add a sidewalk in the most heavily used walking areas, whether to explore if the existing bricks could be altered in some way to make them less slippery, that they are uneven and create trip hazards. The consensus was to reuse the existing bricks but re-lay them to eliminate trip hazards, attempt to find replacements for those that have deteriorated beyond usability, and explore ways to make the brick surface less slippery, at least in the highest use areas instead of placing a sidewalk along the edge of the plaza.

### Seating:

There was general agreement that tables with umbrellas should be maintained, but there was discussion about the type of tables, and whether to replace them with a style that won't hold snow, spilled soda, etc. There were requests for more seating, as well as seating that would provide more of a 'community' feel so that park users could socialize, participate in drum circles, etc. and that the seating would enhance those activities. Moveable tables and chairs were discussed as well as adding seat walls around the planting beds, reconfiguring the seating along the edges, and replacing the existing tables with ones that are easier to keep clean. It was proposed that one of the business owners would be approached about participating in an experiment where moveable tables and chairs would be available at the site and locked up at night. The seat wall idea was eliminated as some participants felt that it would make the plaza feel too structured and closed.

The idea of a bench in the planting bed was suggested and may be added. The seating on the edges of the planting beds will be reconfigured to reflect the circular nature of the plaza and create a more community feel. The new tables will not have an edge that can collect crumbs or dirt, and have some variety in number of seats for more flexibility.

#### Planting Beds:

Discussion centered around the types of plant materials, irrigation to help maintain the plants, replacing the dead trees and planting larger caliper trees. Irrigation was thought to be a good idea to help keep plants alive with less maintenance. Planting larger trees was favored by everyone, but their success rate in the long term may not be as great if they are too large as the roots are compromised in transplanting. We will discuss size of trees with the City Forester for a size recommendation, for as large as will have a good chance of survival.

#### Shade:

There was discussion about adding more shade to the plaza without compromising the open feel of the plaza. Two street trees will be added, one along Catherine, and one along Fourth, allowing for site visibility and retaining the openness of the plaza. The Ash trees that were in the planters will be replaced.

#### Lighting:

Discussion included whether to add lighting along the park frontages, what type of lighting would be appropriate: the same as what is currently along Fourth, or a special lighting, and how many to put in, as well as relocating the existing light that is currently in the walking path. Up-lighting in the planting beds was discussed to accentuate the plantings and bring a more festive atmosphere at night. Decisions were to add two additional lights, one along Fourth and the other along Catherine, carefully placed so as not to block vehicle sight distance at the corners or pedestrian sight distance in and through the plaza, and to light the Plaza at night for safety but not to make the area too bright or garish. It was decided that the lighting would continue in the same style as those on Fourth, and that the light in the middle of the sidewalk would be relocated out of the walking path. The up-lighting idea was thought to be positive, but should be subtle. An idea to explore solar powered lighting for planting beds was suggested.

#### Other items discussed:

Idea to add a couple of decorative bicycle hoops was discussed both to provide additional bike parking and to help frame the space without taking away from the open feeling of the Plaza.

A couple of new bicycle hoops will be added to the sides of the plaza.

A drinking fountain was desired by some participants, including a low bowl for dogs. This was not resolved in the meeting, and probably will not be added at this time.

Bright pavement marking for crosswalk should be added to increase safety. This also was an idea that was unresolved.

Moving the recycling to the alley was desired instead of having it on the street. This will be researched further to see if it is feasible.

Next Steps:

In order to solicit any additional comments, we are posting the drawings on the City and DDA website, and moving forward with finalizing the design. We will keep you updated on input and discussion of a final design in the coming months. Once again, thank you for your involvement with the project. If you have any questions, please contact Amy Kuras at 994-1827 or [akuras@ci.ann-arbor.mi.us](mailto:akuras@ci.ann-arbor.mi.us) or Susan Pollay, at 994-6697 or [spollay@ci.ann-arbor.mi.us](mailto:spollay@ci.ann-arbor.mi.us).

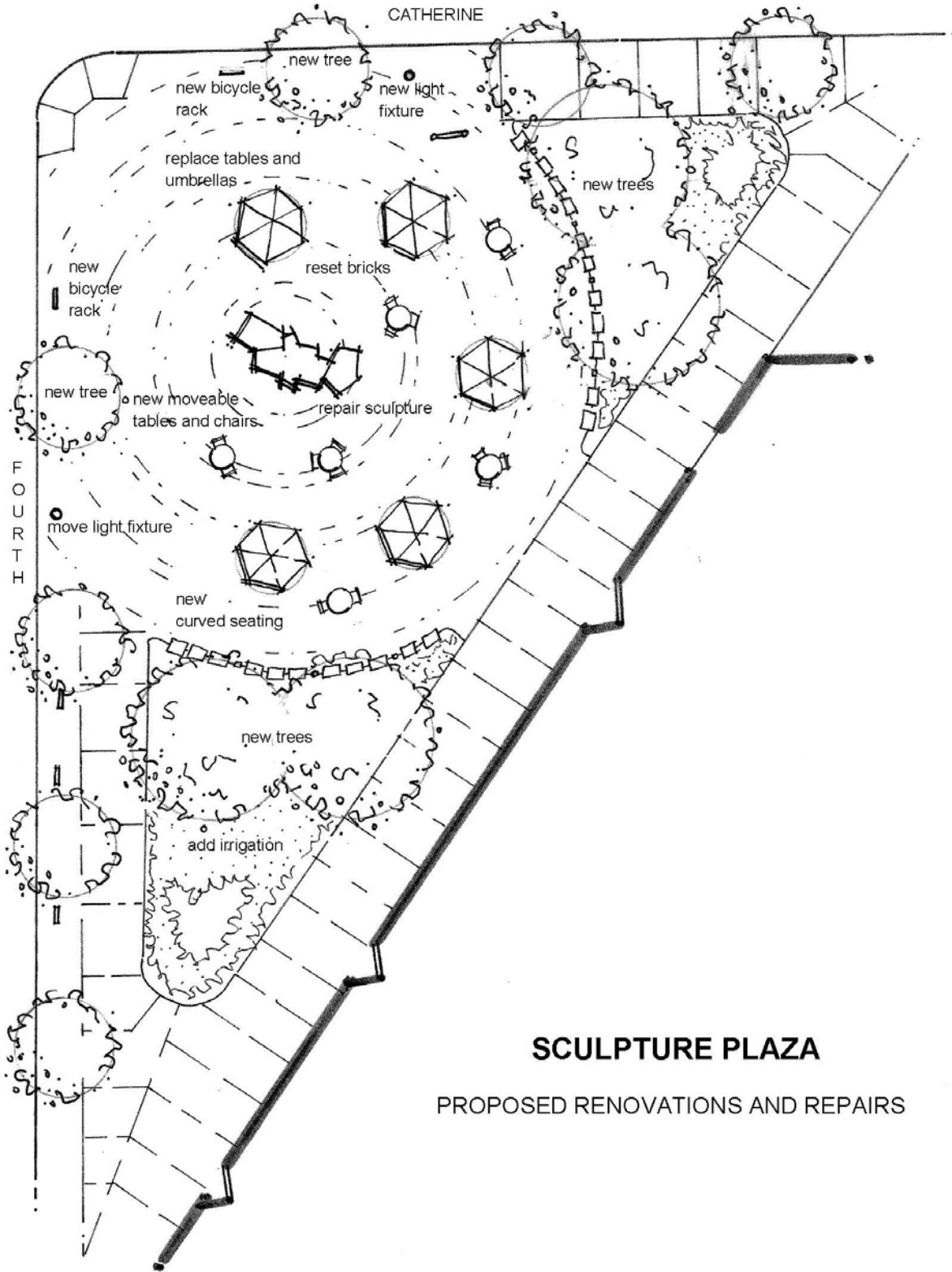

## SCULPTURE PLAZA

PROPOSED RENOVATIONS AND REPAIRS

## MEMORANDUM

TO: Park Advisory Commission

FROM: Amy Kuras, Park Planner

SUBJECT: Bandemer Park Improvements

DATE: January 16, 2007

Attached are drawings of proposed improvements to Bandemer Park. The Park Rehabilitation and Development Millage have funds dedicated for improvements to the park. The last remaining industrial tenant vacated the south end of the property in 2005, and parks staff then began the public process to reclaim the area for parkland. Three public meetings were held to discuss improvements and the following items were discussed:

1. Demolish the Quonset huts (there was debate concerning this item, but it was decided that the structures would not function for other park uses without extensive renovation, and without water on site would be of limited use)
2. Reconfigure the south end of the park to allow for more organized parking, to move the road away from the river, and to create more green space
3. Create storm water detention areas with naturalized plantings
4. Construct a disc golf course utilizing the baskets that were removed from Mary Beth Doyle Park. The clearing will be of invasive species only, all trees other than Buckthorn and Honeysuckle will remain.
5. Construct a bmx course.
6. Supply bicycle racks and interpretive/way finding signs.
7. Plant more trees
8. Provide park amenities such as a restroom, picnic shelter and picnic tables.

Additional work being done to reclaim the park from the former industrial use includes removing the overhead electric lines and poles that are no longer being used, burying the lines that remain, and testing and filling the monitoring wells.

The north end of the park will receive infrastructure improvements for ease of maintenance, including paving the gravel lot and entry road, and repairing any walks and deteriorated docks.

Railroad

BMX course area

HURON RIVER

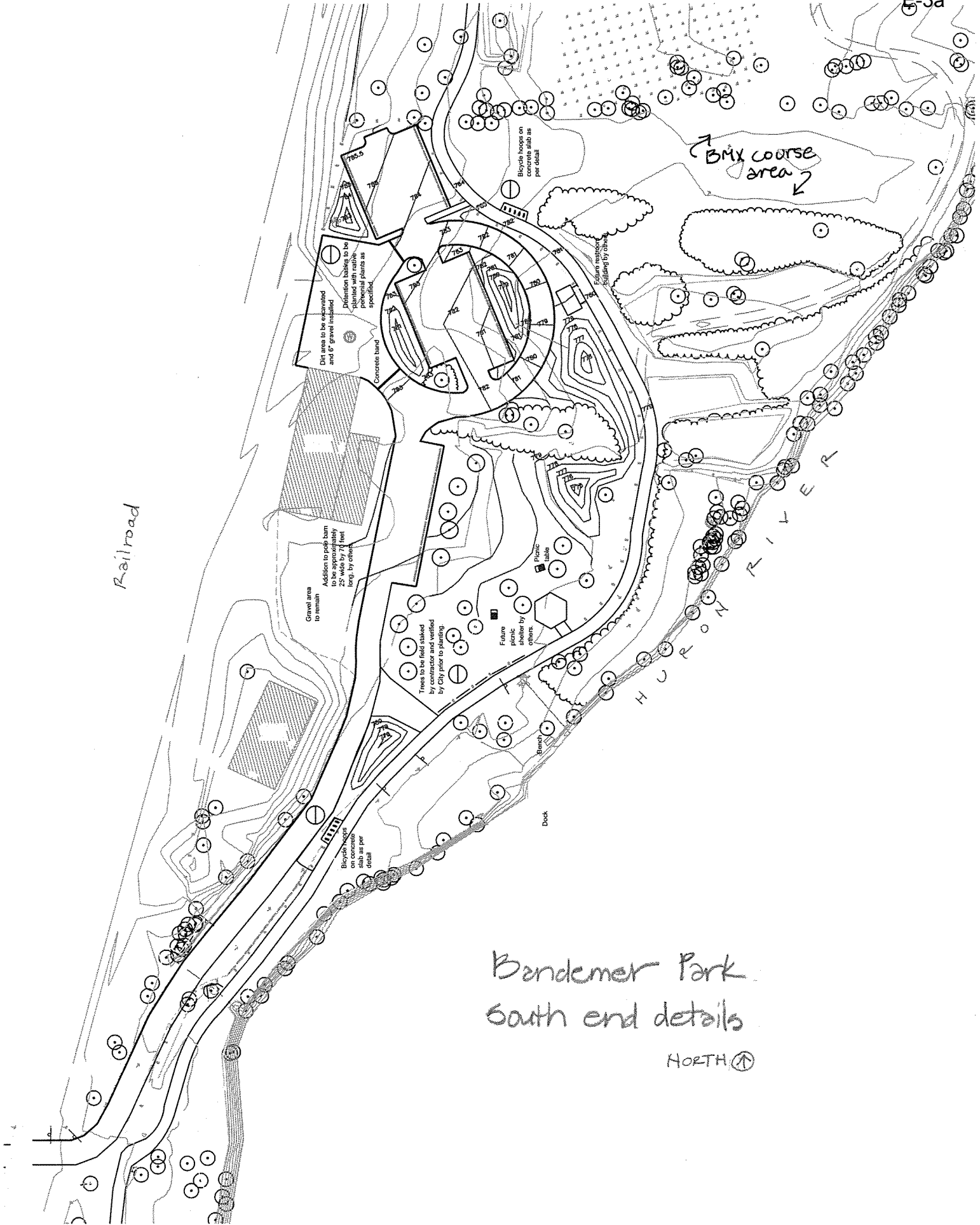

Bendemer Park  
South end details

NORTH ↑

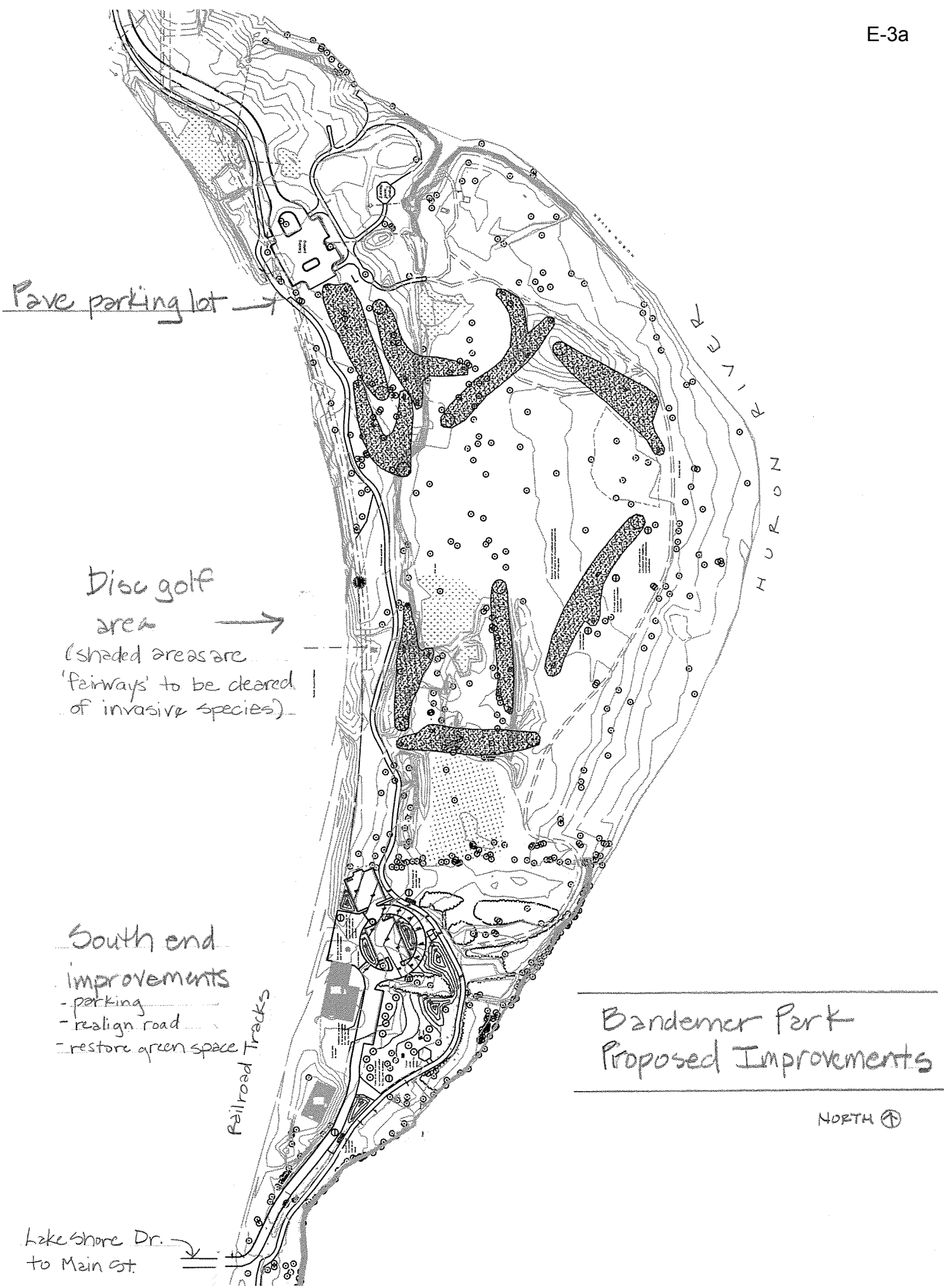

# City Council Items Update List

FEBRUARY 2007					
	Cost	Staff	Council Date	Council Action	Source of Funding
Resolution to approve a Raptor Specialist Contract for Leslie Science Center	\$24,000.00	KL	12/18/06	approved	GF
Resolution to approve a construction contract for the Kempf House Window Restoration Project,	\$29,000.00	AK	11/9/06	approved	Fund 18 & Kempf House Museum Board
Resolution to approve a construction contract for improvements at Brookside Park.	\$50,000.00	AK	10/16/06	approved	Fund 18
Resolution to approve a contract to provide engineering services for the design of a pedestrian underpass to connect Bandemer Park to Barton Park.	\$203,424	AK	Deferred	NA	NA
Resolution to approve a construction contract to complete playground improvements at Gallup Park	\$103,538	AK	9/5/2006	approved	Fund 18
Resolution to Approve a New Park Maintenance and Capital Improvements Millage Proposal for Submission to the Voters at the November 2006 Election	NA	JM	8/21/2006	approved	NA
Resolution of Intent on the Administration of Park Maintenance and Capital Improvements Millage	NA	JM	8/21/2006	approved	NA
Approve a construction contract for improvements at Wellington Park	\$45,400.00	AK	8/10/2006	approved	Fund 18
Paving project at five neighborhood park locations.	\$137,000.00	JD	8/17/2006	approved	Fund 18
Approve A Caretaker Contract For Maintenance Of Leslie Science Center	NA	KL	7/3/2006	approved	General Fund
Approve A Construction Contract for Improvements At Evergreen Park	\$61,429.00	JD	6/5/2006	approved	Fund 18
Replacement of Ice Rink Compressor Units at Buhr Park and Veterans Memorial Ice Arenas	\$136,400	JD	7/19/2006	approved	Fund 18
Approval of Revised Market Master Plan	NA	JD	1/23/2006	approved	Fund 18
Approval of the Parks and Recreation Open Space Plan, 2006-2011	NA	AK	1/23/2006	approved	Fund 18

**Park Rehabilitation and Development Millage  
Project Update  
February 2007**

**Bandemer Park**

- Work continues on the park master plan including design of the parking layout, plantings and park amenities.
- Environmental mitigation company has abandoned monitoring wells on site.
- Disc Golf Course is out for bid, due on February 13th.
- Detroit Edison has been contracted to remove overhead service on the site and a separate electrical company has been hired to install new wiring. Wires have been buried; poles are scheduled for removal in February.

**Bluffs Park**

- The neighboring business on Main Street is encroaching into the park. Legal action will be taken.
- An additional meeting with the neighborhood will be conducted to gather more resident input on design of the trail network.
- The construction of a parking area off Main St. is being considered, however, the acquisition of a northern access point remains the preferred option.

**Brookside Park**

- New play equipment has been installed. The finish-grading, seeding, fencing, and the sidewalk work will be completed in the spring.

**Mary Beth Doyle Park (Brown Park)**

- The majority of construction work will be suspended during the winter months. Frozen sediment materials will be hauled from the site throughout the winter. The park remains closed.
- Planning for improvement of the park recreational amenities continues.

**Dog Park – Swift Run**

- MDEQ has approved proposed plans for a dog park at the site.
- Preliminary construction plan preparation work is in process.
- A meeting with K9 Club, County, and others should be occurring in the next few weeks to review and discuss revised plans.
- Preparation of a partnership agreement between the City and County is in process.

**Dog Park - Other parks**

- An off-leash dog run area is being proposed at Riverside Park. A public meeting will be convened in February/March to discuss proposal with neighbors.

**Farmers Market**

- Request for Proposals have been received from nine consultant teams to prepare Contract Documents and oversee the Construction Administration of the renovation project.

- Interviews with two firms are to occur February 13<sup>th</sup>.
- We anticipate that the contract will be awarded by City Council in March.

#### Game Court and Pathway Paving Projects

- Wet site conditions have resulted in delays in the project work. The sites have been stabilized for the winter without asphalt surfacing. The work should resume in the spring.
- Small signs have been posted at each site explaining the project status and our delay.
- Replacements of several segments of deteriorated pathways are planned for summer. Park areas that require replacement include Allmendinger Park and Scheffler Park and a portion of the Garden Homes path.

#### Garden Homes Park

- A public meeting was conducted on October 5th at Abbott Elementary School to discuss improvements to Garden Homes Park. Letters were sent to the neighborhood with proposed design. Improvements will include a new play area, park furniture, bird/bat houses, and replacement of existing asphalt pathway.

#### Gallup Park Improvements

- Redevelopment of the play area at Gallup Park will be completed in the spring.
- Park signage is being replaced in Gallup Park to provide uniformity in signage.
- Repairs to the asphalt trails are also planned for this summer.

#### Greenview Park

- Conversations with Ann Arbor Public School staff continue regarding use of portion of the site for a play area.

#### Interpretive Signs

- A graphic artist is assisting with the design of signage for several parks including wayfinding signs at Black Pond, Marshall, Bird Hills, Mary Beth Doyle, Dolph, Cedar Bend, and Scarlet Mitchell Nature Areas. Interpretive signs are being designed for the Leslie Science Center, Gallup Park and Cobblestone Farm.

#### Kempf House

- Window replacement will be completed at Kempf House. The Kempf House Museum Board of Directors is contributing up to \$3,000 for the project. Work will begin in March.

#### Lansdowne Park

- The playground improvements at the site are complete.
- Pathway and basketball court work are occurring under separate contract.

#### Leslie Science Center

- Construction on the Raptor Center enclosures is complete.

#### Olson Park

- A request for proposals has been prepared for supplying and installing a restroom building at the park. A late spring installation is anticipated.

- Working with NAP staff to prepare specifications to install additional plantings this spring.
- Bid documents will be prepared for installing the final asphalt course to the parking lots and driveway areas.

#### Project Grow Community Garden Proposal

- A community garden has been proposed for Virginia Park. A public meeting was January 25th at Slauson School to discuss the proposal with neighbors. Most of the neighbors were in favor of the proposal. Soil tests will be done in the proposed area, and a second smaller meeting at the park is planned as soon as the soil tests are completed.

#### Redwood Park

- A public meeting was conducted on December 7<sup>th</sup> at Mitchell Elementary School. Improvements will include benches, landscaping and a walkway through the park.
- Bids for the park equipment have been received.

#### River Parks

- Staff met to determine priorities for repairs/renovations to river parks, including shoreline restoration along the mill race trail, repair to the boardwalk in Riverside Park, and replacement of the canoe portage at the mill race for barrier free access. An RFP will be distributed to engineering firms for design work.

#### South Maple Park

- A public meeting was conducted on October 24<sup>th</sup> to review improvements to South Maple Park. Improvements will include replacement of the playground equipment and renovation of the existing walkway.

#### Sculpture Plaza

- The proposed design for repairs has been posted on the City and DDA website for final comments from the input received last summer. Staff will present a plan to PAC in the coming months to share proposed renovation ideas. Work on construction documentation is in process for summer renovations.

#### Sylvan Park

- Design work for park improvements is in process. Improvements will include a new play structure, asphalt path, picnic tables and benches.
- Repairs to the existing tennis court and fence will also be included in the park renovation project.
- Bids for the playground equipment have been received.

#### Wellington Park

- Installation of a new play structure, swings, barrier free access pathway, park furniture and landscaping is complete. A climbing structure will also be installed in the spring as weather permits.



CITY OF ANN ARBOR, MICHIGAN  
Parks and Recreation Services Administration Office  
809 Taylor St.  
Ann Arbor, MI 48105  
Phone: 734-994-2780  
Web: [www.a2gov.org/parks](http://www.a2gov.org/parks)

K-3

**For Immediate Release**  
March, 2007

CONTACT: Christen Smith  
734.994.1303  
e-mail: [ChSmith@a2gov.org](mailto:ChSmith@a2gov.org)

## **ANN ARBOR PARKS AND RECREATION EVENTS FOR MARCH 2007**

Find complete details at [www.a2gov.org/parks](http://www.a2gov.org/parks) or by calling the individual facility.  
Advance registration is required, unless otherwise noted.

**Open Saturdays, 8 a.m. to 3 p.m. Ann Arbor Farmers Market, 315 Detroit St., 734.994.3276.**

**Wednesday afternoon and Friday morning appointments will be taken for Tax Assistance at the Ann Arbor Senior Center, 1320 Baldwin.** AARP Volunteers will assist persons age 60 years and older in filing their Federal and State Income Tax forms. **For details call 734.769.5911.**

**Every Monday in March from 10 a.m. to noon. Open Barn Play Time at Cobblestone Farm Center, 2781 Packard Road, 734.994.2928.** Children (ages 5 years and under) will revel in active play, music and socialization with children their age. This time is designed to give parents and children an arena for active play and socialization in a warm and safe location. Reservations are preferred, but not required. Space is limited to the first 25 children. Fee: \$5/child.

**Mondays 11 a.m. to 12:30 p.m. Knitting/Crochet Women's Group. Ann Arbor Senior Center, 1320 Baldwin. Free of charge.** Bring your knitting/crocheting supplies and join us.

**Lunch at the Ann Arbor Senior Center, 1320 Baldwin.** Join us **every Monday, Wednesday and Friday** at 11:30 a.m. for a nutritious lunch. A donation of \$2.50 per person for ages 60 and over is suggested. Please call 769-5911 two workdays before to make your lunch reservation.

**Each Tuesday at 2:30 p.m. Investment/Financial Planning at the Ann Arbor Senior Center, 1320 Baldwin.** Various free seminars are held on financial planning and investment opportunities. Please call for details 734.769.5911.

**Each Thursday 9:30 to 11:30 a.m. Men's Club, Ann Arbor Senior Center, 1320 Baldwin. Free of charge.** Current events, sports talk, trivia and camaraderie with refreshments.

**March 3 (Saturday mornings) to April 28 (no class April 7) American Red Cross Swim Lessons at the Mack Indoor Pool. 715 Brooks St. 734.994.2898.** Group instructional swimming classes are offered for ages 6 months to adult beginners. Class levels one, two, three, parent & child, and adult run 30 minutes each, while class levels four, five, and six run 45 minutes each. Level parent & child, 1, 2, 3: \$55/\$45 resident discount; Level 4, 5, 6, Adult: \$70/\$55 resident discount.

**Monday, March 5 at 1 p.m. Table Game Day at the Ann Arbor Senior Center, 1320 Baldwin. Free of charge.** Sponsored by Brookhaven Manor. Play games such as Time, Mah Jongg, Bridge, Chess and Skip Bo.

**Tuesdays, March 6, 13, 20, 27 from 1 to 2:30 p.m. Nature Detectives for Tykes at the Leslie Science Center, 1831 Traver Road, 734.997.1553.** Little hands and little eyes will take a closer look at the little things in life. Each week we'll start with a clue that will lead us into our adventure. Using hand lenses, microscopes, stories and games we'll decode the meaning of each week's riddles. Fee: \$43/\$36 resident discount.

**March 9 and 23 from 9:30 to 11 a.m. Tiny Tot Times at the Leslie Science Center, 1831 Traver Road, 734.997.1553.** Come join us for stimulating free play outdoors with fun filled hands-on nature activities to tickle the inner child in everyone. We will discover and explore fields, forest and fauna with hikes, songs, stories, puppets, games, crafts and critters.

**Saturday, March 10 from 1 to 3 p.m. Mission Impossible at the Leslie Science Center, 1831 Traver Road, 734.997.1553.** Your mission, if you choose to accept it, is to gain knowledge of the natural world. To identify, create and decipher nature's mysteries and puzzles. Test your knowledge and observation skills while traveling around LSC during this fun filled adventure. Fee: \$6 per person, pre registration and an adult required.

**Monday March 12, and Monday March 26 12:45-3:45 p.m. Duplicate Bridge at the Ann Arbor Senior Center, 1320 Baldwin.** Fee each visit is only \$1.

**March 12 from 8:30 a.m. to 5:30 p.m. (pizza lunch is provided). Days Off Outdoors at the Leslie Science Center, 1831 Traver Road, 734.997.1553.** When schools are closed, come discover the wonderful world of nature. Sled down the snowy slopes. Explore the forest, fields, and trails. Be a predator while stalking your prey in a dense thicket...a different adventure awaits you each day. Fee: \$65/\$53 resident discount per day, ages K-5th grade.

**March 12 to April 25 (Monday and Wednesday for 14 sessions). NiaFit at the Ann Arbor Senior Center, 1320 Baldwin.** We will use hand held weights and elastic resistance to gain an overall workout to build bone density and strengthen muscles of the arms, legs, abdominal, and back. Also included are exercises for flexibility and balance. NiaFit is a great class for all levels. Instructor: John Levens. Fee: \$80/\$64 resident discount. Call 734.769.5911.

**Note: It is the intent of the city of Ann Arbor to provide equal opportunities and access to all programs and facilities. For special assistance or accommodation, call the individual facility.**

#####