

ADDENDUM No. 1

RFP No. 23-22

PONTIAC, SWIFT, MOORE AND WRIGHT WATERMAIN AND RESURFACING PROJECT

Due: April 26, 2023 at 10:00 A.M (local time)

The information contained herein shall take precedence over the original documents and all previous addenda (if any), and is appended thereto. **This Addendum includes 15 pages.**

The Proposer is to acknowledge receipt of this Addendum No. 1, including all attachments in its Proposal by so indicating in the proposal that the addendum has been received. Proposals submitted without acknowledgement of receipt of this addendum may be considered non-conforming.

The following forms provided within the RFP Document should be included in submitted proposal:

- **Attachment D - Prevailing Wage Declaration of Compliance**
- **Attachment E - Living Wage Declaration of Compliance**
- **Attachment G - Vendor Conflict of Interest Disclosure Form**
- **Attachment H - Non-Discrimination Declaration of Compliance**

Proposals that fail to provide these completed forms listed above upon proposal opening may be rejected as non-responsive and may not be considered for award.

I. CORRECTIONS/ADDITIONS/DELETIONS

Changes to the RFP documents which are outlined below are referenced to a page or Section in which they appear conspicuously. Offerors are to take note in its review of the documents and include these changes as they may affect work or details in other areas not specifically referenced here.

Section/Page(s)	Change
Page DS-232 to DS-235	Temporary Water Main, Wright Street: Updated to state water service connection preference, increase depth of cover requirement an other minor items.
Plan Sheets 38-42	Pavement marking plan updates include: <ul style="list-style-type: none">• Minor revisions to pay item language (transv vs. longit)• Correction to naming convention (recessing vs. recess)• Removal of railroad crossing symbol on Moore Street• Minor signing changes
Page E1-E4	The bid form has been amended to reflect the modifications of this Addendum No. 1 and other quantity corrections from original contract documents.

DETAILED SPECIFICATION
FOR
TEMPORARY WATER MAIN, WRIGHT STREET

WT:VCM:RJM:CGT

1 of 4

03/27/23

a. Description.- The work includes construction of temporary water main and water service connections to existing homes to supply water while the existing water main on Wright Street north of Kellogg is out of service. Temporary water service may be used as deemed necessary to complete the proposed watermain installation on Wright Street north of Kellogg, only at the approval of the Engineer.

b. Material.- Temporary Water Main shall PVC or Polyethylene pipe unless otherwise approved by the Engineer.

Temporary Water Main shall be of the minimum diameter as specified below:

- 2-inch diameter for systems with 10 or less residential connections (3/4-inch)
- 4-inch diameter for systems with 50 or less residential connections (3/4-inch)
- 6-inch diameter for systems with 51 or more residential connections (3/4-inch) but not more than 80 connections.
- Minimum size of the temporary water main shall be upsized as appropriate for services larger than 3/4-inch or more than the maximum allowed number of connections.

Polyethylene Pipe

Polyethylene pipe shall be AWWA C906 high-density polyethylene pipe, minimum Pressure Class 160 (SDR 11). Pipe shall be clean and approved for potable water.

Fittings: Tees, crosses, bends, plugs and corporation stops shall be Butt Heat Fusion Type, SDR 11, per ASTM D3261 or Electrofusion Type, per ASTM F1055. Fittings for joining HDPE pipe to Ductile Iron pipe or PVC C900 pipe shall be fully restrained, Mechanical Joint Adapters.

Pipe Joints: Butt Fusion Welded or Electrofusion Welded. All joints shall meet the leakage test requirements of Section 33 1100, Water Utility Distribution Piping.

Water Service Taps: Electrofusion corporation saddles with 1-inch brass outlet threads and brass corporation stop.

PVC Pipe

PVC pipe shall be AWWA C900, restrained joint, PVC plastic, minimum Class 200 (DR 14) or ASTM D2241, SDR 17, restrained joint PVC meeting the requirements of NSF-14. Pipe shall be clean and approved for potable water.

DETAILED SPECIFICATION
FOR
TEMPORARY WATER MAIN, WRIGHT STREET

WT:VCM:RJM:CGT

2 of 4

03/27/23

Pipe Joints: Non-Metallic, restrained joint couplings with high-strength, flexible, thermoplastic spline retainers. Retainers shall be inserted into mating precision machined grooves in the pipe and coupling to provide full 360° restraint. Couplings shall be designed for use at the rated pressures of the pipe and shall incorporate twin elastomeric sealing gaskets meeting the requirements of ASTM F477. Joints shall meet the leakage test requirements of Section 33 1100, Water Utility Distribution Piping.

Fittings: PVC, AWWA C900, Pressure Class 200 (DR 14).

Water Service Taps: Bronze corporation stops with AWWA corporation stop inlet thread and thread outlet compatible with the water service pipe used.

Water Service Pipe

Water service pipe connecting houses to the temporary water main shall be minimum ¾-inch diameter.

- Polyethylene, AWWA C901, Pressure Class 125, minimum 1-inch diameter with mechanical restrained fitting.
- Soft Copper, ASTM B88, Type K, with flared fittings.
- 1-inch NSF 61 approved hose with brass couplings (Kuriyama KCO 46-W).

d. Construction Methods.-

Coordination

Contractor shall verify operation of each curb stop with the City of Ann Arbor prior to beginning work. Where necessary, the City of Ann Arbor shall repair/replace existing curb stops and/or curb boxes to complete the work.

Contractor shall coordinate with the City of Ann Arbor 72 hours prior to shutting down existing water main.

Notification

The Contractor shall notify the City of Ann Arbor a minimum of seven days prior to beginning work so that affected residents may be notified. Contractor shall coordinate with the City of Ann Arbor to provide a written notice delivered to each resident, advising the resident as to when water service will be interrupted and to minimize water usage during this period. The Contractor and Engineer shall ensure that every user is so

DETAILED SPECIFICATION
FOR
TEMPORARY WATER MAIN, WRIGHT STREET

WT:VCM:RJM:CGT

3 of 4

03/27/23

notified. Notification shall include telephone number(s) for contacting the Contractor at any time, day or night.

A second written notice to the water users affected shall be provided one working day prior to the actual switch over from the existing water main to the temporary water main.

Finally, a notice shall be provided upon completion to each user within 12 hours of water service being reconnected to new water main.

Installation

The location of the temporary water main must be approved by the Engineer. Temporary water main shall be installed either above grade or below grade at Contractor's option except as outlined below. Above grade pipe including services shall be appropriately protected from abuse, damage, vandalism, etc.

Temporary water main and services shall be protected above ground at driveways and sidewalks so as not to disturb existing cobblestone gutter. If contractor elects to and is able to bury without disturbance of cobblestone gutters, temporary water main and services shall be covered with a minimum of 12-inches of compacted aggregate at driveways and sidewalks.

Temporary water main at road crossings and commercial driveways shall be buried with a minimum of 12-inches aggregate and temporary pavement.

Temporary water main and service connections shall not be installed in such a way as to disturb or damage existing cobblestone gutters along Wright Street. If the cobblestones must be disturbed to complete this work, the contractor shall salvage and replace the cobblestones as noted in the Detailed Specification for Removal and Reinstallation of Cobble Gutters. Any disturbance of cobblestone gutters may only occur at the approval of the Engineer, and the removal/restoration shall not be paid for separately, but shall be included in the pay item for Temporary Water Main, Wright Street.

All temporary paving and access provisions shall not be paid for separately but shall be included in the pay item for Temporary Water Main, Wright Street.

Cleaning, Flushing and Chlorinating and Testing

The temporary water main shall be cleaned, flushed, disinfected and tested in accordance with the Detailed Specifications for "Water Main Installation and Testing" and "Water Main and Appurtenances".

DETAILED SPECIFICATION
FOR
TEMPORARY WATER MAIN, WRIGHT STREET

WT:VCM:RJM:CGT

4 of 4

03/27/23

Connection to Water Supply

After successfully chlorinating the water main, the main will be connected to the water supply. The temporary water main shall be connected to the water supply with a double check backflow preventer.

Water service piping shall be connected to the existing houses at existing hose bibbs. If connection to hose bibb is not feasible (for example, in the presence of a built-in vacuum breaker), connection can be made at the existing curb stop at the approval of the Engineer. Contractor shall be completely responsible for all Work required to ensure that each water service has satisfactory water service from the temporary water main prior to removing the existing water main from service.

System Monitoring and Maintenance

Contractor shall monitor the temporary water main and services and shall ensure that the system is functioning as intended and shall remedy any defects in water delivery within 3 hours of being notified.

Contractor shall monitor system pressure and ensure that pressure is not lowered due to defects in temporary water main system.

Project Completion

At project completion, after the new water main has been installed, tested, accepted and connected to the water supply and after all water services have been connected/reconnected to the new main, the temporary water main and appurtenances will be removed and become the property of the Contractor. Permanent restoration of pavement, sidewalk, lawn areas, landscaping or other surface treatment resulting from the use of temporary water service (and not already called for restoration in the plans) shall be included as part of this pay item. Restoration of all surfaces and site features shall be to equal or better condition than existing.

e. Measurement and Payment.- The completed work will be paid for at the contract unit price for the following contract item (pay item):

<u>Contract Item (Pay Item)</u>	<u>Pay Unit</u>
Temporary Water Main, Wright Street	Lump Sum

“Temporary Water Main, Wright Street” will be paid for at the contract unit price for 1.0 Lump Sum, which shall be payment in full for all labor, equipment and material needed to accomplish this work.

c:\pw_work\mfanagon_d1253461\CPS-PLTS-Pavement Markings.dwg Dwg Created: 13-Apr-23 - _o2_standard bw.stb - Plot Date: 13-Apr-23

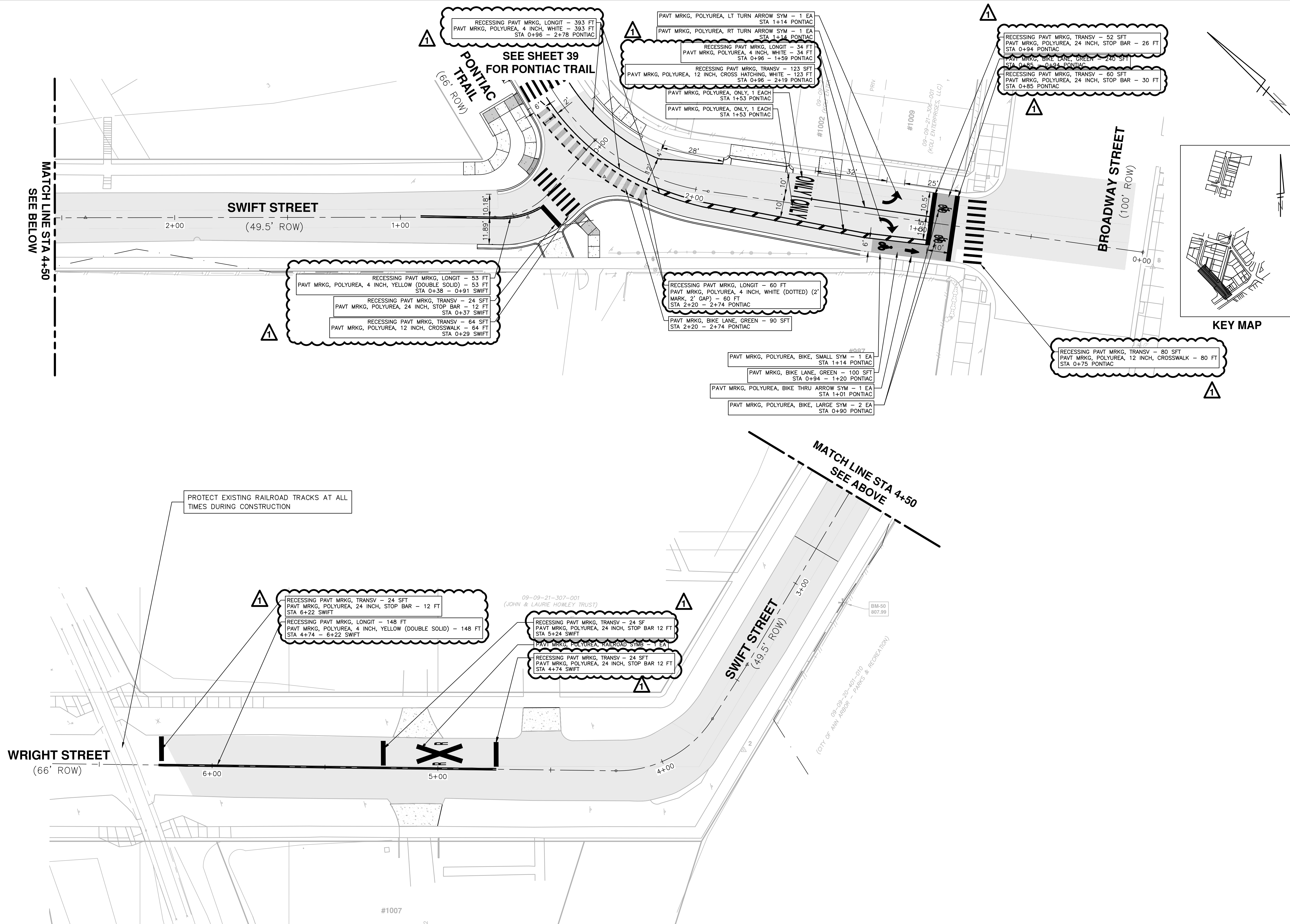

811
Know what's below.
Call before you dig.

REV.	DATE	DESCRIPTION	DRAWN	CHECKED
00	03/28/2023	ISSUED FOR BID	CGT/BLA	VCM/CEW
01	04/14/23	ADDENDUM 1	JS	CGT

CITY OF ANN ARBOR - PUBLIC SERVICES - ENGINEERING
PONTIAC, SWIFT, MOORE, & WRIGHT
INFRASTRUCTURE IMPROVEMENTS
PROPOSED PAVEMENT MARKING - SWIFT & WRIGHT

CITY OF ANN ARBOR
PUBLIC SERVICES
301 EAST HURON STREET
ANN ARBOR, MI 48106-0647
www.a2gov.org

SCALE PLAN: 1"=20'

DRAWING No. 2022-032-38

SHEET No.

38 OF 52

c:\p_w\work\mifanagon\1253461\CPS-PLTS-Pavement Markings.dwg Dwg Created: 13-Apr-23 _a2_standard bw.sib - Plot Date: 13-Apr-23

SEE SHEET 38 FOR SWIFT STREET

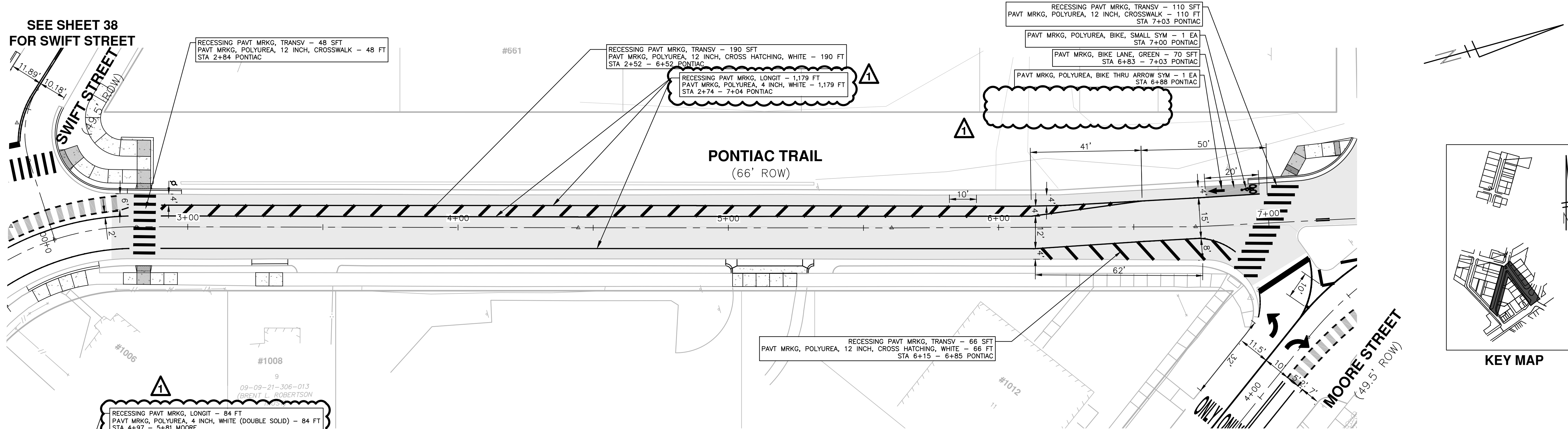

PONTIAC TRAIL (66' ROW)

SEE BELOW FOR MOORE STREET

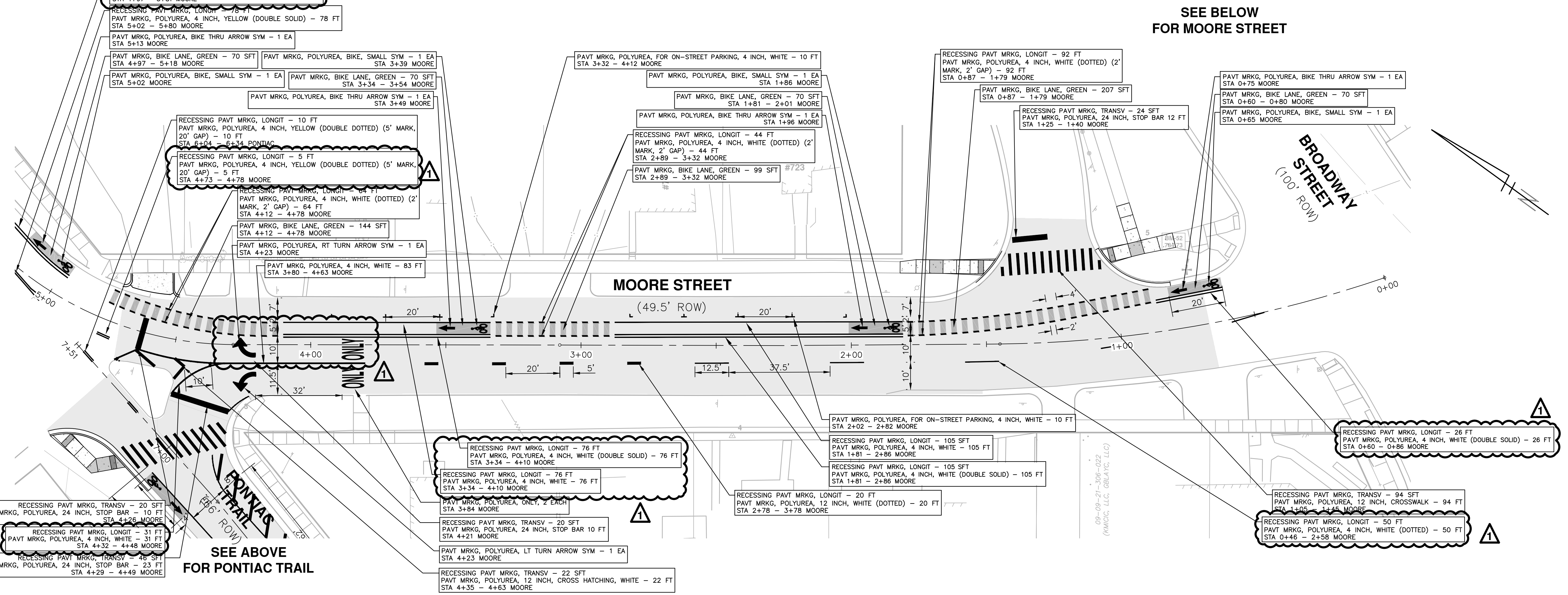

MOORE STREET (49.5' ROW)

SEE ABOVE FOR PONTIAC TRAIL

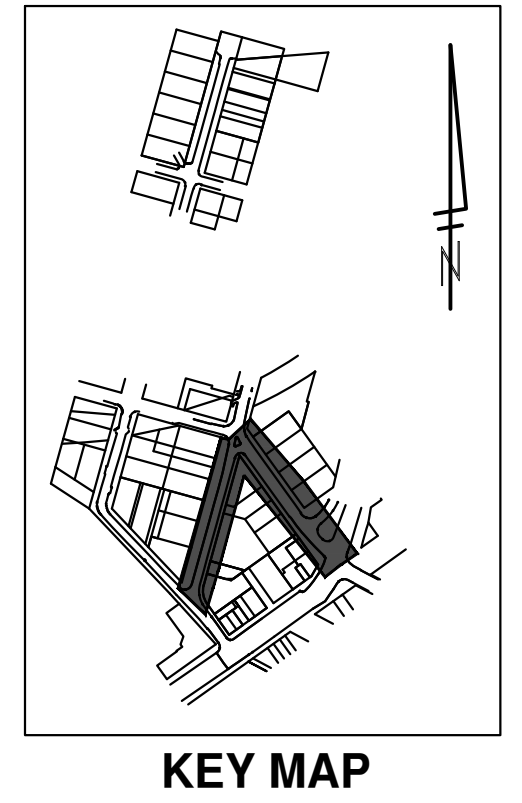

811 Know what's below. Call before you dig.

REV.	DATE	DESCRIPTION
00	03/28/2023	ISSUED FOR BID
01	04/14/23	ADDENDUM 1
		CCJ
		VCM/CEW
		CGT/BLA
		JS
		04/14/23

CITY OF ANN ARBOR - PUBLIC SERVICES - ENGINEERING
PONTIAC, SWIFT, MOORE, & WRIGHT
INFRASTRUCTURE IMPROVEMENTS
 PROPOSED PAVEMENT MARKING - PONTIAC & MOORE

CITY OF ANN ARBOR PUBLIC SERVICES
 301 EAST HURON STREET
 ANN ARBOR, MI 48106-0647
 734.794.6410
 www.aagov.org

SCALE PLAN: 1"=30'
 DRAWING No. 2022-032-39
 SHEET No. 39 OF 52

MATCH LINE STA 4+00
SEE SHEET 41

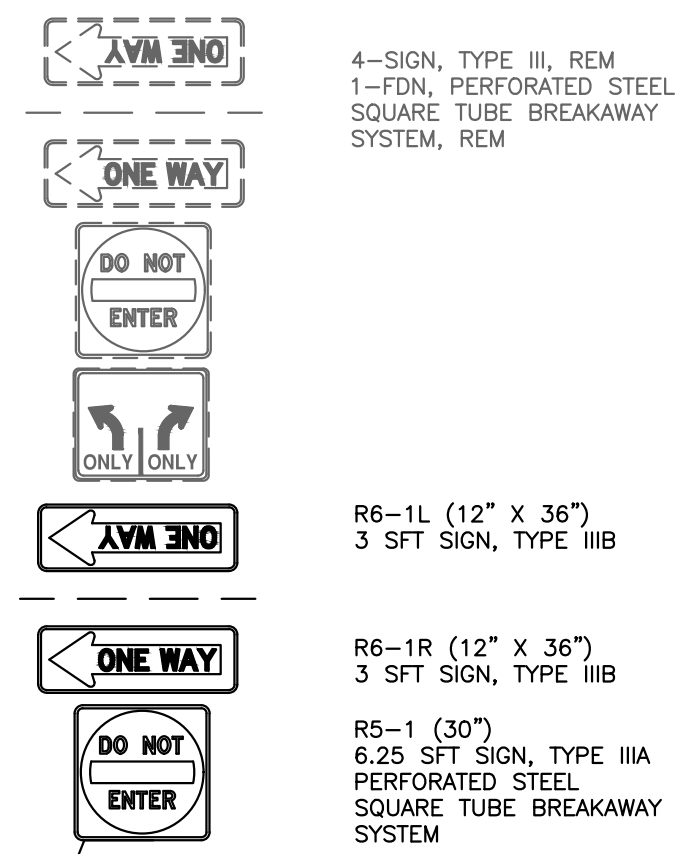
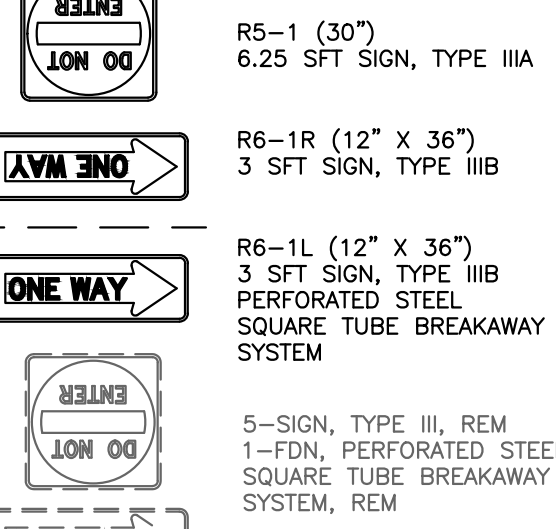
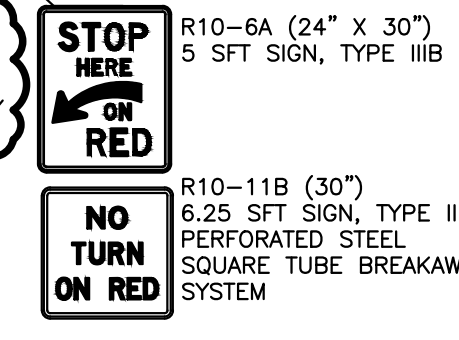
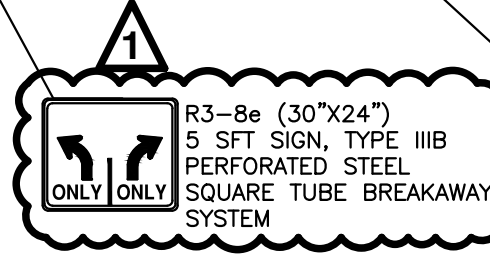
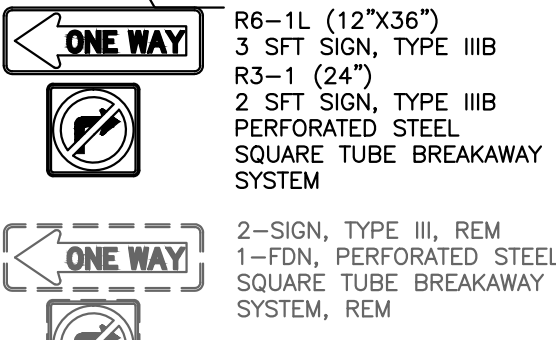
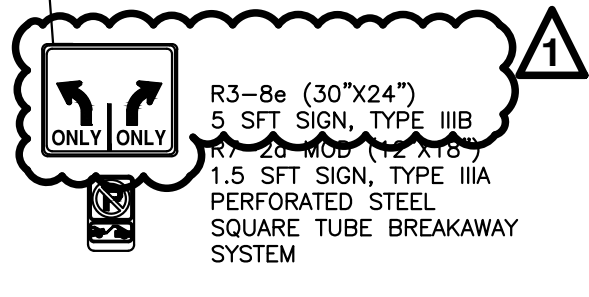
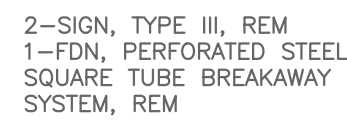
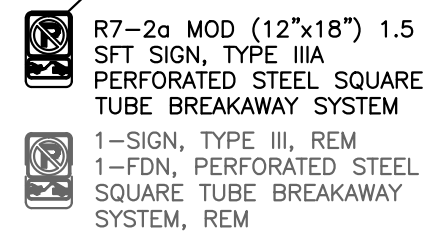
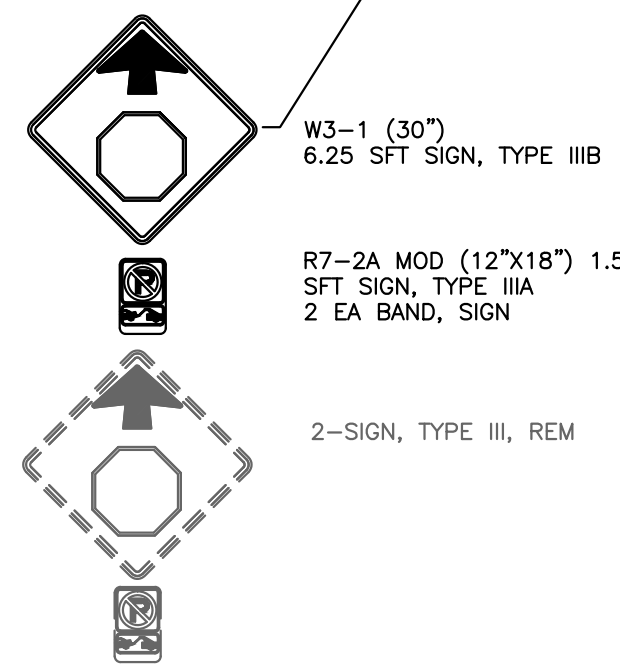
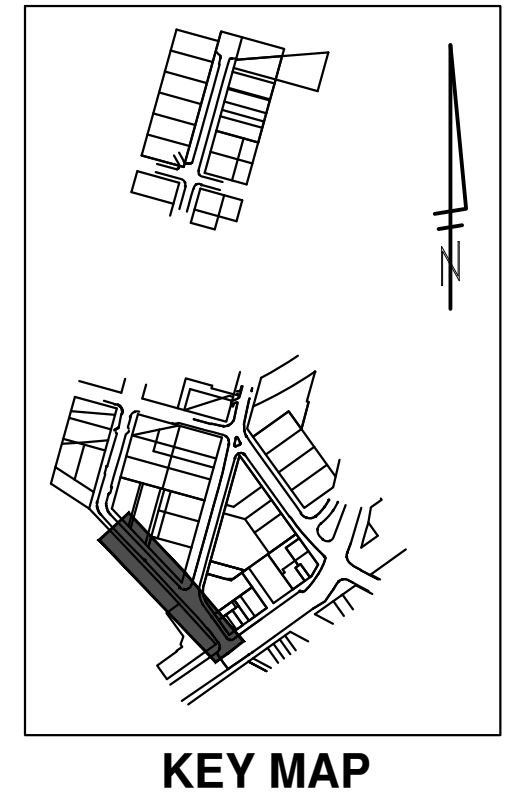
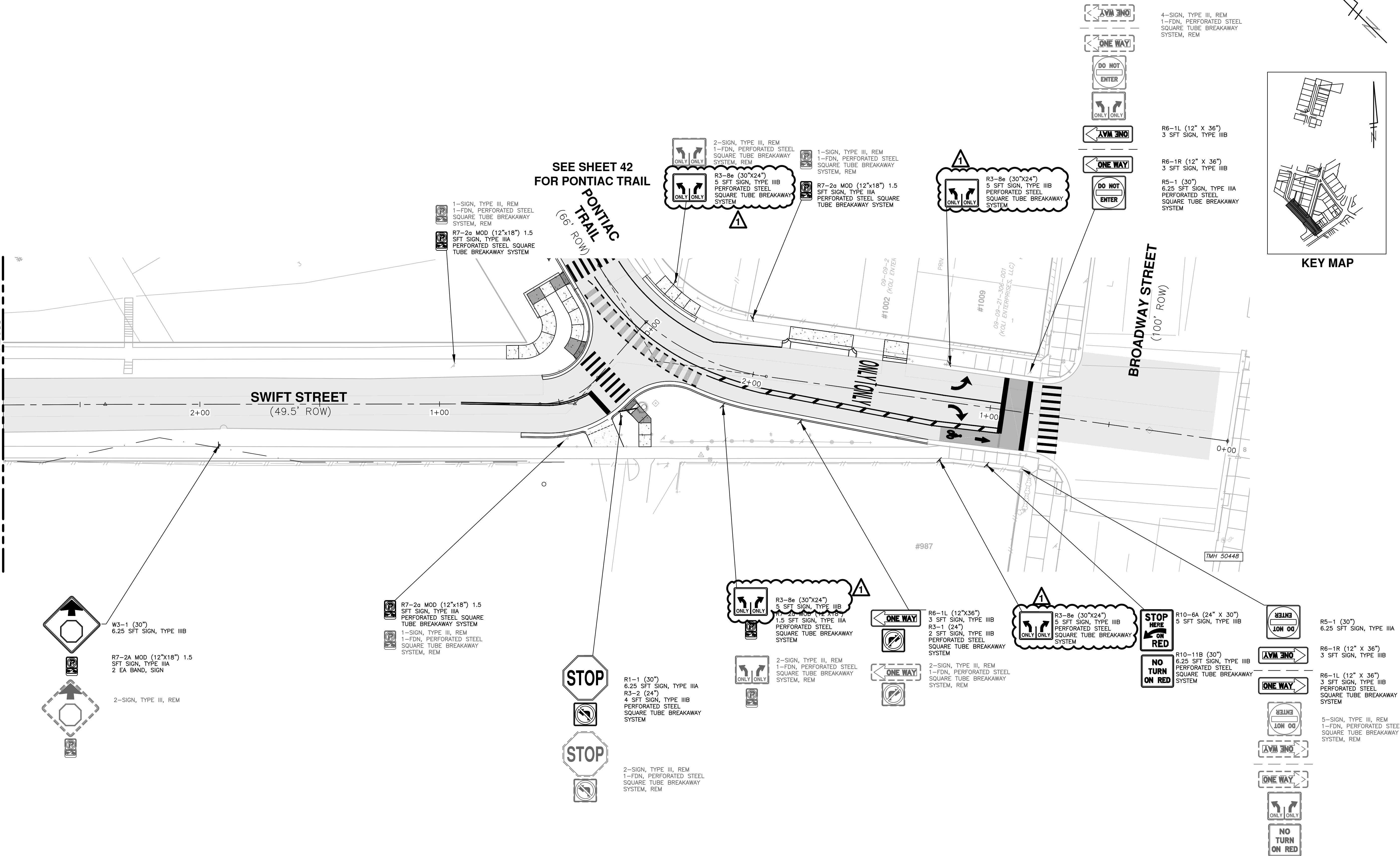

811
Know what's below.
Call Before you dig.

CGT	VCN/CEW	CHECKED
JS	CGT/BLA	DRAWN
04/14/23	03/28/2023	DATE
ADDENDUM 1	ISSUED FOR BID	REV.
00		
	DESCRIPTION	

CITY OF ANN ARBOR
PUBLIC SERVICES
301 EAST HURON STREET
ANN ARBOR, MI 48107-8647
www.a2gov.org

CITY OF ANN ARBOR - PUBLIC SERVICES - ENGINEERING
PONTIAC, SWIFT, MOORE, & WRIGHT
INFRASTRUCTURE IMPROVEMENTS
PROPOSED SIGNING - SWIFT

SCALE PLAN: 1"=20'
DRAWING No. 2022-032-40
SHEET No. 40 OF 52

c:\pw_work\mflanagan\dl253461\CPS-PLTS-Signage.dwg Dwg Created: 6-Apr-23 - _a2_standard bw.stb - Plot Date: 13-Apr-23

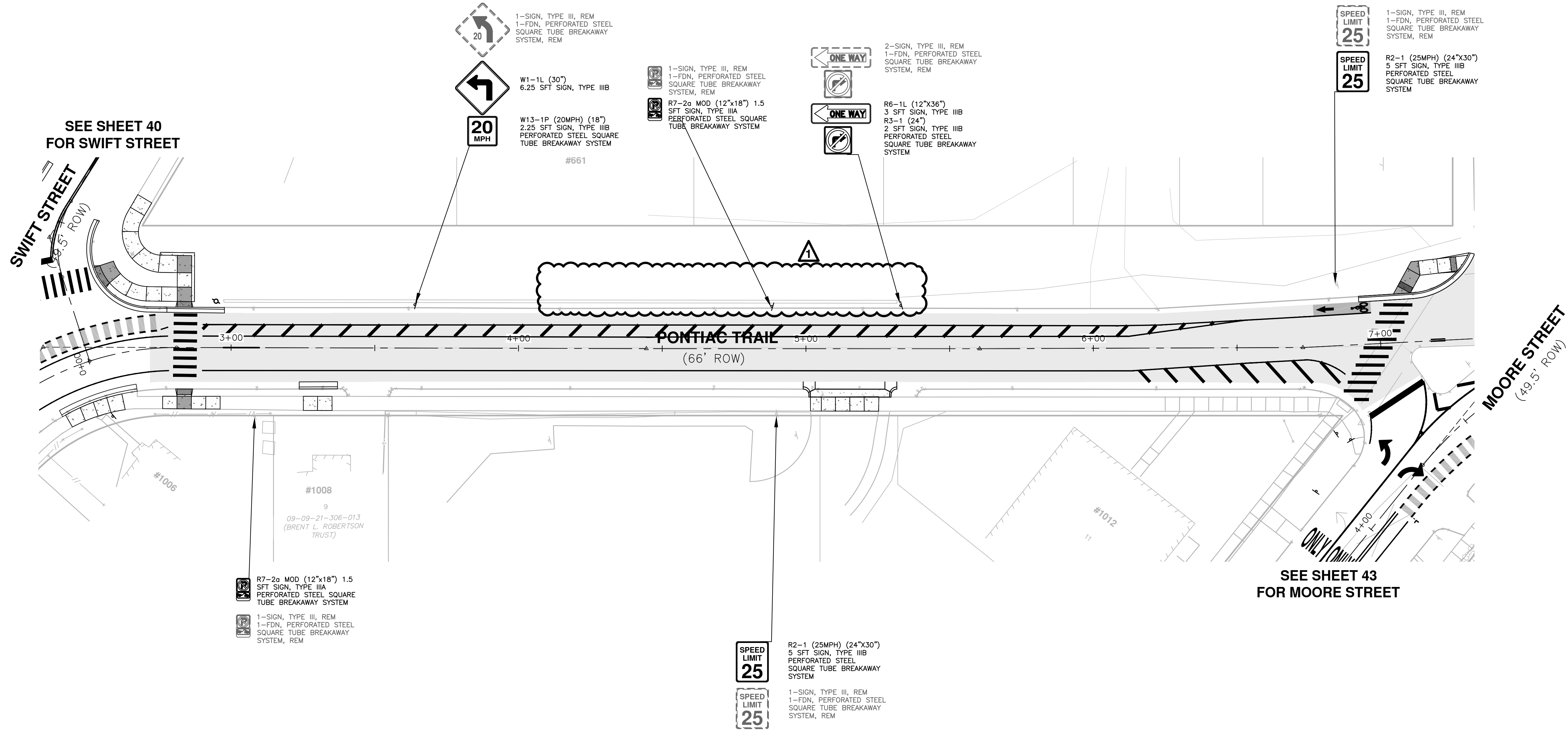

SEE SHEET 40
FOR SWIFT STREET

SEE SHEET 43
FOR MOORE STREET

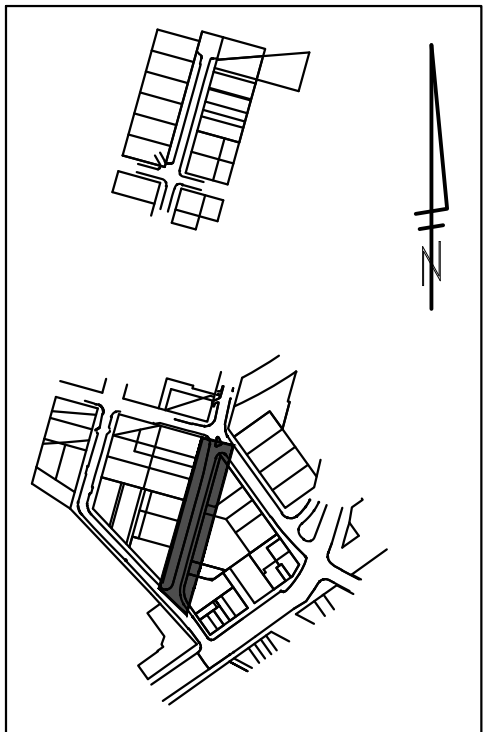

KEY MAP

- 1-SIGN, TYPE III, REM
1-FDN, PERFORATED STEEL
SQUARE TUBE BREAKAWAY
SYSTEM, REM
- W1-1L (30")
6.25 SFT SIGN, TYPE III B
- W13-1P (20MPH) (18")
2.25 SFT SIGN, TYPE III B
PERFORATED STEEL SQUARE
TUBE BREAKAWAY SYSTEM
- #661
- 1-SIGN, TYPE III, REM
1-FDN, PERFORATED STEEL
SQUARE TUBE BREAKAWAY
SYSTEM, REM
- R7-2a MOD (12"x18") 1.5
SFT SIGN, TYPE III A
PERFORATED STEEL SQUARE
TUBE BREAKAWAY SYSTEM
- 2-SIGN, TYPE III, REM
1-FDN, PERFORATED STEEL
SQUARE TUBE BREAKAWAY
SYSTEM, REM
- R6-1L (12"x36")
3 SFT SIGN, TYPE III B
R3-1 (24")
2 SFT SIGN, TYPE III B
PERFORATED STEEL
SQUARE TUBE BREAKAWAY
SYSTEM
- 1-SIGN, TYPE III, REM
1-FDN, PERFORATED STEEL
SQUARE TUBE BREAKAWAY
SYSTEM, REM
- R2-1 (25MPH) (24"x30")
5 SFT SIGN, TYPE III B
PERFORATED STEEL
SQUARE TUBE BREAKAWAY
SYSTEM
- 1-SIGN, TYPE III, REM
1-FDN, PERFORATED STEEL
SQUARE TUBE BREAKAWAY
SYSTEM, REM
- R7-2a MOD (12"x18") 1.5
SFT SIGN, TYPE III A
PERFORATED STEEL SQUARE
TUBE BREAKAWAY SYSTEM
- 1-SIGN, TYPE III, REM
1-FDN, PERFORATED STEEL
SQUARE TUBE BREAKAWAY
SYSTEM, REM
- 1-SIGN, TYPE III, REM
1-FDN, PERFORATED STEEL
SQUARE TUBE BREAKAWAY
SYSTEM, REM
- R2-1 (25MPH) (24"x30")
5 SFT SIGN, TYPE III B
PERFORATED STEEL
SQUARE TUBE BREAKAWAY
SYSTEM
- 1-SIGN, TYPE III, REM
1-FDN, PERFORATED STEEL
SQUARE TUBE BREAKAWAY
SYSTEM, REM

811
Know what's below.
Call Before you dig.

CGT	CGT	CGT
JS	CGT/BLA	CGT/BLA
04/14/23	03/28/2023	DATE
1	ISSUED FOR BID	DESCRIPTION
00	REV.	REV.

CITY OF ANN ARBOR - PUBLIC SERVICES - ENGINEERING

PONTIAC, SWIFT, MOORE, & WRIGHT

INFRASTRUCTURE IMPROVEMENTS

PROPOSED SIGNING - PONTIAC

CITY OF ANN ARBOR
PUBLIC SERVICES
301 EAST HURON STREET
ANN ARBOR, MI 48106-8647
www.aagov.org

SCALE PLAN: 1"=20'

DRAWING No. 2022-032-42

SHEET No. 42 OF 52

c:\p_w_work\mianagon\dl1253461\CPS-PLTS-Signage.dwg Dwg Created: 6-Apr-23 - _a2_standard bwstb - Plot Date: 13-Apr-23

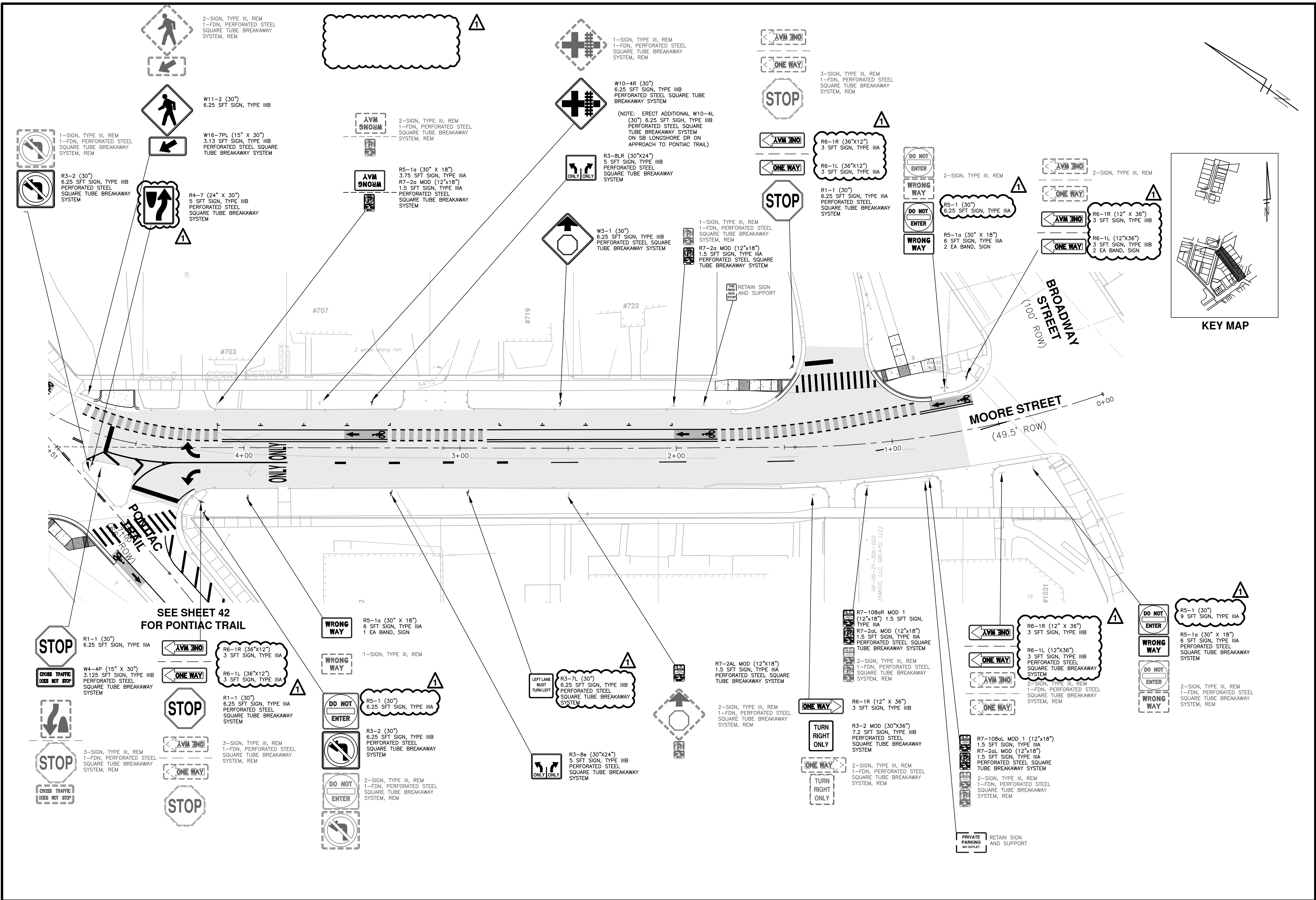

SEE SHEET 42 FOR PONTIAC TRAIL

811
Know what's below. Call before you dig.

REV.	DATE	DESCRIPTION	DRAWN	CHECKED
00	03/28/2023	ISSUED FOR BID		
01	04/14/23	ADDENDUM 1	JS	CGT

CITY OF ANN ARBOR
PUBLIC SERVICES
301 EAST HURON STREET
P.O. BOX 8647
ANN ARBOR MI 48107-8647
www.a2gov.org

CITY OF ANN ARBOR - PUBLIC SERVICES - ENGINEERING
PONTIAC, SWIFT, MOORE, & WRIGHT
INFRASTRUCTURE IMPROVEMENTS
PROPOSED SIGNING - MOORE

SCALE PLAN: 1"=20'
DRAWING No. 2022-032-43
SHEET No. 43 OF 52

E. Schedule of Pricing/Cost – 20 Points

Company: _____

Acknowledgement of Addendum No. 1 (initial): _____

Date: _____

Project: Pontiac, Swift, Moore and Wright Watermain and Resurfacing Project							City Project #: 2022-032	
RFP#: 23-22								
Item	Description	Unit	Estimated Quantity	Change in Qty	Add 1 Qty	Unit Price	Total Price	
200	General Conditions, Max \$200,000	LSum	1			\$	\$	
201	Certified Payroll Compliance and Reporting	LSum	1			\$	\$	
202	Audio-visual Recording	LSum	1			\$	\$	
203	Protective Fence, Orange, Plastic, 4 foot Ht	Ft	1,095			\$	\$	
204	Sewer, Any Size or Depth, Rem	Ft	55			\$	\$	
205	Dr Structure, Any Size or Depth, Rem	Ea	4			\$	\$	
206	Curb and Gutter, Any Type or Size, Rem	Ft	492			\$	\$	
207	Driveway Approach, Rem	Syd	118			\$	\$	
208	Sidewalk and Ramps, Rem	Sft	1,855			\$	\$	
209	Pavement, Remove	Syd	2,970			\$	\$	
210	Non-Hazardous Contrm'd Mat'l Handling & Disposal (LM)	Cyd	100			\$	\$	
211	Exploratory Excavation, (0-10 ft. deep) (Trench Det 1, Modified)	Ea	10			\$	\$	
212	Flowable Fill (Backfill)	Cyd	10			\$	\$	
213	Subgrade Undercutting, Type II	Cyd	100			\$	\$	
214	Subgrade Undercutting, Type IV	Cyd	100			\$	\$	
215	Machine Grading, Modified	Sta	22			\$	\$	
216	Erosion Control, Inlet Filter	Ea	7			\$	\$	
217	Subbase, CI II CIP	Cyd	65			\$	\$	
218-10	Aggregate Base, 10 inch	Syd	2,107			\$	\$	
218-6	Aggregate Base, 6 inch	Syd	1,430			\$	\$	
219	Maintenance Gravel	Ton	220			\$	\$	
220	RCP, Sewer, C76, CL-IV, 12 inch, Tr Det I	Ft	40			\$	\$	
221	SDR 35 PVC Service Lead	Ft	200			\$	\$	
222	SDR 35, PVC Tee	Ea	3			\$	\$	
223	SDR 35 PVC Riser	Vft	20			\$	\$	
224	Sanitary Manhole, Type I, 48 inch dia	Ea	1			\$	\$	
225	Additional Depth Structure Adjust/Repair	Ft	50			\$	\$	
226	Single Inlet	Ea	4			\$	\$	
227	Dr Structure, Manhole, Type I, 48 inch dia	Ea	1			\$	\$	
228	Manhole, Type I, 48 inch dia, Add Depth	Vft	5			\$	\$	
229	Infiltration Wet/Dry Well	Ea	1			\$	\$	
230	Adjust Structure Cover	Ea	26			\$	\$	
231	Adjust Monument Box or Valve Box	Ea	2			\$	\$	
232	Dr Structure Cover, Type K, Special	Ea	9			\$	\$	
233	Dr Structure Cover, Type Q, Special	Ea	23			\$	\$	
234	6 inch, Wrapped Underdrain	Ft	800			\$	\$	
235	Cold Milling HMA Surface	Syd	4,485			\$	\$	
236	Hand Patching	Ton	20			\$	\$	
237	HMA, 3C (Base)	Ton	94			\$	\$	
238	HMA, 4EML (Leveling)	Ton	690			\$	\$	
239	HMA, 5EML (Top)	Ton	754			\$	\$	

E. Schedule of Pricing/Cost

Project: Pontiac, Swift, Moore and Wright
Watermain and Resurfacing Project

<u>Item</u>	<u>Description</u>	<u>Unit</u>	<u>Estimated Quantity</u>	<u>Change in Qty</u>	<u>Add 1 Qty</u>	<u>Unit Price</u>	<u>Total Price</u>
240	HMA, Temp Pavt (2EML)	Ton	100			\$	\$
241	Curb and Gutter, Conc, AA Det SD-R-1	Ft	360			\$	\$
242	Driveway Opening, Conc, Det M, P-NC	Ft	171			\$	\$
243	Drive Approach, Conc, 6 inch, Nonreinf, P-NC	Syd	92			\$	\$
244	Sidewalk, Concrete, 4 inch	Sft	1,645			\$	\$
245	Sidewalk, Concrete, 6 inch, P-NC	Sft	275			\$	\$
246	Sidewalk Ramp, Concrete, 6 inch	Sft	575			\$	\$
247	Detectable Warning Surface, Modified	Ft	60			\$	\$
248	Cobble Gutter, Rem & Salvage	Sft	80			\$	\$
249	Cobble Gutter, Install	Sft	80			\$	\$
250	Cobble Gutter, Cleaning	Syd	250			\$	\$
251	Integral Sidewalk Retaining Wall, 18 to 36 inch	Sft	80			\$	\$
252	Band, Sign	Ea	9			\$	\$
253	Fdn, Perforated Steel Square Tube Breakaway System, Rem	Ea	45			\$	\$
256	Sign, Type III, Rem	Ea	88			\$	\$
258	Sign, Type IIIA	Sft	128			\$	\$
259	Sign, Type IIIB	Sft	216			\$	\$
261	Perforated Steel Square Tube Breakaway System, Modified	Ea	55	1	56	\$	\$
262	Recessing Pavt Mrkg, Longit	Ft	3,143			\$	\$
263	Recessing Pavt Mrkg, Transv	Sft	841	-40	801	\$	\$
264	Pavt Mrkg, Polyurea, 4 inch, White	Ft	2,525			\$	\$
265	Pavt Mrkg, Polyurea, 4 inch, Yellow	Ft	598			\$	\$
268	Pavt Mrkg, Polyurea, 12 inch, White	Ft	20			\$	\$
269	Pavt Mrkg, Polyurea, 12 inch, Crosswalk	Ft	513			\$	\$
271	Pavt Mrkg, Polyurea, 24 inch, Stop Bar	Ft	164	20	184	\$	\$
273	Pavt Mrkg, Polyurea, Rt Turn Arrow Sym	Ea	1	1	2	\$	\$
274	Pavt Mrkg, Polyurea, Lt Turn Arrow Sym	Ea	2			\$	\$
275	Pavt Mrkg, Polyurea, Only	Ea	3	1	4	\$	\$
277	Pavt Mrkg, Polyurea, 12 inch, Cross Hatching, White	Ft	315			\$	\$
278	Pvt Mrkg, Polyurea, Railroad Symb	Ea	2	-1	1	\$	\$
279	Pavt Mrkg, Bike Lane, Green	Sft	1,230			\$	\$
280	Pavt Mrkg, Polyurea, Bike, Thru Arrow Sym	Ea	6			\$	\$
281	Pavt Mrkg, Polyurea, Bike, Small Sym	Ea	2			\$	\$
282	Pavt Mrkg, Polyurea, Bike, Large Sym	Ea	6			\$	\$
283	Barricade, Type III, High Intensity, Double Sided, Lighted, Furn	Ea	35			\$	\$
284	Barricade, Type III, High Intensity, Double Sided, Lighted, Oper	Ea	35			\$	\$
287	Lighted Arrow, Type C, Furn	Ea	1			\$	\$
288	Lighted Arrow, Type C, Oper	Ea	1			\$	\$
289	Plastic Drum, Fluorescent, Furn	Ea	50			\$	\$
290	Plastic Drum, Fluorescent, Oper	Ea	50			\$	\$
291	Sign Cover	Ea	4			\$	\$
292	Sign, Portable, Changeable Message, NTCIP-Compliant, Furn	Ea	2			\$	\$
293	Sign, Portable, Changeable Message, NTCIP-Compliant, Oper	Ea	2			\$	\$

E. Schedule of Pricing/Cost

Project: Pontiac, Swift, Moore and Wright
Watermain and Resurfacing Project

<u>Item</u>	<u>Description</u>	<u>Unit</u>	<u>Estimated Quantity</u>	<u>Change in Qty</u>	<u>Add 1 Qty</u>	<u>Unit Price</u>	<u>Total Price</u>
294	Sign, Type B, Temp, Prismatic, Furn	Sft	882			\$	\$
295	Sign, Type B, Temp, Prismatic, Oper	Sft	882			\$	\$
296	Sign, Type B, Temp, Prismatic, Spec, Furn	Sft	482			\$	\$
297	Sign, Type B, Temp, Prismatic, Spec, Oper	Sft	482			\$	\$
298	Traffic Regulator Control, Max \$10,000	LSum	1			\$	\$
299	Minor Traffic Devices, Max \$20,000	LSum	1			\$	\$
900	Pedestrian Type II Barricade, Temp	Ea	10			\$	\$
901	Pedestrian Type II Chanellizer, Temp	Ft	250			\$	\$
903	Pedestrian Ramp, Temp	Ea	4			\$	\$
904	No Parking Sign	Ea	25			\$	\$
906	Temporary Audible Message Device	Ea	8			\$	\$
909	Site Clean-up, Max \$20,000	LSum	1			\$	\$
910	Turf Establishment	Syd	1,500			\$	\$
911	Mulch Blanket	Syd	1,500			\$	\$
912	Project Supervision, Max \$40,000	LSum	1			\$	\$
913	Irrigation Systems, Protection and Maintenance	LSum	1			\$	\$
914-12	Line Stop, Ductile/Cast Iron Pipe, 12 inch	Ea	2			\$	\$
914-6	Line Stop, Ductile/Cast Iron Pipe, 6 inch	Ea	2			\$	\$
914-8	Line Stop, Ductile/Case Iron Pipe, 8 inch	Ea	2			\$	\$
916	Line Stop, Additional Rental Day	Ea	5			\$	\$
917	CL 52, D.I. Water Main, w/Poly Wrap, 12 inch, Tr Det I, Mod	Ft	1,350			\$	\$
918	CL 52, D.I. Water Main, w/Poly Wrap, 8 inch, Tr Det I, Mod	Ft	215			\$	\$
919	CL 52, D.I. Water Main, w/Poly Wrap, 6 inch, Tr Det I, Mod	Ft	20			\$	\$
920	90 deg bend, 8 inch	Ea	1			\$	\$
921	45 deg Bend, 12 inch	Ea	12			\$	\$
922	45 deg Bend, 8 inch	Ea	2			\$	\$
923	45 deg Bend, 6 inch	Ea	4			\$	\$
924	11.25 deg Bend, 8 inch	Ea	1			\$	\$
925	Reducer, 8 inch x 6 inch	Ea	5			\$	\$
926	Reducer, 10 inch x 8 inch	Ea	2			\$	\$
927	Reducer, 12 inch x 6 inch	Ea	2			\$	\$
928	Tee, 6 inch x 6 inch x 6 inch	Ea	1			\$	\$
929	Tee, 8 inch x 8 inch x 8 inch	Ea	3			\$	\$
931	Tee, 12 inch x 12 inch x 6 inch	Ea	1			\$	\$
932	Tee, 12 inch x 12 inch x 8 inch	Ea	3			\$	\$
933	Tee, 12 inch x 12 inch x 12 inch	Ea	2			\$	\$
934	Fire Hydrant Assy, w/Extensions, Complete	Ea	5			\$	\$
935	Gate Valve-in-Well, 12 inch	Ea	4			\$	\$
936	Gate Valve-in-Well, 8 inch	Ea	2			\$	\$
938	Sacrificial Anode, 17 LB	Ea	3			\$	\$
939	Sacrificial Anode, 32 LB	Ea	14			\$	\$
940	Water Main, HDPE, 10-inch, Directional Drill	Ft	350			\$	\$
941	Temporary Water Service	LSum	1			\$	\$

E. Schedule of Pricing/Cost

Project: Pontiac, Swift, Moore and Wright
 Watermain and Resurfacing Project

<u>Item</u>	<u>Description</u>	<u>Unit</u>	<u>Estimated Quantity</u>	<u>Change in Qty</u>	<u>Add 1 Qty</u>	<u>Unit Price</u>	<u>Total Price</u>
942	Water Main Pipe Abandonment	Ft	1,200			\$	\$
943	Gate Valve-in-Box, Abandon	Ea	3			\$	\$
945	Fire Hydrant, Rem	Ea	1			\$	\$
946	Excavate & Backfill for Water Service Tap and Lead	Ft	60			\$	\$
947	Water Service Connection to 10 inch HDPE Water Main	Ea	7			\$	\$
950	Guardrail, Rem, Salv and Reconstruct	LF	50			\$	\$
						Total	\$
Alternate Bid Item 940							
940-A	CL 52, D.I. Water Main, 8 inch, Directional Drill	Ft	350			\$	\$